







LEGEND

-  TEMPORARY PAVEMENT
-  EROSION CONTROL BLANKET AND TEMPORARY EROSION CONTROL SEEDING
-  MULCH, METHOD 2 AND TEMPORARY EROSION CONTROL SEEDING
-  INLET FILTER AND PERIMETER EROSION BARRIER PLACED AROUND OPEN GRATE STRUCTURE IN ACCORDANCE WITH 280001-05
-  INLET FILTERS
-  TEMPORARY DITCH CHECKS

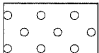

IMPROVEMENT BEGINS
STA. 208+78.12

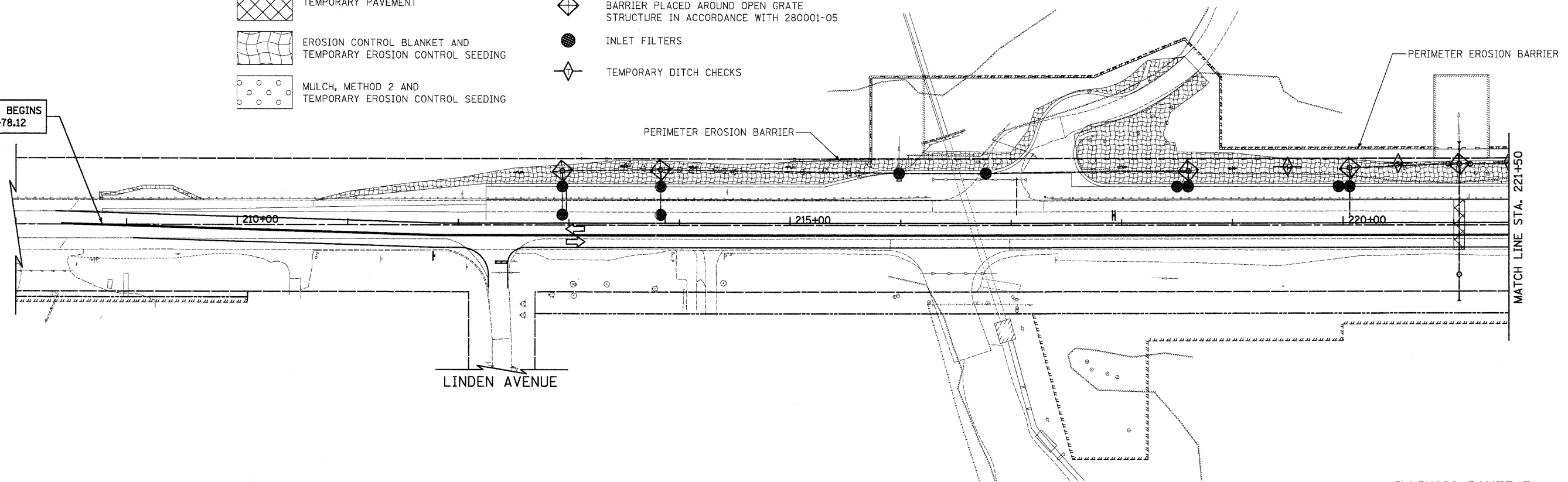

ILLINOIS ROUTE 31

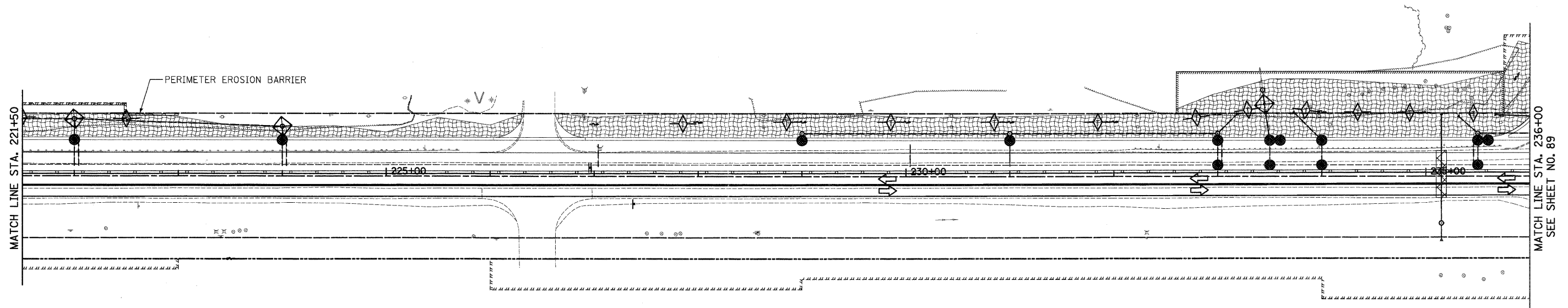

- NOTES:
- ALL TEMPORARY DITCH CHECKS ARE 1 FOOT IN HEIGHT UNLESS OTHERWISE NOTED.



ILLINOIS ROUTE 31

FILE NAME = Y:\2278 Virginia Klassen\oad\sheet\10-ErosionControl\2278.ERO.01.dgn	USER NAME = dte	DESIGNED - DTE	REVISED -	STATE OF ILLINOIS DEPARTMENT OF TRANSPORTATION	EROSION AND SEDIMENT CONTROL - STAGE 1A AND 1B	F.A.J. RTE. 3887	SECTION 96-00209-01-PV	COUNTY MCHENRY	TOTAL SHEETS 271	SHEET NO. 88		
PLOT SCALE = 50.0000' / 1" = 50'	CHECKED - GAB	DATE - 10/24/11	REVISED -			SCALE: 1" = 50'	SHEET NO. 1 OF 9 SHEETS	STA. 208+78.12	TO STA. 236+00	CONTRACT NO. 63553		
PLOT DATE = 10/24/2011	DATE - 10/24/11	REVISED -	REVISED -			FED. ROAD DIST. NO. 1 ILLINOIS FED. AID PROJECT HPP-4064(003)						