

DATE	
BY	
SURVEYED	
PLOTTED	
NOTE BOOK	
AREAS CHECKED	
NO.	

DATE	
BY	
ORIGINAL SURVEY	
NOTE BOOK	
AREAS CHECKED	
NO.	

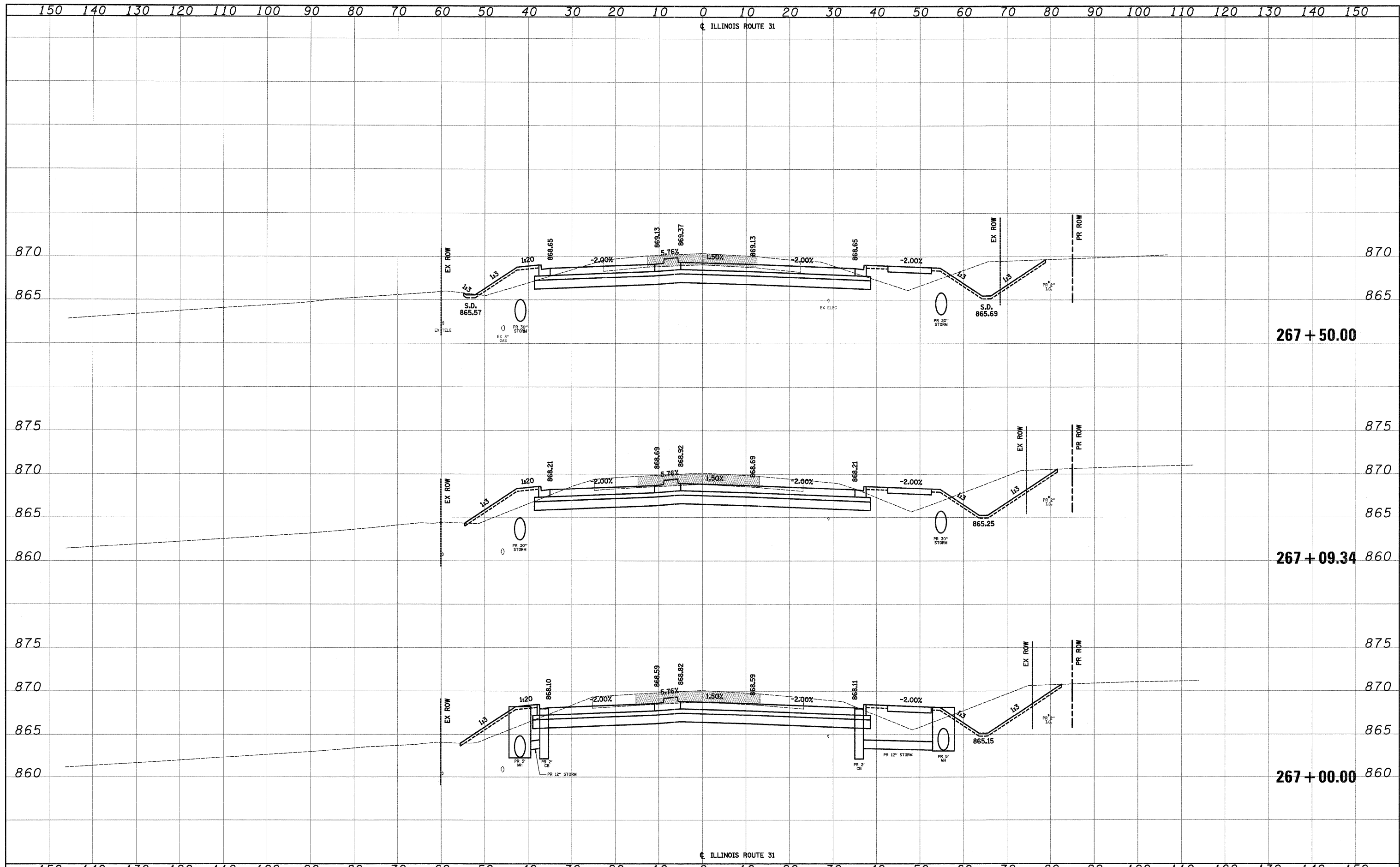

FILE NAME =	USER NAME = dsa	DESIGNED - KWH	REVISED -	STATE OF ILLINOIS DEPARTMENT OF TRANSPORTATION	CROSS SECTIONS	F.A.U. RTE. 3887	SECTION 96-00209-01-PV	COUNTY McHENRY	TOTAL SHEETS 271	SHEET NO. 241	
Y:\2278 Virginia Klassen\cad\ref\2278-shr-xsh.t	dgn	DRAWN - KWH	REVISED -			SCALE: 10'H: 5'V	SHEET NO. 48 OF 78 SHEETS	STA. 267+00.00 TO STA. 267+50.00	CONTRACT NO. 63553		
		CHECKED - GAB	REVISED -			FED. ROAD DIST. NO. 1 ILLINOIS FED. AID PROJECT HPP-406(003)					
		DATE - 10/24/11	REVISED -								