

TEMPORARY EROSION CONTROL NOTES

1. THE ENGINEER SHALL CONDUCT A FIELD REVIEW FOR EROSION AND SEDIMENT CONTROL WITH THE PRIME AND SUBCONTRACTORS PRIOR TO ANY EARTHWORK OPERATIONS TO DETERMINE TIMING OF CONTROL MEASURES.
2. THE CONTRACTOR WILL BE REQUIRED TO IMPLEMENT AND MAINTAIN EROSION CONTROL MEASURES IMMEDIATELY AFTER STRIPPING OF EXISTING VEGETATION.
3. NO CONCENTRATED RUNOFF FLOW FROM STRIPPED AREAS SHALL LEAVE THE SITE WITHOUT BEING TREATED. THE CONTRACTOR SHALL ADJUST HIS OPERATIONS AND IMPLEMENT EROSION CONTROL MEASURES ACCORDINGLY.
4. INLET FILTERS SHALL BE PROVIDED ON ALL EXISTING AND PROPOSED INLETS AND CATCH BASINS WITHIN THE PROJECT LIMITS. SEDIMENT CONTROL, DRAINAGE STRUCTURE INLET FILTER CLEANING WILL BE REQUIRED DURING THE CONSTRUCTION PERIOD AS NEEDED. AN ESTIMATED QUANTITY OF 2 ADDITIONAL CLEANINGS HAS BEEN INCLUDED IN THE QUANTITIES.
5. EROSION CONTROL MEASURES SHALL BE INSPECTED BY THE CONTRACTOR AND ENGINEER AT LEAST ONCE EVERY SEVEN DAYS WITHIN 24 HOURS OF ANY STORM EXCEEDING 1/2" OF PRECIPITATION OR EQUIVALENT SNOWFALL.
6. THE CONTRACTOR SHALL TAKE ALL PRECAUTIONS TO PREVENT POLLUTION OF STORM WATER AND SHALL FOLLOW IEPA & IDOT CONSTRUCTION MEMORANDUM NO. 06-60.
7. STABILIZATION MEASURES SHALL BE INITIATED AS SOON AS PRACTICAL, BUT NO MORE THAN 14 DAYS AFTER CONSTRUCTION ACTIVITY HAS CEASED IN AN AREA WHERE CONSTRUCTION ACTIVITY WILL NOT OCCUR FOR A PERIOD OF 21 OR MORE CALENDAR DAYS.
8. THE CONTRACTOR SHALL APPLY TEMPORARY EROSION CONTROL SEEDING TO ALL ERODIBLE BARE EARTH AREAS WITHIN THE CONTRACT LIMITS EACH WEEK, REGARDLESS OF WEATHER CONDITIONS OR PROGRESS OF THE WORK, UNLESS OTHERWISE DIRECTED BY THE ENGINEER. ERODIBLE EMBANKMENT AND EXCAVATION AREAS WHERE WORK IS IN PROGRESS SHALL BE INCLUDED ON THE AREAS TO BE SEEDDED.

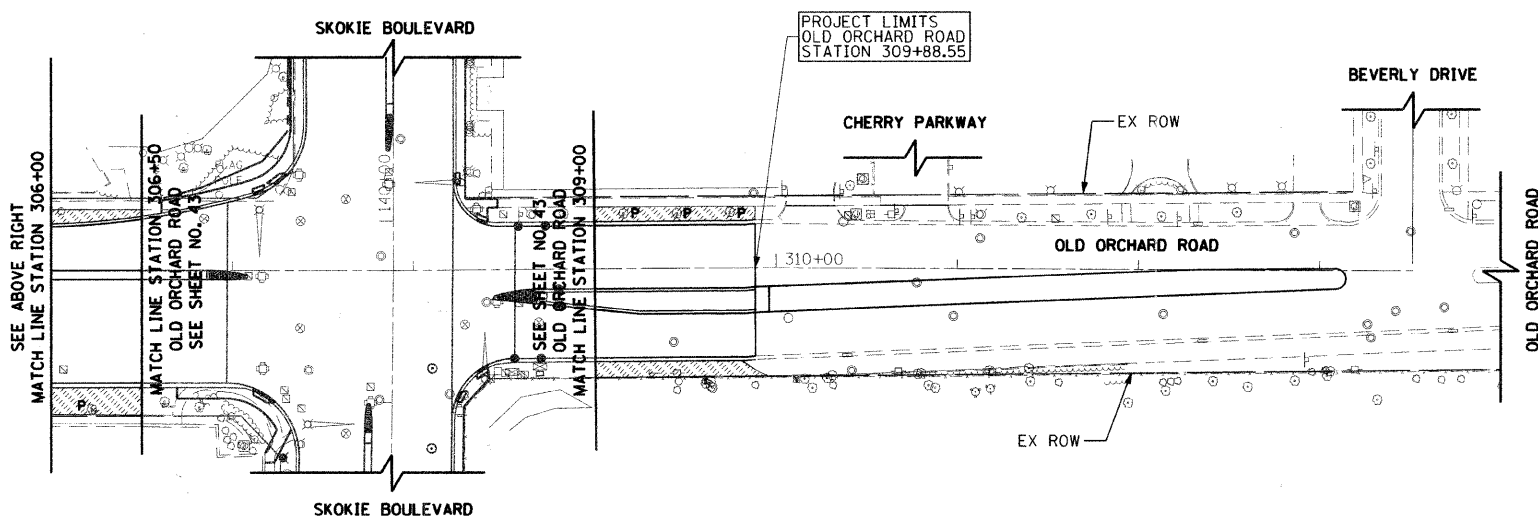

- LEGEND**
- SODDING, SALT TOLERANT TOPSOIL FURNISH AND PLACE, 4" NITROGEN, PHOSPHORUS, AND POTASSIUM FERTILIZER NUTRIENT
 - TEMPORARY FENCE, PRUNING, AND ROOT PRUNING
 - TREE REMOVAL

TREE REMOVAL			
STATION	OFFSET (FT)	UNIT	
OLD ORCHARD ROAD			
298+60	15	RT	3
302+12	56	RT	14
302+43	57	RT	9
303+22	67	RT	4

PROPOSED TREES				
IDOT CODE	SCIENTIFIC NAME	COMMON NAME	STATION	OFFSET (FT)
OLD ORCHARD ROAD				
A2005016	GYMNOCLADUS DIOICUS	KENTUCKY COFFEETREE	298+60	15
A2005016	GYMNOCLADUS DIOICUS	KENTUCKY COFFEETREE	298+99	13
A2005016	GYMNOCLADUS DIOICUS	KENTUCKY COFFEETREE	299+39	11
A2008518	ULMUS MORTON GLOSSY	TRIUMPH ELM	301+85	20
A2008518	ULMUS MORTON GLOSSY	TRIUMPH ELM	302+20	19
B2005716	PYRUS CALLERYANA 'CHANTICLEER'	CHANTICLEER PEARS	303+50	73
B2005716	PYRUS CALLERYANA 'CHANTICLEER'	CHANTICLEER PEARS	303+80	74