

QUANTITY
 4 (100) LINE = 64.1 ft. (19.7 m)
 21.1 sq. ft. (1.97 sq. m)

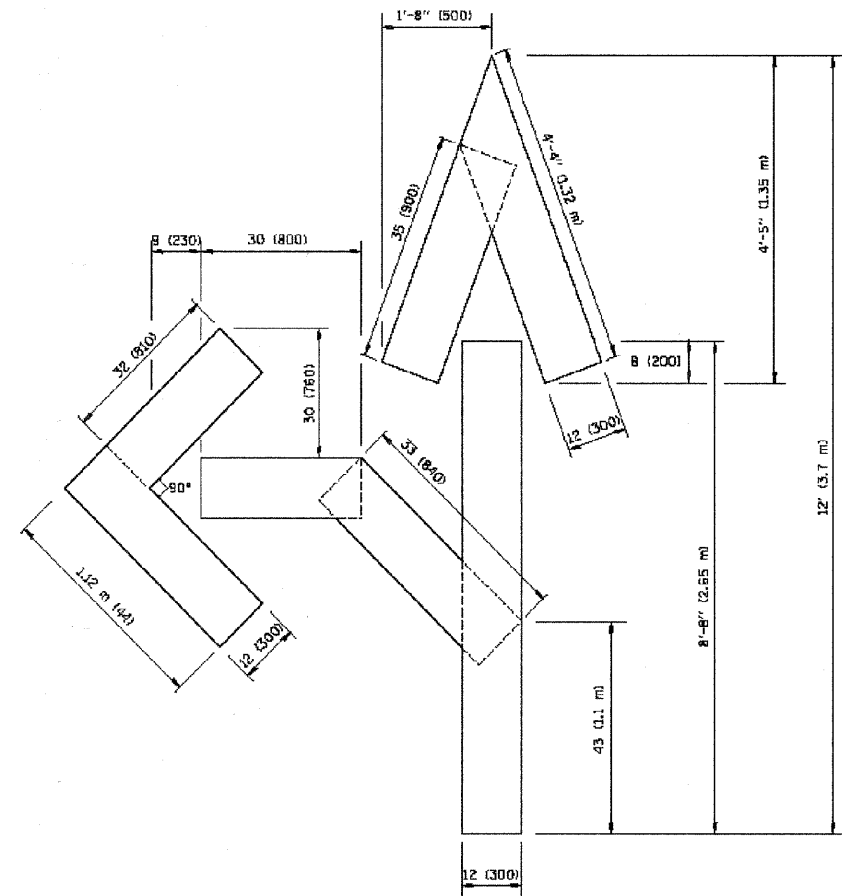

QUANTITY
 4 (100) LINE = 82.5 ft. (25.3 m)
 27.5 sq. ft. (2.53 sq. m)

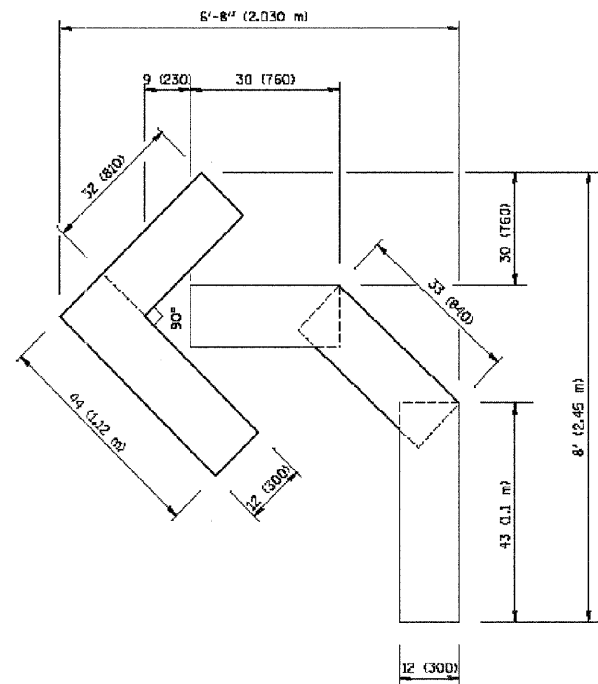

QUANTITY
 4 (100) LINE = 45.5 ft. (13.9 m)
 15.2 sq. ft. (1.39 sq. m)

All dimensions are in inches (millimeters) unless otherwise shown.

FILE NAME = g:\088\0885\Road\Sheets\045-51-109-15-16.SHT	USER NAME = dwbloock	DESIGNED	REVISED -T. RAMMACHER 06-05-96
		DRAWN	REVISED -T. RAMMACHER 11-04-97
	PLOT SCALE = 20.000 1/ IN.	CHECKED	REVISED -T. RAMMACHER 03-02-98
	PLOT DATE = 6/4/2011	DATE 09-18-94011	REVISED -E. GOMEZ 08-28-00

**STATE OF ILLINOIS
 DEPARTMENT OF TRANSPORTATION**

**DISTRICT ONE - PAVEMENT MARKING LETTERS AND SYMBOLS
 FOR TRAFFIC STAGING TC-16**

SCALE: N.T.S. SHEET NO. 11 OF 13 SHEETS STA. TO STA.

F.A.P. RTE.	SECTION	COUNTY	TOTAL SHEETS	SHEET NO.
350	00-00243-00-CH	COOK	142	117
FED. ROAD DIST. NO. 7 ILLINOIS FED. AID PROJECT			CONTRACT NO. 63566	