

**TEMPORARY CONTROLLER SEQUENCE**

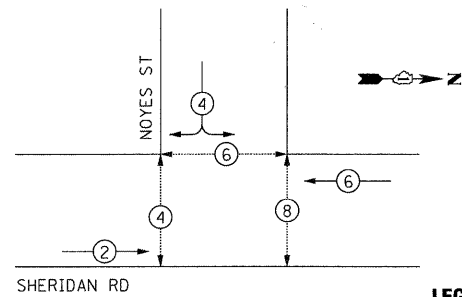

**LEGEND:**

- ← ⊙ ← DUAL ENTRY PHASE
- ← ⊠ ← SINGLE ENTRY PHASE
- ← ⊙ → PEDESTRIAN PHASE
- \* NUMBER REFERS TO ASSOCIATED PHASE

**TEMPORARY PHASE DESIGNATION DIAGRAM**

| I.D.O.T.<br>TRAFFIC SIGNAL INSTALLATION<br>ELECTRICAL SERVICE REQUIREMENTS |                      |         |                 |        | TOTAL<br>WATTAGE |
|--|----------------------|---------|-----------------|--------|------------------|
| TYPE   | NO. OF LAMPS×INCAND. | WATTAGE | LED×% OPERATION |        |                  |
| SIGNAL (RED)   | 9                    | 17      | 0.50            | 76.50  |                  |
| (YELLOW)   | 9                    | 25      | 0.25            | 56.25  |                  |
| (GREEN)  | 9                    | 15      | 0.25            | 33.75  |                  |
| ARROW  | -                    | 12      | 0.10            | -      |                  |
| PED. SIGNAL  | 6                    | 25      | 1.00            | 150.00 |                  |
| CONTROLLER   | 1                    | 100     | 1.00            | 100.00 |                  |
| ILLUM. SIGN  | -                    | 25      | 0.05            | -      |                  |
| VIDEO SYSTEM   | -                    | 150     | 1.00            | -      |                  |
| FLASHER  |                      |         | 0.50            |        |                  |

ENERGY COSTS TO: TOTAL = 416.50

ILLINOIS DEPARTMENT OF TRANSPORTATION  
 DIVISION OF HIGHWAY/DISTRICT 1  
 201 WEST CENTER COURT/SCHAUMBURG, ILLINOIS 60196-1096  
 ENERGY SUPPLY: CONTACT: LARRY SHANK  
 PHONE: (847) 816-5465  
 COMPANY: COMED

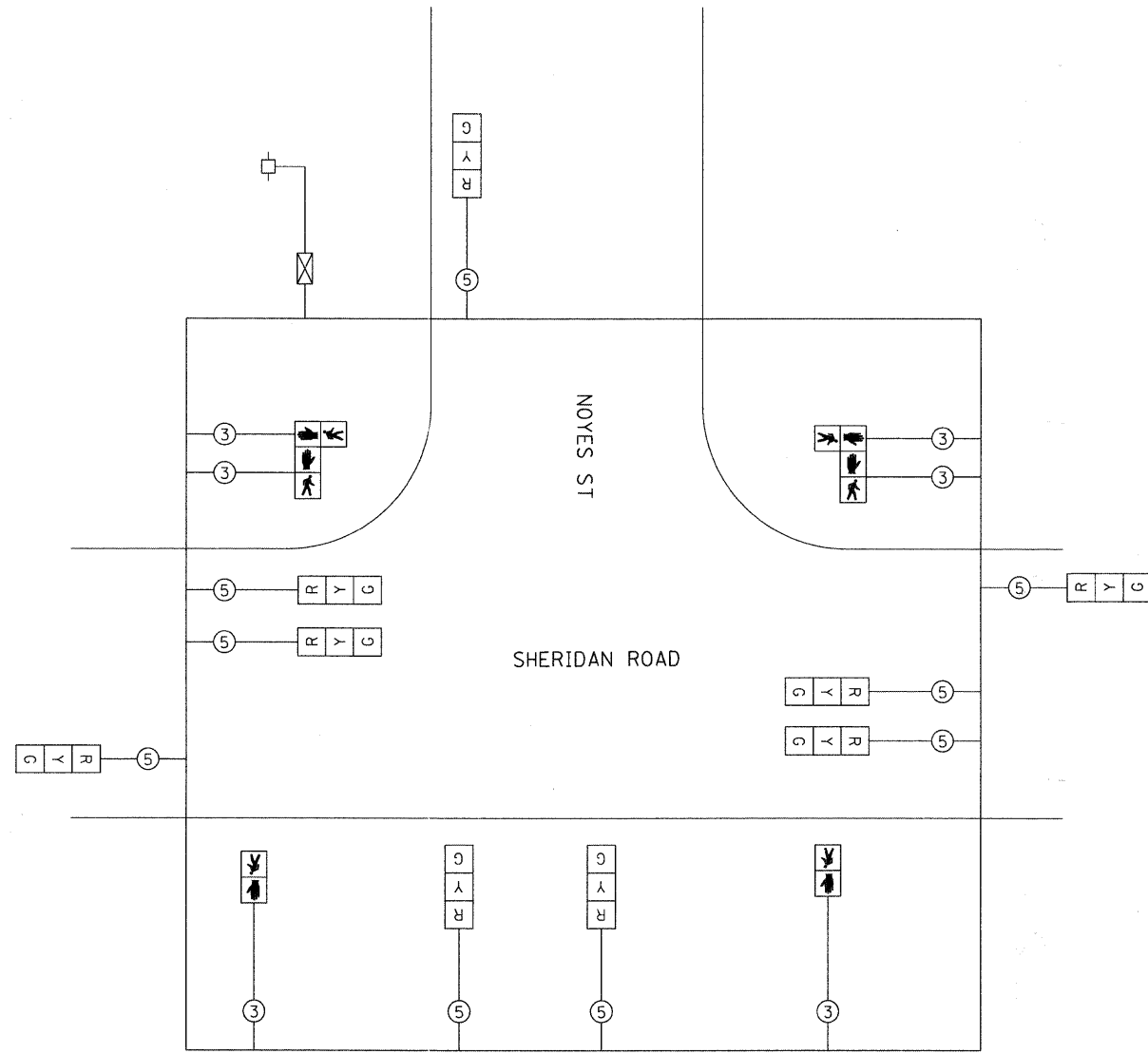

**TEMPORARY CABLE PLAN**

**RESTORATION OF WORK AREA**  
 RESTORATION OF THE TRAFFIC SIGNAL WORK AREA SHALL BE INCIDENTAL TO THE RELATED PAY ITEM SUCH AS FOUNDATION, CONDUIT HANDHOLE, TRENCH AND BACKFILL, ETC., AND NO EXTRA COMPENSATION SHALL BE ALLOWED. ALL ROADWAY SURFACES SUCH AS SHOULDERS, MEDIANS, SIDEWALKS, PAVEMENT, ETC. SHALL BE REPLACED IN KIND, ALL DAMAGE TO MOWED LAWNS SHALL BE REPLACED WITH AN APPROVED SOD, AND ALL DAMAGE TO UNMOWED FIELDS SHALL BE SEEDED IN ACCORDANCE WITH STANDARD SPECIFICATIONS 252 AND 250 RESPECTIVELY.



|                                     |                      |                    |           |
|-------------------------------------|----------------------|--------------------|-----------|
| FILE NAME = 15.D23301-sht-cp003.dgn | USER NAME = USER8291 | DESIGNED - THG/MPW | REVISED - |
|                                     |                      | DRAWN - THG/MPW    | REVISED - |
|                                     |                      | CHECKED - SRS      | REVISED - |
|                                     |                      | DATE - 08/16/11    | REVISED - |

STATE OF ILLINOIS  
 DEPARTMENT OF TRANSPORTATION

TEMPORARY CABLE PLAN, TEMPORARY PHASE DESIGNATION DIAGRAM  
 AND TEMPORARY EMERGENCY VEHICLE PREEMPTION SEQUENCE  
 SHERIDAN ROAD AND NOYES STREET  
 SCALE: N.T.S. SHEET NO. OF SHEETS STA. TO STA.

| F.A.U. RTE.        | SECTION       | COUNTY | TOTAL SHEETS              | SHEET NO. |
|--------------------|---------------|--------|---------------------------|-----------|
| 2853               | 10-00258-00TL | COOK   | 38                        | 15        |
| CONTRACT NO. 63630 |               |        | ILLINOIS FED. AID PROJECT |           |