

PROP. CURVE ORCHARD-7
 PI STA. = 127+37.78
 $\Delta = 28^\circ 09' 41''$ (RT)
 $D = 7^\circ 38' 22''$
 $R = 750.00'$
 $T = 188.12'$
 $L = 368.63'$
 $E = 23.23'$
 $e = N/A$
 $T.R. = \text{-----}$
 $S.E. \text{ RUN} = \text{-----}$
 $P.C. \text{ STA} = 125+49.66$
 $P.T. \text{ STA} = 129+18.30$

ORCHARD DRIVE

NOTE:
 ALL DIMENSIONS AND ELEVATIONS
 ARE TO THE EDGE OF PAVEMENT
 UNLESS OTHERWISE NOTED.

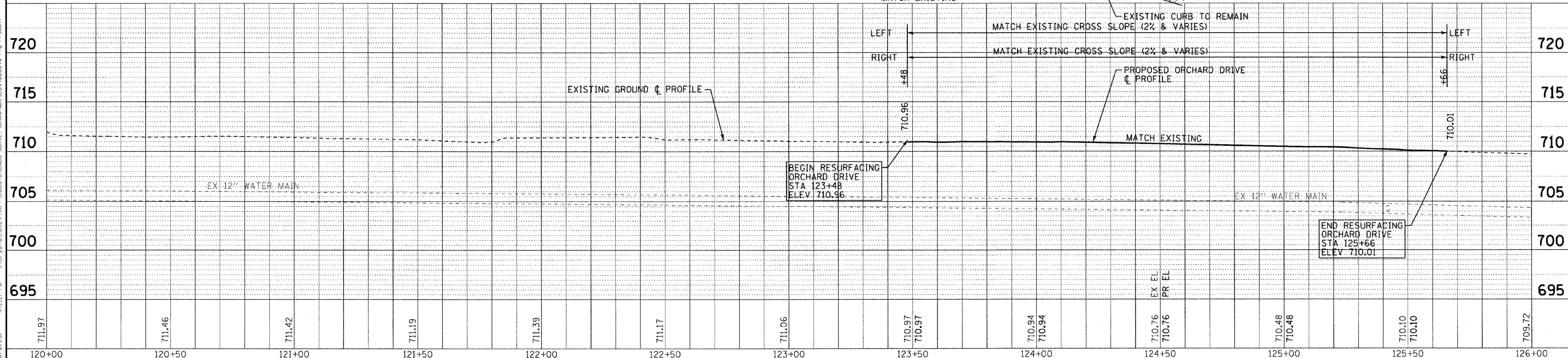

COPYRIGHT © 2011 BY BAXTER & WOODMAN, INC.
 STATE OF ILLINOIS - PROFESSIONAL DESIGN FIRM
 2836 W. WASHINGTON AVE. SUITE 200
 BLOOMINGTON, IL 61710-2000
 PHONE: (312) 426-1234 FAX: (312) 426-1235
 WWW.BAXTERWOODMAN.COM
 FILE NO. 060670-CADD-SURVEY/DRAWINGS/ORDN/060670-PH2-PP5.sht

	DESIGNED - TLH	REVISED -
	DRAWN - UKB	REVISED -
	CHECKED - TAO	REVISED -
	DATE - 10/24/11	FILE - 060670-PH2-PP5.sht

**STATE OF ILLINOIS
 ORCHARD DRIVE IMPROVEMENTS**

**GEOMETRIC PLAN AND PROFILE
 ORCHARD DRIVE**

SCALE: HORIZ. 1"=20' / VERT. 1"=5'

STA. 120+00 TO STA. 126+00

F.A.L. RTE. 2836	SECTION 06-00090-00-FP	COUNTY COOK	TOTAL SHEETS 200	SHEET NO. 32
FED. ROAD DIST. NO. 1 ILLINOIS FED. AID PROJECT			CONTRACT NO. 63635	
M-8003(661)				