

C:\PROJECTS\2011\BAXTER & WOODMAN, INC.\PHASE2\060670-PH2-ER4.sht  
 10/23/2011 10:35:13 PM  
 263.mxd  
 LICENSE NO. - 84-000217 - EXPIRES 4/30/2013  
 10/23/2011 10:35:13 PM  
 C:\PROJECTS\2011\BAXTER & WOODMAN, INC.\PHASE2\060670-PH2-ER4.sht  
 10/23/2011 10:35:13 PM  
 263.mxd

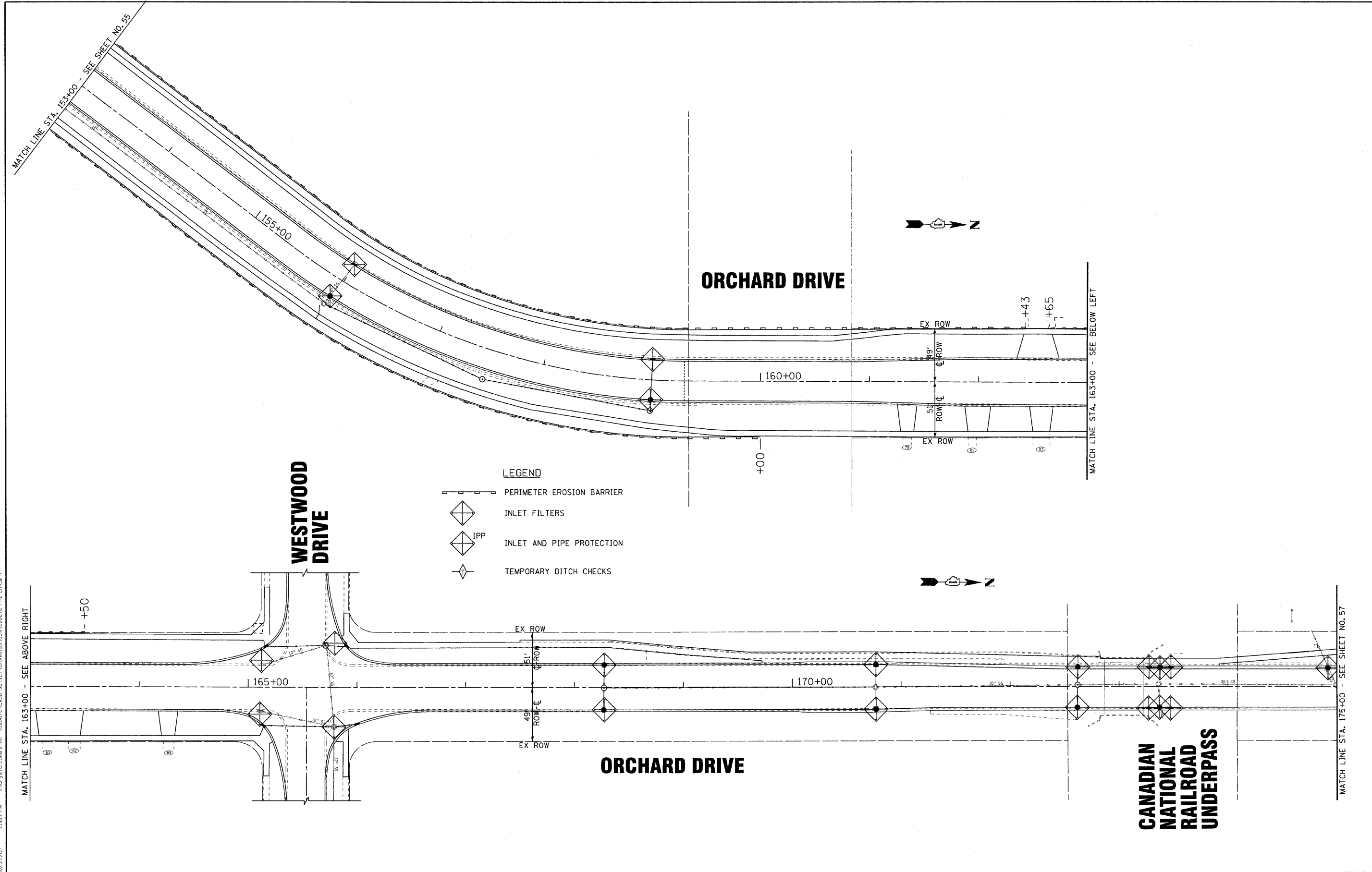

	DESIGNED - TLH	REVISED -
	DRAWN - CJC	REVISED -
	CHECKED - LDH	REVISED -
	DATE - 10/24/11	FILE - 060670-PH2-ER4.sht

**STATE OF ILLINOIS**  
**ORCHARD DRIVE IMPROVEMENTS**

<b>EROSION CONTROL PLAN</b> <b>ORCHARD DRIVE</b>	
SCALE: 1"=40'	STA. 153+00 TO STA. 175+00

F.A.U. RTE. 2836	SECTION 06-00090-00-FP	COUNTY COOK	TOTAL SHEETS 200	SHEET NO. 56
FED. ROAD DIST. NO. 1   ILLINOIS   FED. AID PROJECT			CONTRACT NO. 63635 M-8003(66)J	