

### ORCHARD DRIVE

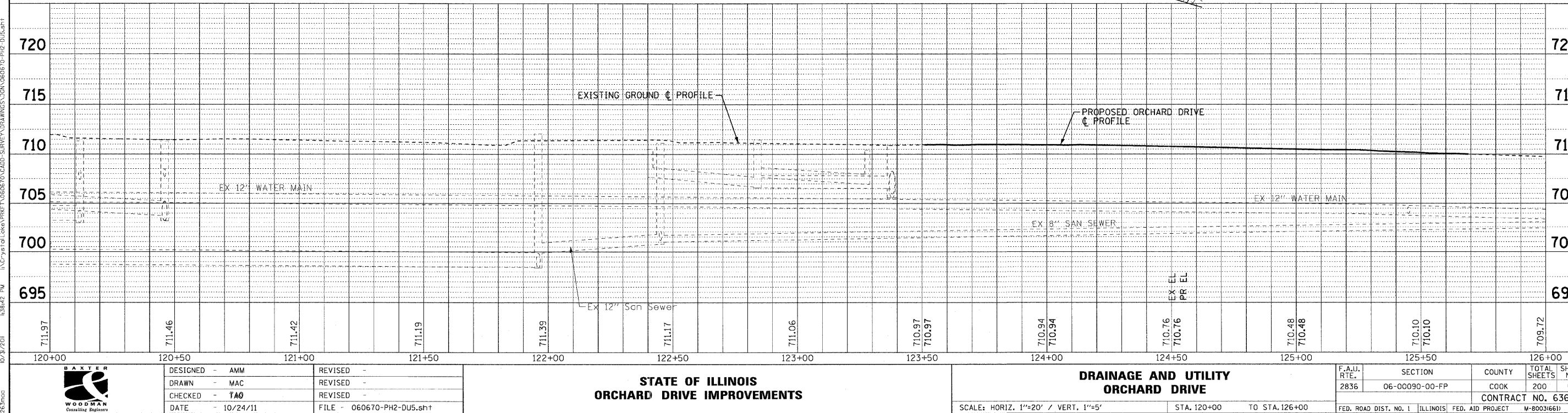

COPYRIGHT © 2011 BY BAXTER & WOODMAN, INC.  
 STATE OF ILLINOIS - PROFESSIONAL DESIGN FIRM  
 263 Madison Street, Chicago, IL 60602-3881  
 TEL: 312.301.0800 FAX: 312.301.0802  
 www.baxterwoodman.com



|                 |                           |
|-----------------|---------------------------|
| DESIGNED - AMM  | REVISED -                 |
| DRAWN - MAC     | REVISED -                 |
| CHECKED - TAO   | REVISED -                 |
| DATE - 10/24/11 | FILE - 060670-PH2-DU5.shp |

#### STATE OF ILLINOIS ORCHARD DRIVE IMPROVEMENTS

SCALE: HORIZ. 1"=20' / VERT. 1"=5'  
 STA. 120+00 TO STA. 126+00  
**DRAINAGE AND UTILITY  
ORCHARD DRIVE**

|                       |                        |                           |                    |              |
|-----------------------|------------------------|---------------------------|--------------------|--------------|
| F.A.J. RTE. 2836      | SECTION 06-00090-00-FP | COUNTY COOK               | TOTAL SHEETS 200   | SHEET NO. 65 |
| FED. ROAD DIST. NO. 1 |                        | ILLINOIS FED. AID PROJECT |                    | M-8003(661)  |
|                       |                        |                           | CONTRACT NO. 63635 |              |