

STORM STRUCTURES

LABEL	STATION	OFFSET (FT)	TYPE	FRAME	ELEVATION	RIM/EP	INVERT
S-59	195+68	40.0	RT CATCH BASIN, TYPE A, 4' DIA.	T-11V F&G	703.20	EP	699.75 15"W
S-60	196+20	34.0	LT MANHOLE, TYPE A, 5' DIA.	T-11 F&G	703.02	EP	696.30 36"NW; 696.30 36"SE(ex)
S-61	196+51	23.0	RT CATCH BASIN, TYPE A, 4' DIA.	T-11V F&G	703.10	EP	699.25 15"SW
S-62	196+45	34.4	LT MANHOLE, TYPE A, 5' DIA.	T-1 F. C.L.	703.98	RIM	696.38 36"SE; 699.00 15"NE; 698.93 15"E; 698.21 15" NW, 696.48 36"W(ex)
S-63	196+89	34.4	LT CATCH BASIN, TYPE A, 4' DIA.	T-11V F&G	702.76	EP	698.46 15"SE; 698.46 15"NW(ex)

PIPES

NO.	TY	DI. (IN)	LENGTH (LF)	SLOPE	TBF (CY)
P-40	STORM SEWERS, RUBBER GASKET, CLASS A	15	106	0.77%	40
P-41	STORM SEWERS, RUBBER GASKET, CLASS A	36	24	0.33%	30
P-42	STORM SEWERS, RUBBER GASKET, CLASS A	15	57	0.44%	23
P-43	STORM SEWERS, CLASS A	15	44	0.57%	17

ORCHARD DRIVE

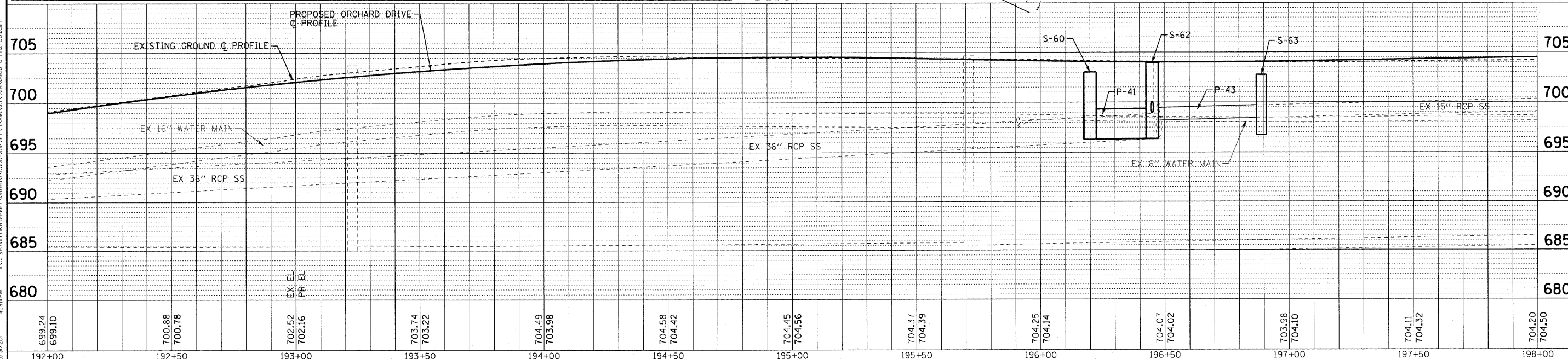

COPYRIGHT © 2011 BY BAXTER & WOODMAN, INC.  
 STATE OF ILLINOIS - PROFESSIONAL DESIGN FIRM  
 LICENSE NO. 184-00321 EXPIRES 4/30/2013  
 PROJECT NO. 06-0090-00-FP  
 DRAWING NO. 060670-PH2-DUI8.sht



DESIGNED - AMM	REVISED -
DRAWN - UKB	REVISED -
CHECKED - TAO	REVISED -
DATE - 10/24/11	FILE - 060670-PH2-DUI8.sht

STATE OF ILLINOIS  
ORCHARD DRIVE IMPROVEMENTS

DRAINAGE AND UTILITY  
ORCHARD DRIVE

SCALE: HORIZ. 1"=20' / VERT. 1"=5'

STA. 192+00 TO STA. 198+00

F.A.J. RTE.	SECTION	COUNTY	TOTAL SHEETS	SHEET NO.
2836	06-0090-00-FP	COOK	200	78
CONTRACT NO. 63635			M-8003661	