

COST TO CONNECT EXISTING 12" STORM SEWER TO JUNCTION CHAMBER INCLUDED IN COST OF S1 CONCRETE

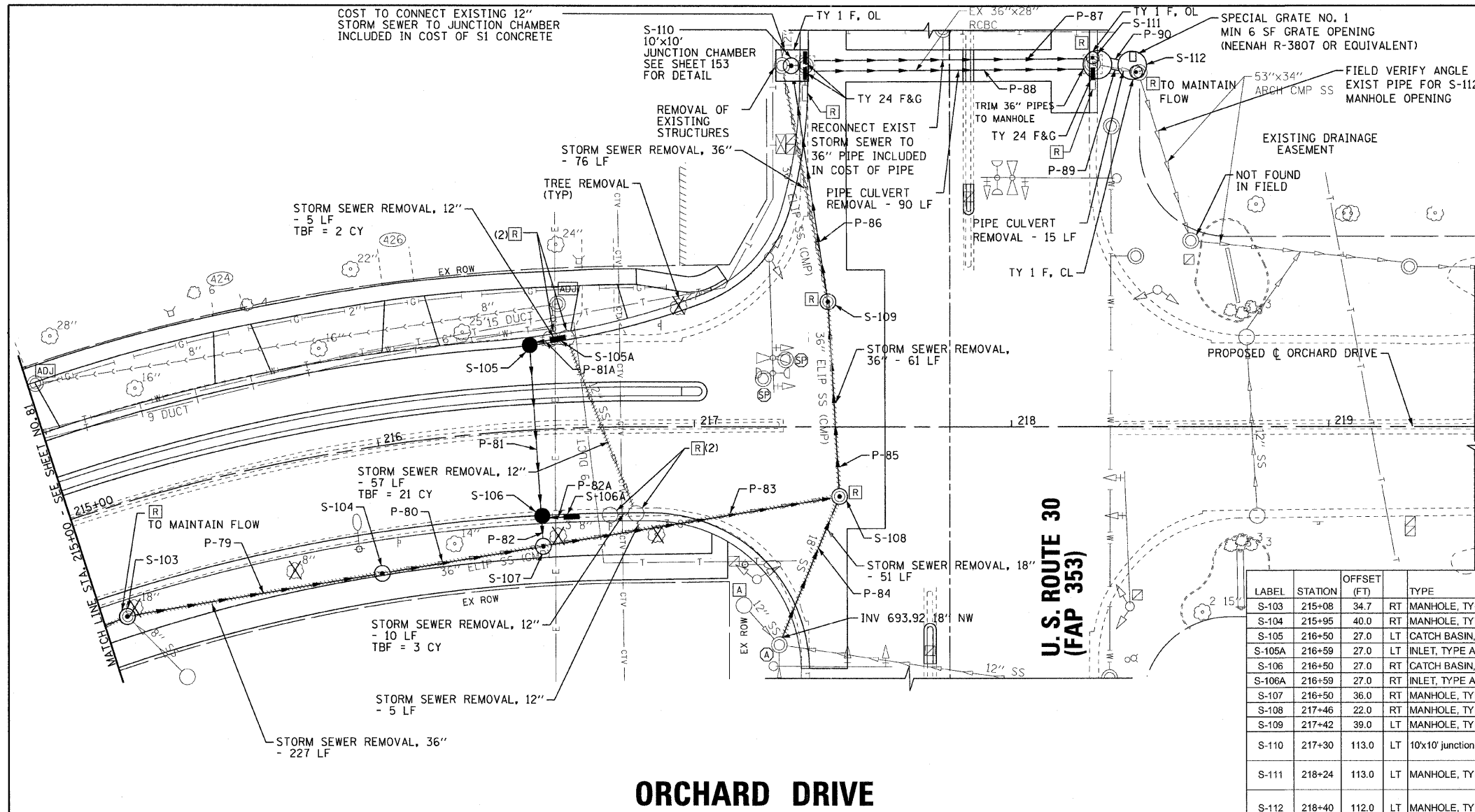

PIPES					
NO.	TYPE	DIA. (IN)	LENGTH (LF)	SLOPE	TBF (CY)
P-79	STORM SEWERS, CLASS A, TYPE	1 38x60	82	0.12%	97
P-80	STORM SEWERS, CLASS A, TYPE	1 38x60	55	0.24%	68
P-81	STORM SEWERS, RUBBER GASKET, CLASS A, TYPE	1 15	54	0.28%	21
P-81A	STORM SEWER (WATER MAIN REQUIREMENTS)	12	9	0.44%	3
P-82	STORM SEWERS, CLASS A, TYPE	2 15	9	4.11%	6
P-82A	STORM SEWERS, CLASS A, TYPE	1 12	9	0.44%	3
P-83	STORM SEWERS, CLASS A, TYPE	1 38x60	96	0.13%	107
P-84	STORM SEWERS, CLASS A, TYPE	2 18	50	2.88%	36
P-85	STORM SEWERS, CLASS A, TYPE	1 38x60	61	0.15%	68
P-86	STORM SEWERS, CLASS A, TYPE	1 38x60	57	0.30%	62
P-87	STORM SEWERS, CLASS A, TYPE	1 36	91	0.36%	79
P-88	STORM SEWERS, CLASS A, TYPE	1 36	91	0.36%	79
P-89	STORM SEWERS, CLASS A, TYPE	1 36	8	0.75%	0
P-90	STORM SEWERS, CLASS A, TYPE	1 36	8	0.75%	0

STORM STRUCTURES						
LABEL	STATION	OFFSET (FT)	TYPE	FRAME	ELEVATION	RIM/EP INVERT
S-103	215+08	34.7	RT MANHOLE, TYPE A, 8' DIA.	T-1 F, C.L.	698.14	RIM 692.00 38"x60"NW,SE; 694.34 8"(ex)
S-104	215+95	40.0	RT MANHOLE, TYPE A, 8' DIA.	T-1 F, C.L.	698.00	RIM 691.90 38"x60"NW,SE
S-105	216+50	27.0	LT CATCH BASIN, TYPE A, 4' DIA.	T-11V F&G	696.85	EP 693.32 15"E; 693.37 12"N
S-105A	216+59	27.0	LT INLET, TYPE A	T-11V F&G	696.86	EP 693.41 12"S
S-106	216+50	27.0	RT CATCH BASIN, TYPE A, 4' DIA.	T-11V F&G	696.92	EP 693.17 15"E,W; 693.17 12"N
S-106A	216+59	27.0	RT INLET, TYPE A	T-11V F&G	696.93	EP 693.21 12"S
S-107	216+50	36.0	RT MANHOLE, TYPE A, 8' DIA.	T-1 F, C.L.	697.50	RIM 691.82 38"x60"SE,N; 692.80 15"W
S-108	217+46	22.0	RT MANHOLE, TYPE A, 9' DIA.	T-1 F, C.L.	697.95	RIM 691.70 38"x60"W,S; 692.48 18"SE
S-109	217+42	39.0	LT MANHOLE, TYPE A, 8' DIA.	T-1 F, C.L.	697.29	RIM 691.61 38"x60"E,W
S-110	217+30	113.0	LT 10'x10' junction chamber	T-1 F, O.L.; 2-T-24 F&G	697.60 697.09	RIM 691.44 38"x60"E; 691.40 36"(2pipes)N; 691.83 12"W(ex)
S-111	218+24	113.0	LT MANHOLE, TYPE A, 9' DIA.	T-1 F, O.L.; T-24 F&G	697.01	EP 691.07 36"(2pipes)S,N
S-112	218+40	112.0	LT MANHOLE, TYPE A, 9' DIA.	T-1 F, C.L.; SPG1	695.70	RIM 691.01 36"(2pipes)S; 691.01 53"x34" Arch CMP NE(ex)

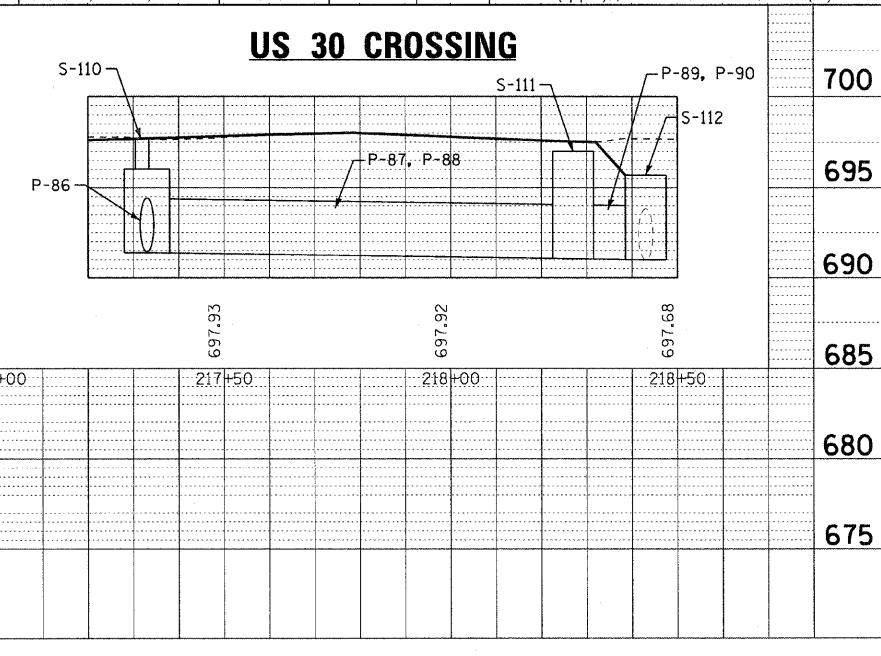
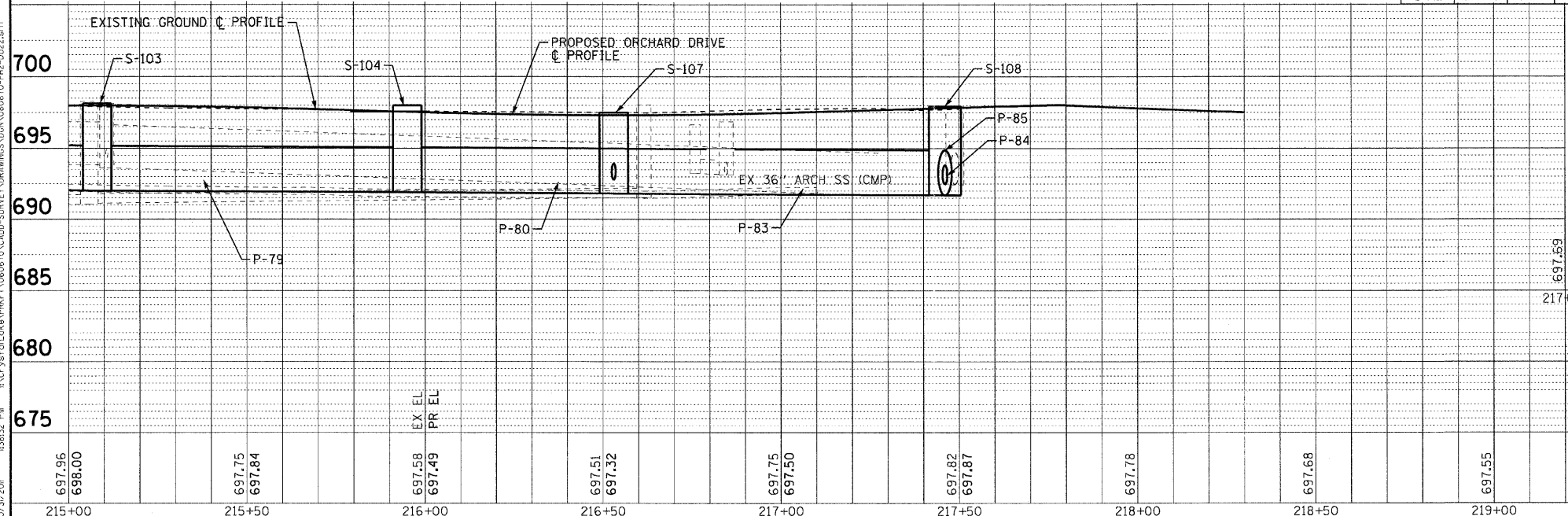

COPYRIGHT © 2011 BY BAXTER & WOODMAN, INC.
 STATE OF ILLINOIS PROFESSIONAL ENGINEER
 LICENSE NO. 04-00121 - EXPIRES 4/30/2013
 10/23/2011 10:32:32 PM



DESIGNED - AMM	REVISED -
DRAWN - UKB	REVISED -
CHECKED - TAD	REVISED -
DATE - 10/24/11	FILE - 060670-PH2-DU22.sh1

**STATE OF ILLINOIS
ORCHARD DRIVE IMPROVEMENTS**

**DRAINAGE AND UTILITY
ORCHARD DRIVE**

F.A.J. RTE. 2836	SECTION 06-00090-00-FP	COUNTY COOK	TOTAL SHEETS 200	SHEET NO. 82
SCALE: HORIZ. 1"=20' / VERT. 1"=5'		STA. 215+00 TO STA. 217+38.09		CONTRACT NO. 63635
FED. ROAD DIST. NO. 1 ILLINOIS FED. AID PROJECT M-8003661				