

HORIZONTAL CONTROL POINT NO. 52

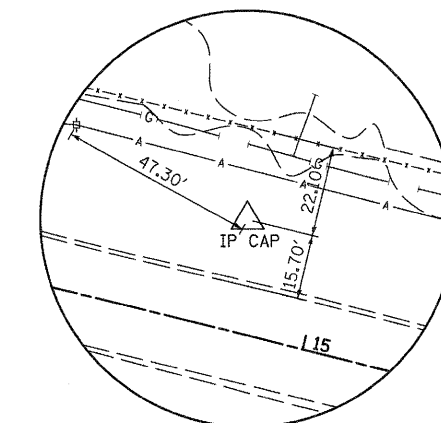

HORIZONTAL CONTROL POINT NO. 53

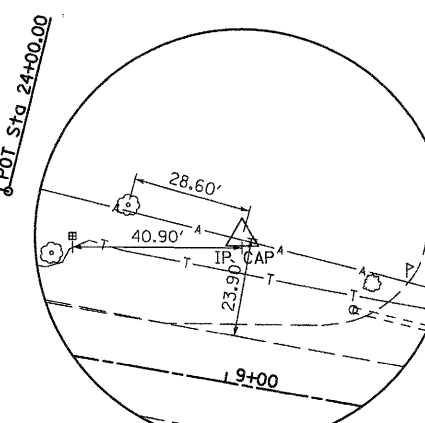

HORIZONTAL CONTROL POINT NO. 511

**LEGEND**

- ⊙ = BENCH MARK LOCATION
- △ = HORIZONTAL CONTROL POINT LOCATION

**HORIZONTAL CONTROL POINTS**

POINT	NORTH	EAST	ELEVATION	CHAIN	STATION	OFFSET	DESCRIPTION
52	1928978.061	976396.275	761.451	BURR	12+58.15	16.133' LT	IRON PIPE WITH CAP
53	1929196.266	976438.028	763.042	BURR	14+79.66	27.128' LT	IRON PIPE WITH CAP
511	1928626.999	976309.372	769.760	BURR	8+98.14	35.295' LT	IRON PIPE WITH CAP

**SURVEY WORK POINTS**

POINT	NORTH	EAST	ELEVATION	CHAIN	STATION	OFFSET	DESCRIPTION
2148	1928469.552	976349.241	770.161	BURR	7+49.77	30.777' RT	PK NAIL

**BENCH MARKS (NAVD 88)**

POINT	NORTH	EAST	ELEVATION	CHAIN	STATION	OFFSET	DESCRIPTION
401	1928872.19	976374.91	763.29	BURR	11+50.48	14.74' LT	CHISELED SQUARE

FILE NAME = MAPProject\2010\100205 Burr-Ferguson\1\0001\0001.dgn

**WILLS BURKE KELSEY ASSOCIATES LTD.**  
 116 West Main Street, Suite 201  
 St. Charles, Illinois 60174

USER NAME = nporris	DESIGNED - KMA	REVISED -
PLOT SCALE =	DRAWN - NDP	REVISED -
PLOT DATE = 10/19/2011	CHECKED - SBP	REVISED -
	DATE - 10/24/11	REVISED -

**STATE OF ILLINOIS  
 DEPARTMENT OF TRANSPORTATION**

**ALIGNMENT, TIES  
 & BENCHMARKS**

SCALE:	SHEET NO. 16 OF 76 SHEETS	STA. TO STA.	I.R. RTE.	SECTION	COUNTY	TOTAL SHEETS	SHEET NO.
			194	08-14117-00-BR	KANE	76	16
			FED. ROAD DIST. NO. 1 [ILLINOIS] FED. AID PROJECT				

**CONTRACT NO. 63645**