

Notes:
 See sheet 11 of 20 for Sections C-C and D-D.
 $a_4(E)$ and $a_5(E)$ bar spacings measured along C Rdwy.
 See sheet 12 of 20 for Railing and Railing Connection
 Details.

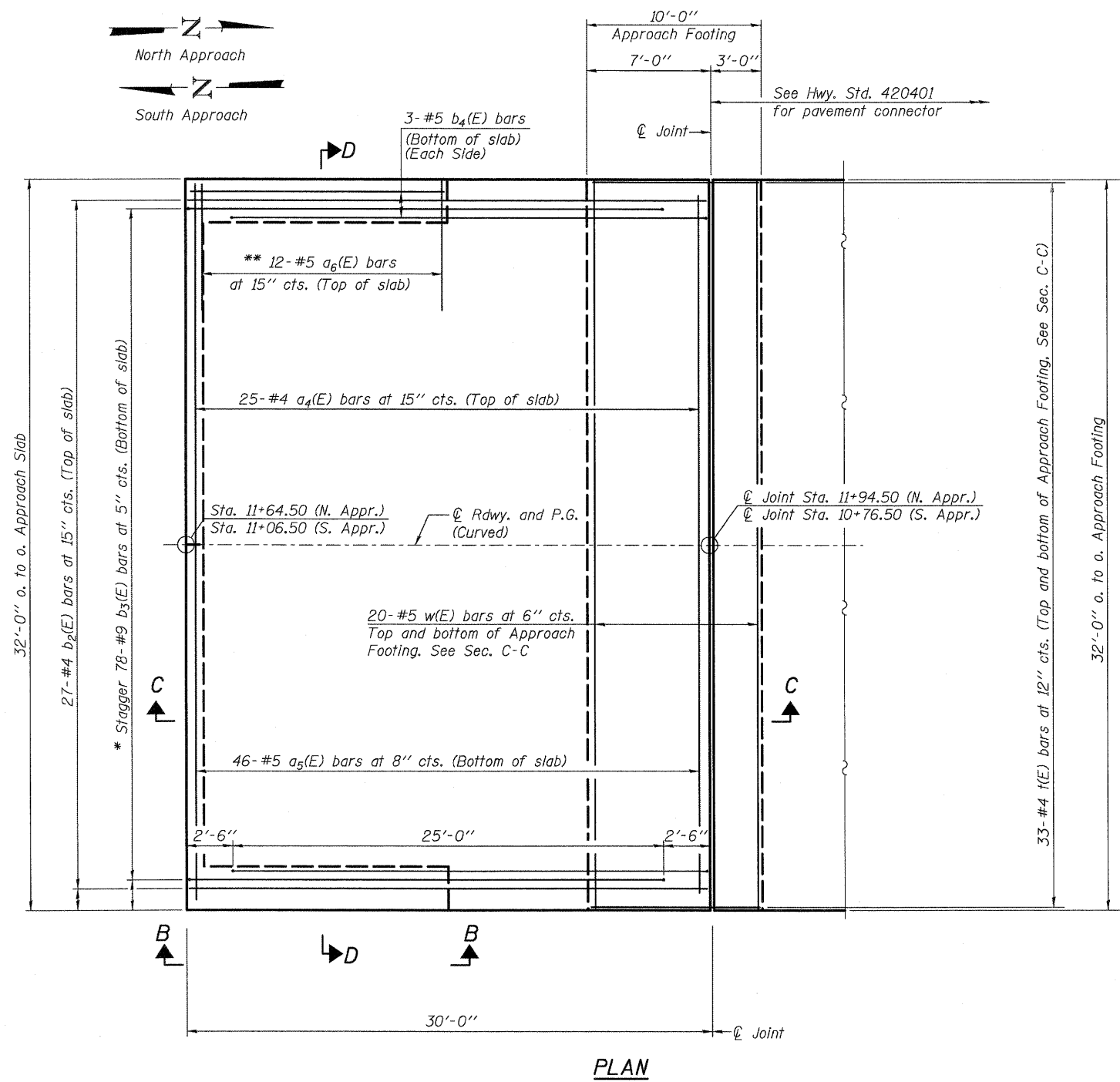

* Tilt #9 $b_3(E)$ bars as required to maintain clearance.
 ** Space between $a_4(E)$ bars, typ. each end in thickened slab.

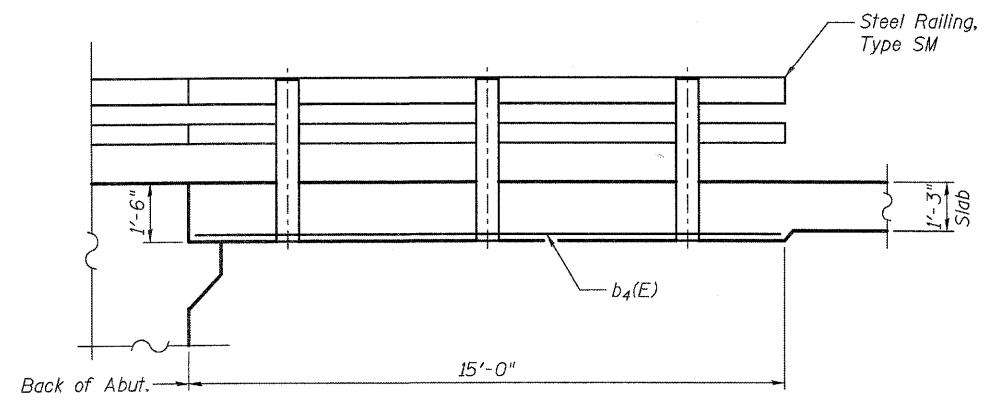
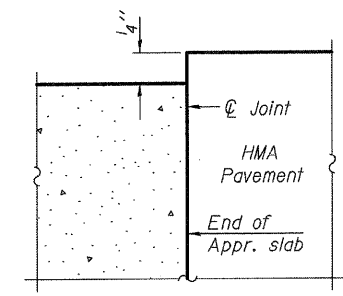

BA-0

7-1-10

(Sheet 1 of 2)

WILLS BURKE KELSEY ASSOCIATES LTD.
 118 West Main Street, Suite 201
 St. Charles, Illinois 60174

USER NAME = nparr18	DESIGNED - HLF	REVISED -
PLOT SCALE =	CHECKED - AEU	REVISED -
PLOT DATE = 10/18/2011	DRAWN - HLF	REVISED -
	CHECKED - AEU	REVISED -

STATE OF ILLINOIS
DEPARTMENT OF TRANSPORTATION

BRIDGE APPROACH SLAB DETAILS
STRUCTURE NO. 045-3080

SHEET NO. 10 OF 20 SHEETS

T.R. RTE.	SECTION	COUNTY	TOTAL SHEETS	SHEET NO.
0194	08-14117-00-BR	KANE	76	43
FED. ROAD DIST. NO.			ILLINOIS FED. AID PROJECT	
			CONTRACT NO. 63645	

FILE NAME = W:\Projects\2010\180925 BurrFerson\1\cadd\Struct\ur-01.dgn 10/18/2011 10:18:25 AM