

11/7/2011

NOTES:

1. NEW ELEMENTS SHOWN IN BOLD. EXISTING ELEMENTS INCLUDED FOR REFERENCE ONLY (GRAYSCALE).
2. EXISTING CONDITIONS, INCLUDING THE CONDITION AND AVAILABILITY OF CONDUITS, HAVE NOT BEEN FIELD VERIFIED. CONTRACTOR MUST VERIFY EXISTING CONDITIONS BEFORE COMMENCING WORK.
3. THE EXACT LOCATION OF ALL UTILITIES SHALL BE FIELD VERIFIED BY THE CONTRACTOR BEFORE THE INSTALLATION OF ANY COMPONENT OF THE TRAFFIC SIGNAL SYSTEM.
4. THE CONTRACTOR SHALL CONTACT THE KANE COUNTY DIVISION OF TRANSPORTATION (630.584.1170) FOR TRAFFIC SIGNAL CABLE LOCATIONS A MINIMUM OF 48 HOURS IN ADVANCE (SATURDAYS, SUNDAYS, AND HOLIDAYS EXCLUDED) AT ANY LOCATION WITHIN THE RIGHT-OF-WAY.
5. ELECTRICAL SERVICE METER WILL NEED TO BE RELOCATED BY CITY OF ST. CHARLES

SEE SHEET 64 FOR TRAFFIC SIGNAL LEGEND

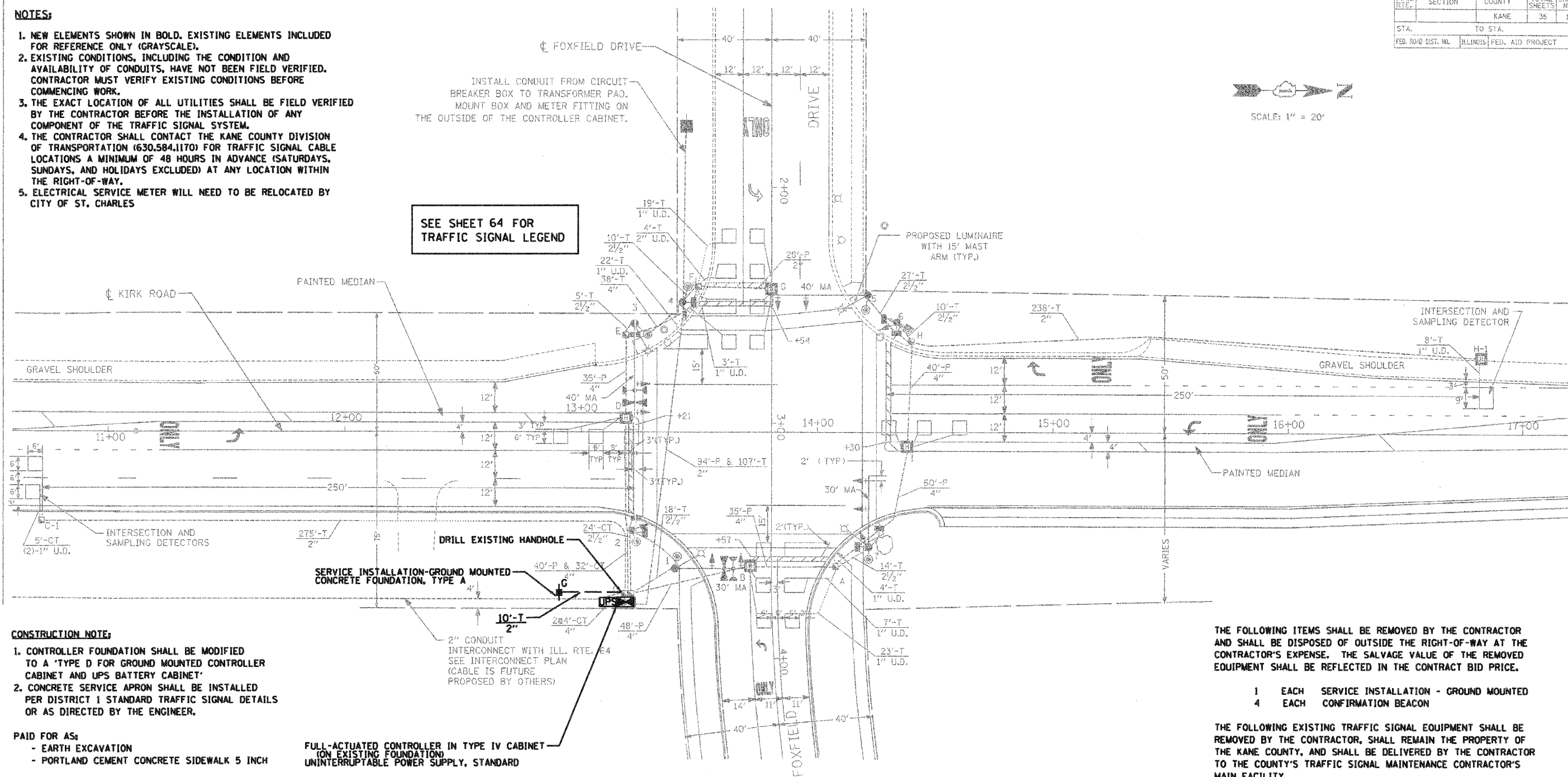

CONSTRUCTION NOTE:

1. CONTROLLER FOUNDATION SHALL BE MODIFIED TO A 'TYPE D FOR GROUND MOUNTED CONTROLLER CABINET AND UPS BATTERY CABINET'
2. CONCRETE SERVICE APRON SHALL BE INSTALLED PER DISTRICT 1 STANDARD TRAFFIC SIGNAL DETAILS OR AS DIRECTED BY THE ENGINEER.

PAID FOR AS:

- EARTH EXCAVATION
- PORTLAND CEMENT CONCRETE SIDEWALK 5 INCH

FULL-ACTUATED CONTROLLER IN TYPE IV CABINET ON EXISTING FOUNDATION UNINTERRUPTABLE POWER SUPPLY, STANDARD

THE FOLLOWING ITEMS SHALL BE REMOVED BY THE CONTRACTOR AND SHALL BE DISPOSED OF OUTSIDE THE RIGHT-OF-WAY AT THE CONTRACTOR'S EXPENSE. THE SALVAGE VALUE OF THE REMOVED EQUIPMENT SHALL BE REFLECTED IN THE CONTRACT BID PRICE.

- 1 EACH SERVICE INSTALLATION - GROUND MOUNTED
- 4 EACH CONFIRMATION BEACON

THE FOLLOWING EXISTING TRAFFIC SIGNAL EQUIPMENT SHALL BE REMOVED BY THE CONTRACTOR. SHALL REMAIN THE PROPERTY OF THE KANE COUNTY, AND SHALL BE DELIVERED BY THE CONTRACTOR TO THE COUNTY'S TRAFFIC SIGNAL MAINTENANCE CONTRACTOR'S MAIN FACILITY.

- 1 EACH FULL-ACTUATED CONTROLLER AND TYPE IV CABINET
- 1 EACH MALFUNCTION MANAGEMENT UNIT

THE COUNTY'S TRAFFIC SIGNAL MAINTENANCE CONTRACTOR IS MEADE ELECTRIC, CO. LOCATED AT:

30 W 751 NORTH AURORA ROAD
NAPERVILLE, IL 60563
TEL (708) 588-2500

ALL REMOVED ITEMS LISTED WILL BE PAID AS REMOVE EXISTING TRAFFIC SIGNAL EQUIPMENT.

RESTORATION OF WORK AREA: RESTORATION OF THE TRAFFIC SIGNAL WORK AREA SHALL BE INCIDENTAL TO THE RELATED PAY ITEM SUCH AS FOUNDATION, CONDUIT, HANDHOLE, TRENCH AND BACKFILL, ETC., AND NO EXTRA COMPENSATION SHALL BE ALLOWED. ALL ROADWAY SURFACES SUCH AS SHOULDERS, MEDIANS, SIDEWALKS, PAYEMENT, ETC. SHALL BE REPLACED IN KIND. ALL DAMAGE TO MOWED LAWNS SHALL BE REPLACED WITH AN APPROVED SOD. AND ALL DAMAGE TO UNMOWED FIELDS SHALL BE SEEDED IN ACCORDANCE WITH STANDARD SPECIFICATIONS 252 AND 250 RESPECTIVELY. SOD SHALL BE WATERED AS DIRECTED BY ENGINEER AND PER ACT 252.08 & 252.09 IN STP SPECS.

P:\2011\98708\708 CAD & GIS Files\702 Civil\Sheet\03a.Signal.Kirk and Foxfield.dgn

JACOBS
ONE NORTH FRANKLIN
CHICAGO IL, 60606
312-251-3000

USER NAME =	DESIGNED - CH	REVISED -
PLOT SCALE =	DRAWN - MO, DI	REVISED -
PLOT DATE = 11/7/2011	CHECKED - KG	REVISED -
	DATE - #DATE	REVISED -

KANE COUNTY
DIVISION OF TRANSPORTATION

TRAFFIC SIGNAL PLAN
KIRK ROAD AND FOXFIELD DRIVE

SCALE: SHEET NO. OF SHEETS STA. TO STA.

F.A.P. RTE. 360	SECTION 10-00403-00-TL	COUNTY KANE	TOTAL SHEETS 72	SHEET NO. 27
CONTRACT NO. 63648			FED. ROAD DIST. NO. (ILLINOIS) FED. AID PROJECT	