

11/7/2011

THE FOLLOWING ITEMS SHALL BE REMOVED BY THE CONTRACTOR AND SHALL BE DISPOSED OF OUTSIDE THE RIGHT-OF-WAY AT THE CONTRACTOR'S EXPENSE. THE SALVAGE VALUE OF THE REMOVED EQUIPMENT SHALL BE REFLECTED IN THE CONTRACT BID PRICE.

4 EACH CONFIRMATION BEACON

THE FOLLOWING EXISTING TRAFFIC SIGNAL EQUIPMENT SHALL BE REMOVED BY THE CONTRACTOR, SHALL REMAIN THE PROPERTY OF THE KANE COUNTY, AND SHALL BE DELIVERED BY THE CONTRACTOR TO THE COUNTY'S TRAFFIC SIGNAL MAINTENANCE CONTRACTOR'S MAIN FACILITY.

- 1 EACH MALFUNCTION MANAGEMENT UNIT
- 1 EACH ETHERNET SWITCH TYPE I (GARRETCOM ES42)
- 1 EACH TREEHAVEN RVSFB120
- 1 EACH IVDO STREAMER/ENCODER
- 1 EACH PTZ CAMERA
- 1 EACH VIDEO MONITOR

THE COUNTY'S TRAFFIC SIGNAL MAINTENANCE CONTRACTOR IS MEADE ELECTRIC, CO. LOCATED AT:

30 W 751 NORTH AURORA ROAD
NAPERVILLE, IL 60563
TEL (708) 588-2500

ALL REMOVED ITEMS LISTED WILL BE PAID AS REMOVE EXISTING TRAFFIC SIGNAL EQUIPMENT.

SEE SHEET 64 FOR TRAFFIC SIGNAL LEGEND

NOTES:

1. NEW ELEMENTS SHOWN IN BOLD. EXISTING ELEMENTS INCLUDED FOR REFERENCE ONLY (GRAYSCALE).
2. EXISTING CONDITIONS, INCLUDING THE CONDITION AND AVAILABILITY OF CONDUITS, HAVE NOT BEEN FIELD VERIFIED. CONTRACTOR MUST VERIFY EXISTING CONDITIONS BEFORE COMMENCING WORK.
3. THE EXACT LOCATION OF ALL UTILITIES SHALL BE FIELD VERIFIED BY THE CONTRACTOR BEFORE THE INSTALLATION OF ANY COMPONENT OF THE TRAFFIC SIGNAL SYSTEM.
4. THE CONTRACTOR SHALL CONTACT THE KANE COUNTY DIVISION OF TRANSPORTATION (630.584.1170) FOR TRAFFIC SIGNAL CABLE LOCATIONS A MINIMUM OF 48 HOURS IN ADVANCE (SATURDAYS, SUNDAYS, AND HOLIDAYS EXCLUDED) AT ANY LOCATION WITHIN THE RIGHT-OF-WAY.

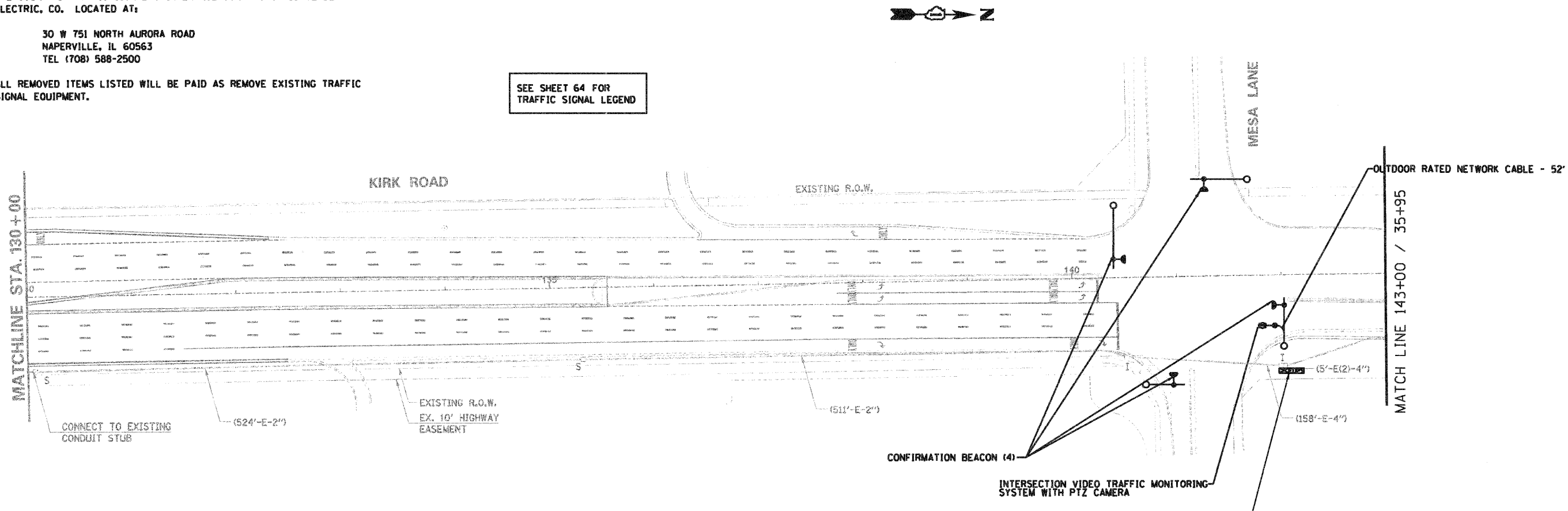

SCHEDULE OF QUANTITIES - KIRK ROAD AND MESA LANE

PAY ITEM	UNIT	QUANTITY
REMOVE EXISTING TRAFFIC SIGNAL EQUIPMENT	EACH	1
VIDEO SYSTEM DETECTION PROCESSOR	EACH	1
MODIFY EXISTING CONTROLLER CABINET, SPECIAL	EACH	1
MALFUNCTION MANAGEMENT UNIT	EACH	1
RE-OPTIMIZE TRAFFIC SIGNAL SYSTEM, LEVEL 2	EACH	1
CONFIRMATION BEACON	EACH	4
ETHERNET MANAGED SWITCH, TYPE I	EACH	1
MAINTENANCE OF EXISTING TRAFFIC SIGNAL INSTALLATION	EACH	1
INTERSECTION VIDEO TRAFFIC MONITORING SYSTEM WITH PTZ CAMERA	EACH	1
OUTDOOR RATED NETWORK CABLE	FOOT	52

RESTORATION OF WORK AREA RESTORATION OF THE TRAFFIC SIGNAL WORK AREA SHALL BE INCIDENTAL TO THE RELATED PAY ITEM SUCH AS FOUNDATION, CONDUIT, HANDHOLE, TRENCH AND BACKFILL, ETC., AND NO EXTRA COMPENSATION SHALL BE ALLOWED. ALL ROADWAY SURFACES SUCH AS SHOULDERS, MEDIANS, SIDEWALKS, PAVEMENT, ETC. SHALL BE REPLACED IN KIND. ALL DAMAGE TO MOWED LAWNS SHALL BE REPLACED WITH AN APPROVED SOD, AND ALL DAMAGE TO UNMOWED FIELDS SHALL BE SEEDED IN ACCORDANCE WITH STANDARD SPECIFICATIONS 252 AND 250 RESPECTIVELY. SOD SHALL BE WATERED AS DIRECTED BY ENGINEER AND PER ACT 252.08 & 252.09 IN STP SPECS.

REMOVE EXISTING TRAFFIC SIGNAL EQUIPMENT
VIDEO DETECTOR PROCESSOR (EDGECONNECT QUAD-VIEW ONLY)
MODIFY EXISTING CONTROLLER CABINET, SPECIAL
ETHERNET MANAGED SWITCH TYPE I
MALFUNCTION MANAGEMENT UNIT (EDI-16LE1p)
REMOVE EXISTING CCTV/VIDEO EQUIPMENT

P:\A_2011\09\06\700\700\000 & GIS Files\702 Civil\Sheet\103_Interconnect Kirk and IL56-3.dgn

JACOBS
ONE NORTH FRANKLIN
CHICAGO IL, 60606
312-251-3000

USER NAME =
PLOT SCALE =
PLOT DATE = 11/7/2011

DESIGNED - CH	REVISED -
DRAWN - MO, DI	REVISED -
CHECKED - KG	REVISED -
DATE - #DATE	REVISED -

**KANE COUNTY
DIVISION OF TRANSPORTATION**

**INTERCONNECT PLAN
KIRK ROAD (SHEET 3 OF 22)**

SCALE: SHEET NO. OF SHEETS STA. TO STA.

F.A.P. RTE. 360	SECTION 10-00403-00-TL	COUNTY KANE	TOTAL SHEETS 72	SHEET NO. 35
CONTRACT NO. 63648			ILLINOIS FED. AID PROJECT	