

10/21/2011

P:\2011\956700\700 CAD & GIS Files\702 Civil\Sheet\19 Interconnect Dunham end IL 25-1.dgn

NOTES:

1. NEW ELEMENTS SHOWN IN BOLD. EXISTING ELEMENTS INCLUDED FOR REFERENCE ONLY (GRAYSCALE).
2. EXISTING CONDITIONS, INCLUDING THE CONDITION AND AVAILABILITY OF CONDUITS, HAVE NOT BEEN FIELD VERIFIED. CONTRACTOR MUST VERIFY EXISTING CONDITIONS BEFORE COMMENCING WORK.
3. THE EXACT LOCATION OF ALL UTILITIES SHALL BE FIELD VERIFIED BY THE CONTRACTOR BEFORE THE INSTALLATION OF ANY COMPONENT OF THE TRAFFIC SIGNAL SYSTEM.
4. THE CONTRACTOR SHALL CONTACT THE KANE COUNTY DIVISION OF TRANSPORTATION (630.584.1170) FOR TRAFFIC SIGNAL CABLE LOCATIONS A MINIMUM OF 48 HOURS IN ADVANCE (SATURDAYS, SUNDAYS, AND HOLIDAYS EXCLUDED) AT ANY LOCATION WITHIN THE RIGHT-OF-WAY.

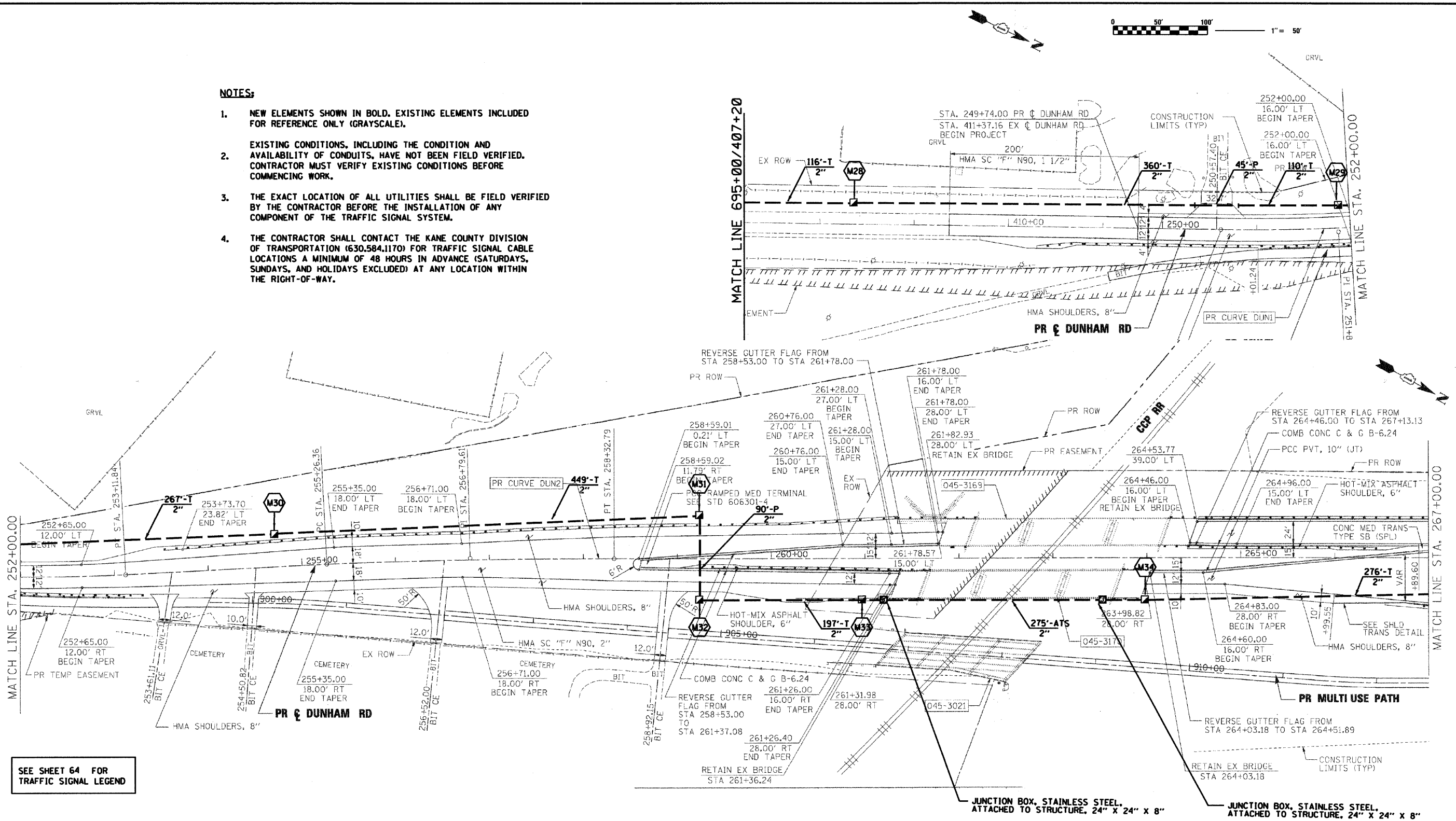

SEE SHEET 64 FOR TRAFFIC SIGNAL LEGEND

RESTORATION OF WORK AREA, RESTORATION OF THE TRAFFIC SIGNAL WORK AREA SHALL BE INCIDENTAL TO THE RELATED PAY ITEM SUCH AS FOUNDATION, CONDUIT, HANDHOLE, TRENCH AND BACKFILL, ETC., AND NO EXTRA COMPENSATION SHALL BE ALLOWED. ALL ROADWAY SURFACES SUCH AS SHOULDERS, MEDIANS, SIDEWALKS, PAVEMENT, ETC. SHALL BE REPLACED IN KIND. ALL DAMAGE TO MOWED LAWNS SHALL BE REPLACED WITH AN APPROVED SOD, AND ALL DAMAGE TO UNMOWED FIELDS SHALL BE SEED IN ACCORDANCE WITH STANDARD SPECIFICATIONS 252 AND 250 RESPECTIVELY. SOD SHALL BE WATERED AS DIRECTED BY ENGINEER AND PER ACT 252.08 & 252.09 IN STP SPECS.

JACOBS
ONE NORTH FRANKLIN
CHICAGO IL, 60606
312-251-3000

USER NAME =	DESIGNED - CH	REVISED -
PLOT SCALE =	DRAWN - MO, DI	REVISED -
PLOT DATE = 10/21/2011	CHECKED - KG	REVISED -
	DATE - #DATE	REVISED -

**KANE COUNTY
DIVISION OF TRANSPORTATION**

**INTERCONNECT PLANS
DUNHAM ROAD (SHEET 19 OF 22)**

SCALE: 1" = 50' SHEET NO. OF SHEETS STA. TO STA.

F.A.P. RTE. 360	SECTION 10-00403-00-TL	COUNTY KANE	TOTAL SHEETS 72	SHEET NO. 51
FED. ROAD DIST. NO. ILLINOIS FED. AID PROJECT			CONTRACT NO. 63648	