

ADVANCE SIGN SEQUENCE

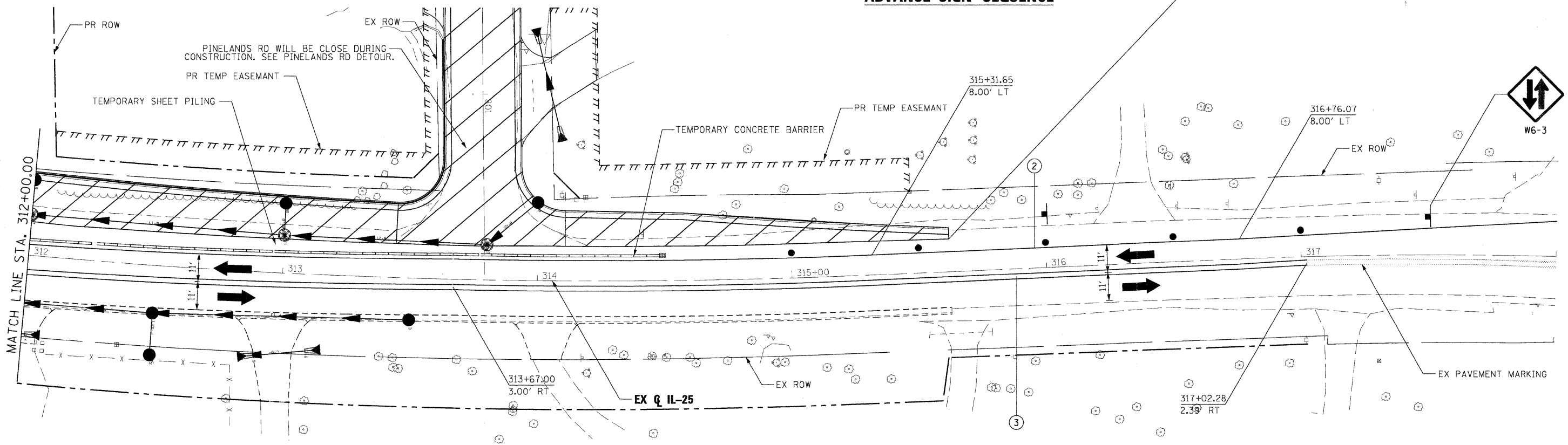

LEGEND

- WORK AREA
- FLASHING ARROW BOARD
- TRAFFIC LANE
- TYPE III BARRICADES
- VERTICAL PANELS @ 200' UNLESS OTHERWISE SHOWN
- TEMPORARY SIGN
- DRUMS @ 50' CENTERS UNLESS OTHERWISE SHOWN
- IMPACT ATTENUATOR
- PROPOSED ROW
- EXISTING ROW
- TEMPORARY EASEMENT
- ① TEMPORARY PAVEMENT MARKING TAPE, TYPE III, LETTERS AND SYMBOLS (WHITE)
- ② TEMPORARY PAVEMENT MARKING TAPE, TYPE III, 4 INCH (WHITE)
- ③ TEMPORARY PAVEMENT MARKING TAPE, TYPE III, 4 INCH (DOUBLE YELLOW)
- ④ TEMPORARY PAVEMENT MARKING TAPE, TYPE III, 6 INCH (WHITE)
- ⑤ TEMPORARY PAVEMENT MARKING TAPE, TYPE III, 12 INCH (WHITE)
- ⑥ TEMPORARY PAVEMENT MARKING TAPE, TYPE III, 12 INCH (YELLOW)
- ⑦ TEMPORARY PAVEMENT MARKING TAPE, TYPE III, 24 INCH (WHITE)
- ⑧ TEMPORARY PAVEMENT MARKING TAPE, TYPE III, 6 INCH (WHITE DOTTED)

PLOT SCALE: 1"=20'
 FILE NAME: ...
 USER NAME: mcoleman
 PLOT DATE: 11/18/2011

FILE NAME =	DESIGNED - MAC	REVISED -
...\\prpln-abc-shr-IL25-mat2-06.dgn	DRAWN - TMB	REVISED -
USER NAME = mcoleman	CHECKED - RMT	REVISED -
PLOT DATE = 11/18/2011	DATE - 10/23/2011	REVISED -



CITY OF ST. CHARLES

**MAINTENANCE OF TRAFFIC
IL 25 — STAGE 2**

SCALE: 1"=20' SHEET NO. 20 OF 20 SHEETS STA. 312+00.00 TO STA. EOP

F.A. RTE.	SECTION	COUNTY	TOTAL SHEETS	SHEET NO.
	04-00092-00-BR	KANE	440	101
CONTRACT NO. 63650				
ILLINOIS FED. AID PROJECT				