

DATE	
BY	
SURVEYED	
ALIGNED	
CHECKED	
RT. OF WAY CHECKED	
NO. OF WAY CHECKED	
NO.	
PLAN	
NO.	

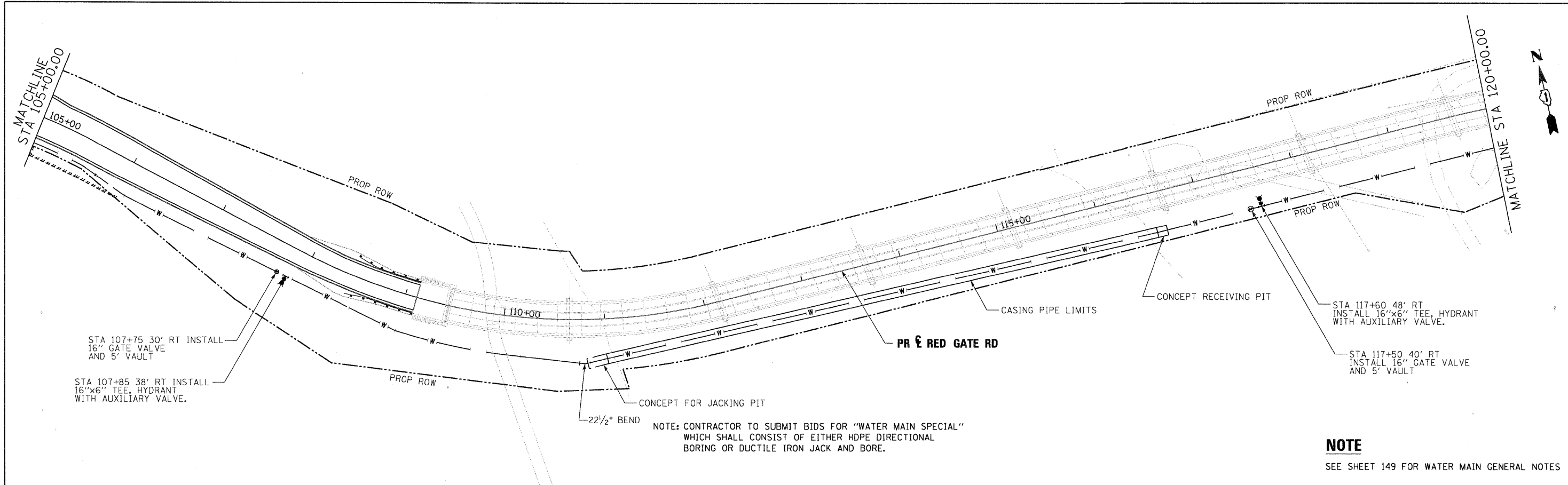

NOTE: CONTRACTOR TO SUBMIT BIDS FOR "WATER MAIN SPECIAL" WHICH SHALL CONSIST OF EITHER HDPE DIRECTIONAL BORING OR DUCTILE IRON JACK AND BORE.

**NOTE**  
SEE SHEET 149 FOR WATER MAIN GENERAL NOTES

DATE	
BY	
SURVEYED	
ALIGNED	
CHECKED	
RT. OF WAY CHECKED	
NO. OF WAY CHECKED	
NO.	
PROFILE	
NO.	

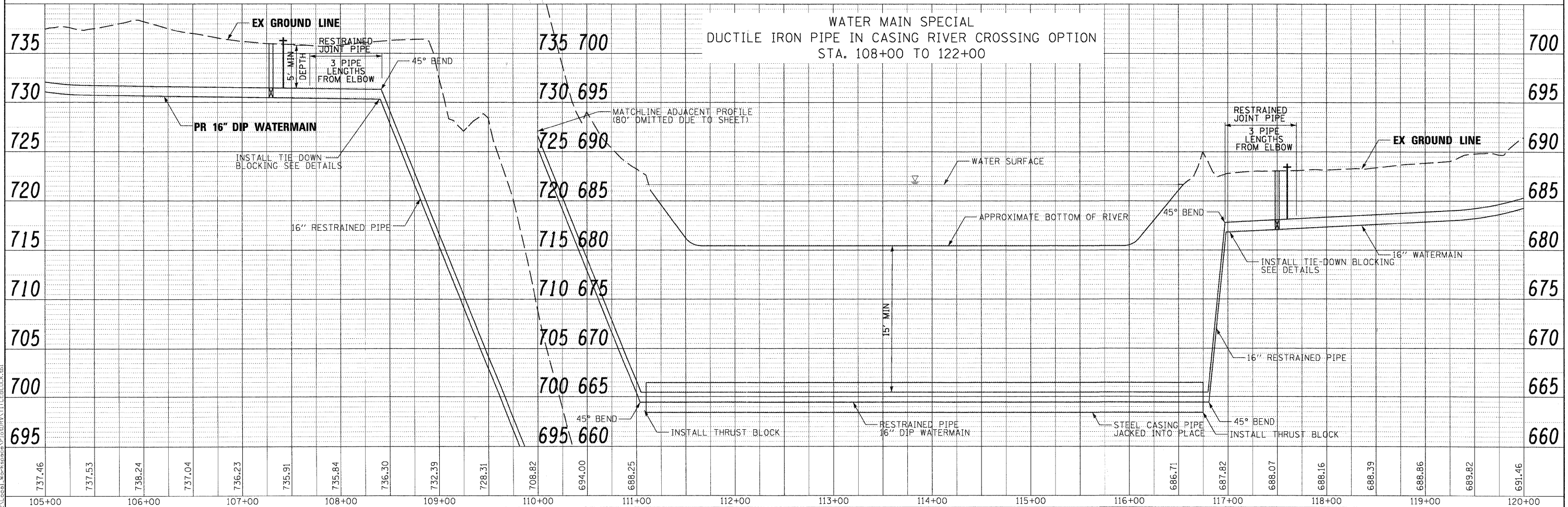

PLOT SCALE: 1"=50' (PLAN) 1"=10' (PROFILE) FILL SIZE: 1/8" X 1/8" (PLAN) 1/4" X 1/4" (PROFILE) PLOT DATE: 11/10/2011

FILE NAME =	DESIGNED - MAC	REVISED -		<b>CITY OF ST. CHARLES</b>	<b>WATER MAIN PLAN &amp; PROFILE</b> <b>RED GATE ROAD</b>			F.A. RTE.	SECTION	COUNTY	TOTAL SHEETS	SHEET NO.
USER NAME = mooleman	DRAWN - TMB	REVISED -						04-00092-00-BR	KANE	440	145	
PLOT DATE = 11/10/2011	CHECKED - RMT	REVISED -						CONTRACT NO. 63650				
	DATE - 10/23/2011	REVISED -						ILLINOIS FED. AID PROJECT				