

- NOTES:**
1. For pier details, see sheets S41 thru S47.
  2. For abutment details, see sheets S37 thru S40.

**FOUNDATION PLAN - SPANS 1-4**

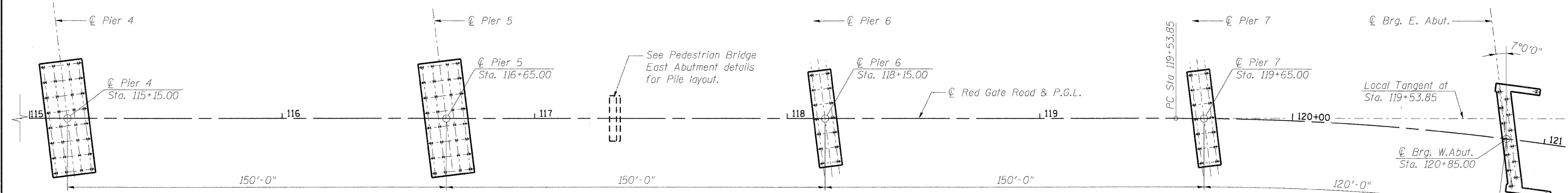

**FOUNDATION PLAN - SPANS 5-8**

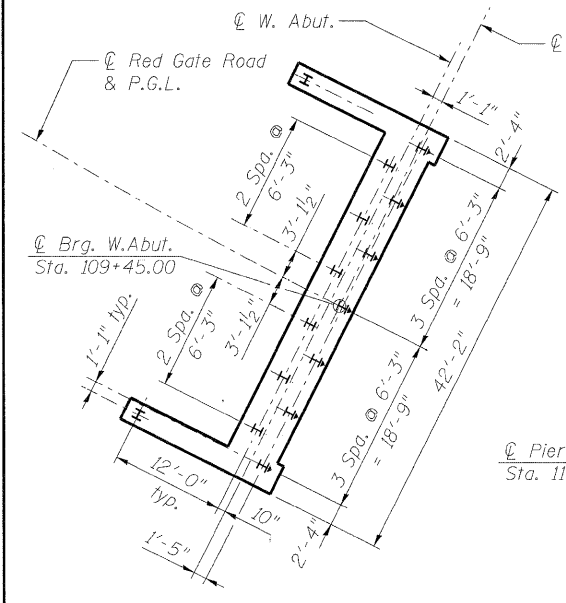

**PILE LAYOUT - WEST ABUTMENT**

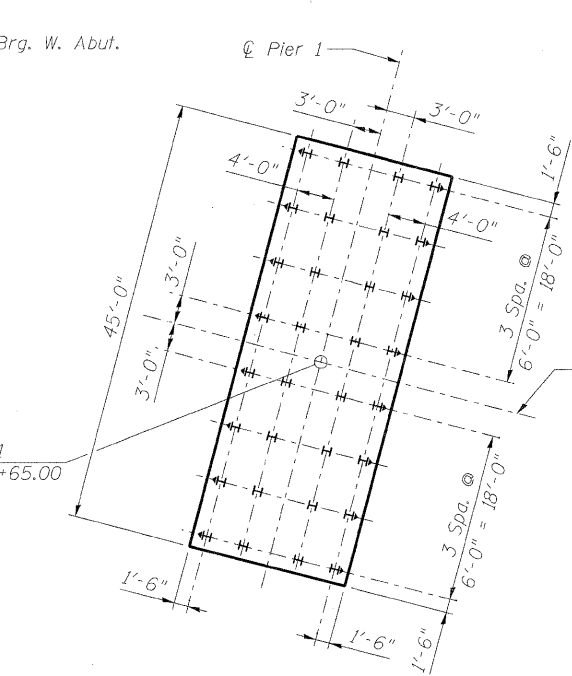

**PILE LAYOUT - PIER 1**

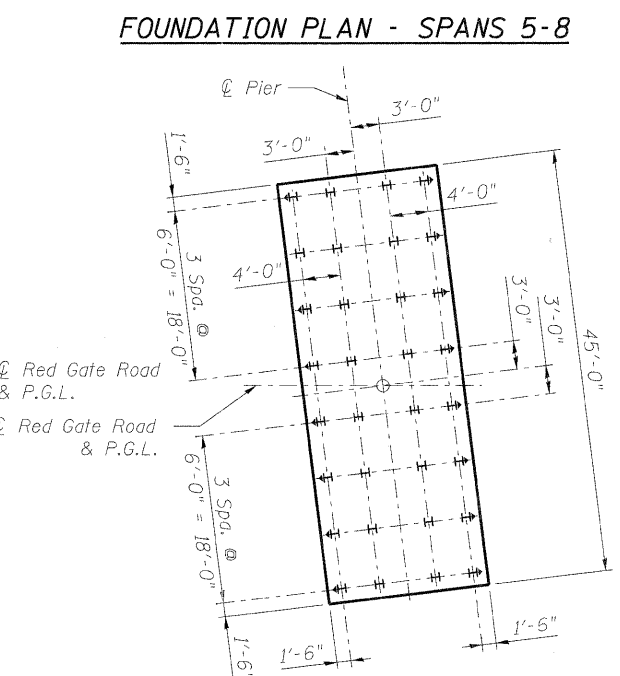

**PILE LAYOUT - PIERS 2 THRU 5**

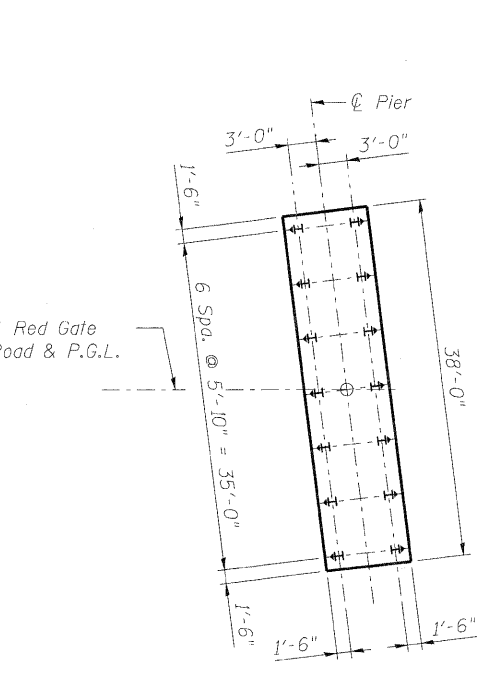

**PILE LAYOUT - PIERS 6 AND 7**

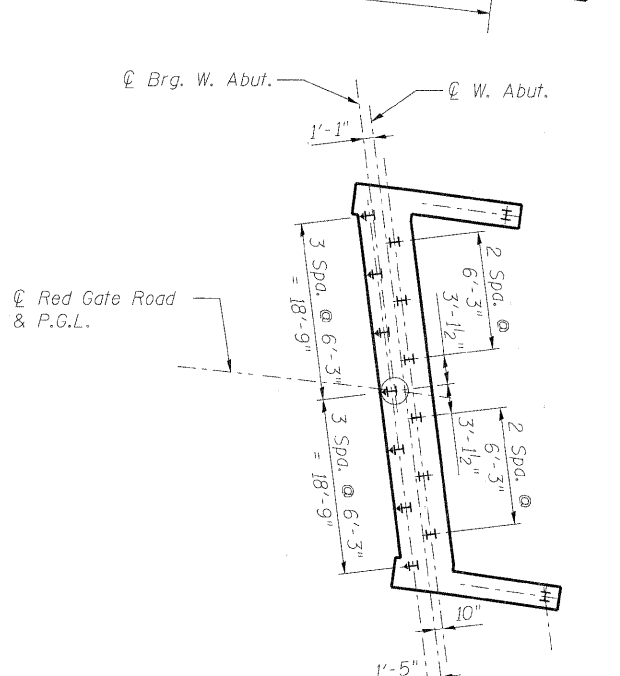

**PILE LAYOUT - EAST ABUTMENT**

See sheet S39 for work points at East Abutment

**benesch**  
engineers · scientists · planners

Alfred Benesch & Company  
205 North Michigan Avenue, Suite 2400  
Chicago, Illinois 60601  
312-565-0450 Job No. 10092

FILE NAME =	USER NAME = akeaschal	DESIGNED = MFH	REVISED =
0456024_003.Foundation.dgn		CHECKED = AJK	REVISED =
	PLOT SCALE =	DRAWN = RMG	REVISED =
	PLOT DATE = 11/9/2011	CHECKED = AJK	REVISED =



**CITY OF ST. CHARLES**

**FOUNDATION LAYOUT**  
**STRUCTURE NO. 045-6024 RED GATE ROAD OVER THE FOX RIVER**  
SHEET NO. S3 OF S56 SHEETS

F.A.I. RTE.	SECTION	COUNTY	TOTAL SHEETS	SHEET NO.
	04-00092-00-BR	KANE	440	225
			CONTRACT NO. 63650	
ILLINOIS FED. AID PROJECT				

x:\10000s\10092\engineering\_documents\_redgatephase1\groverfoxriver\final\plans\0456024\_003.Foundation.dgn 5:01:40 PM 11/9/2011