

NOTES:

1. Work this sheet with sheet S16.
2. a10(E) and a11(E) bar spacings measured along ϕ Red Gate Road.
3. Transverse dimensions measured radially.
4. See Sheets S37 thru S40 for dimensions between end of approach slab and abutment backwall.

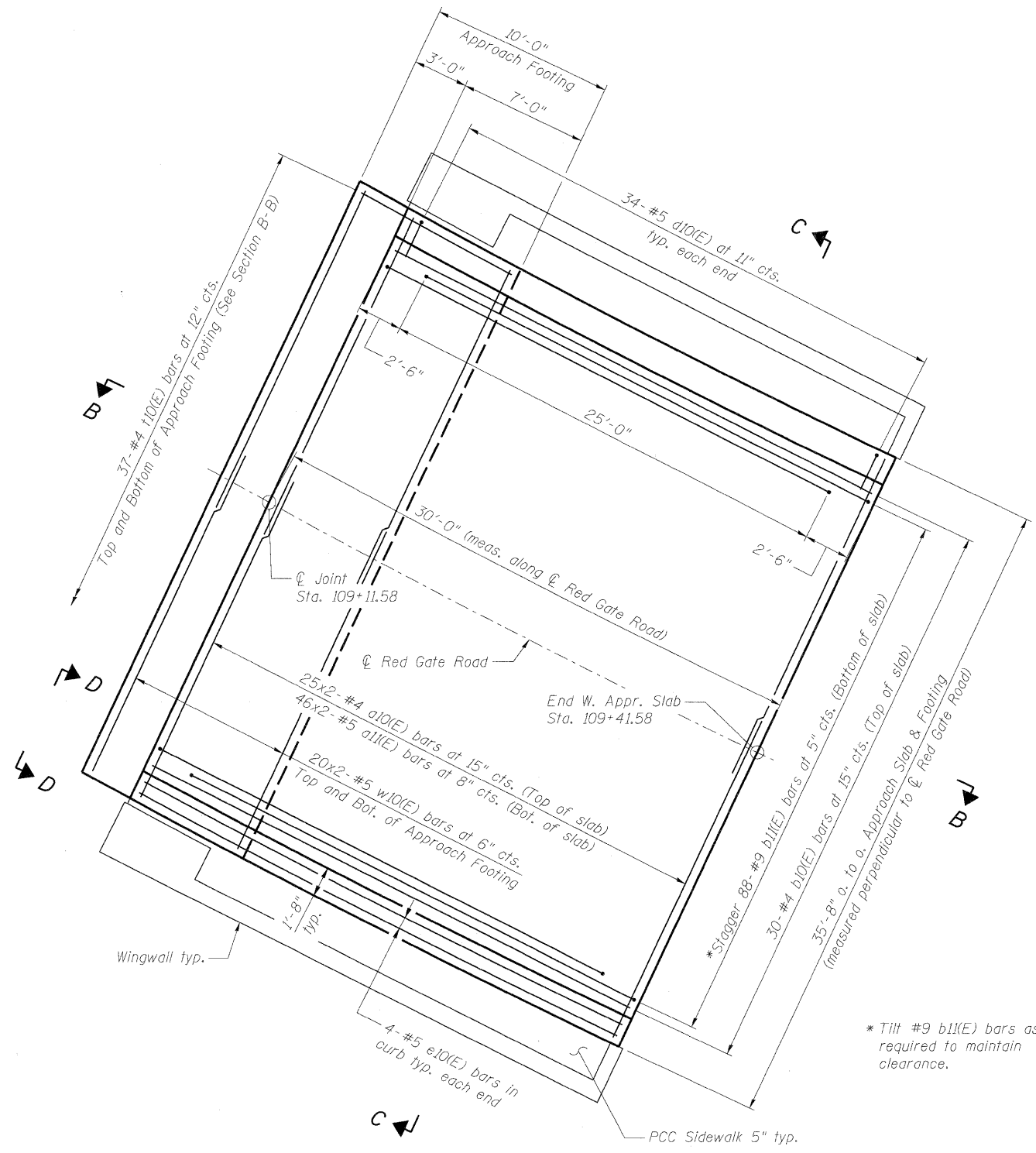

PLAN - WEST APPROACH SLAB

MINIMUM BAR LAP

#4 bar = 2'-7"
#5 bar = 3'-3"

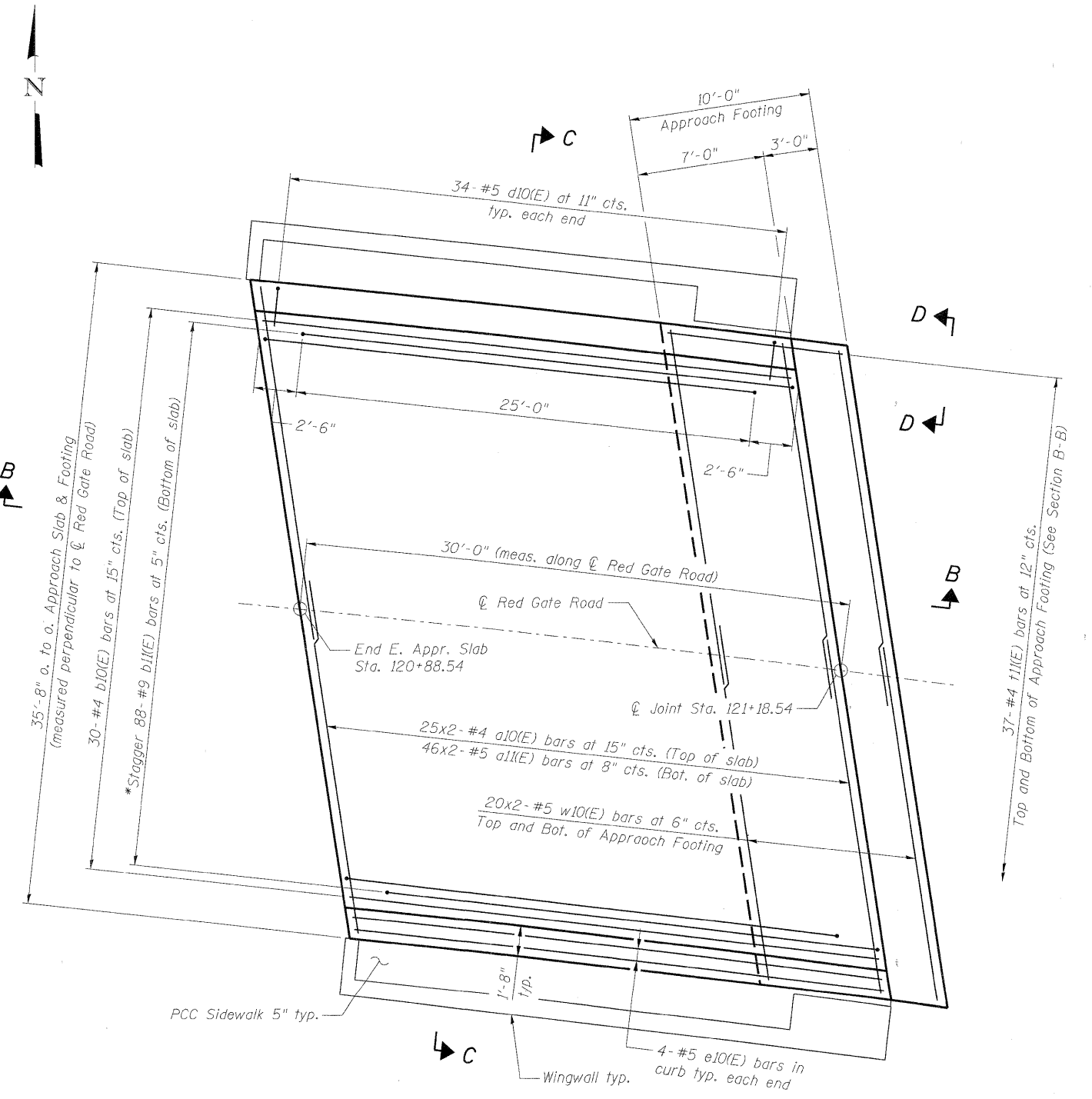

PLAN - EAST APPROACH SLAB

benesch
engineers · scientists · planners
Alfred Benesch & Company
205 North Michigan Avenue, Suite 2400
Chicago, Illinois 60601
312-565-0450 Job No. 10082

FILE NAME =	USER NAME = akaschell	DESIGNED - MFH	REVISED -
0456024_015_Appr1.dgn		CHECKED - AJK	REVISED -
	PLOT SCALE =	DRAWN - RMG	REVISED -
	PLOT DATE = 11/9/2011	CHECKED - AJK	REVISED -



CITY OF ST. CHARLES

BRIDGE APPROACH SLAB PLAN
STRUCTURE NO. 045-6024 RED GATE ROAD OVER THE FOX RIVER

SHEET NO. S15 OF S56 SHEETS

F.A.I. RTE.	SECTION	COUNTY	TOTAL SHEETS	SHEET NO.
	04-00092-00-BR	KANE	440	237
				CONTRACT NO. 63650
ILLINOIS FED. AID PROJECT				

x:\10000s\10092\engineering-documents\redgatephase1\rgroverfoxriver\final\plans\0456024_015_Appr1.dgn 5:02:42 PM 11/9/2011