

DATE: _____ BY: _____
 SURVEYED: _____ CHECKED: _____
 PLAN: _____ CHECKED: _____
 NOTE BOOK: _____
 NO. _____
 DATE: _____ BY: _____
 SURVEYED: _____ CHECKED: _____
 PROFILE: _____ CHECKED: _____
 NOTE BOOK: _____
 NO. _____

CHRISTOPHER B. BURKE ENGINEERING LTD.
 9575 West Higgins Road, Suite 600
 Rosemont, Illinois 60018
 (847) 823-6500

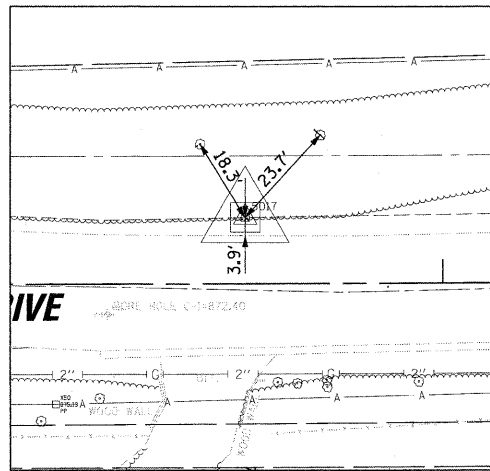

C.P. 5017

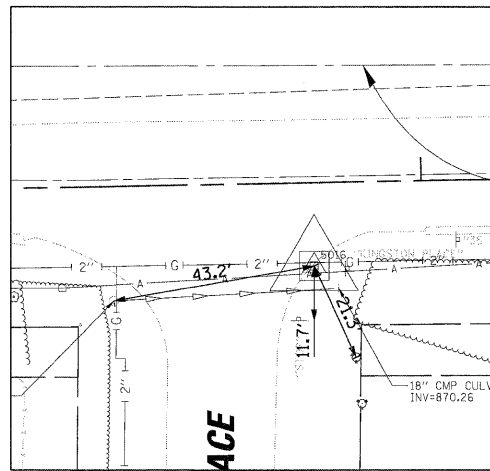

C.P. 5016

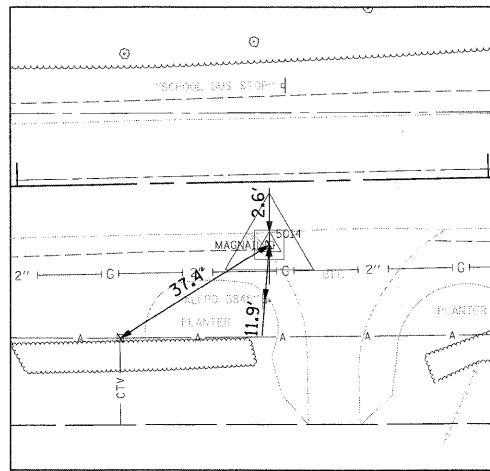

C.P. 5014

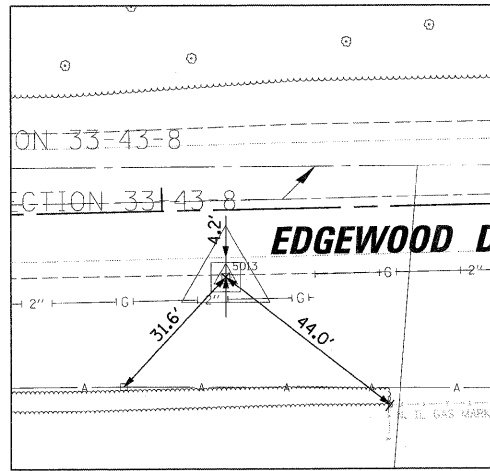

C.P. 5013

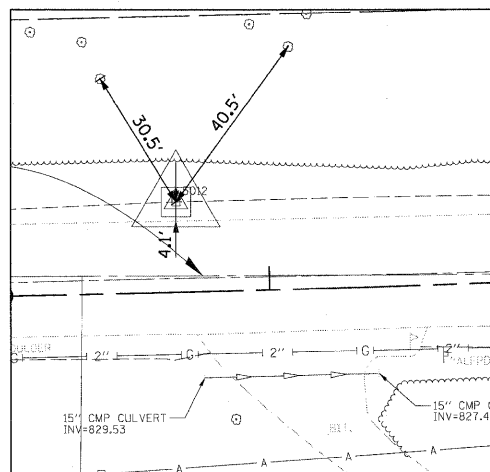

C.P. 5012

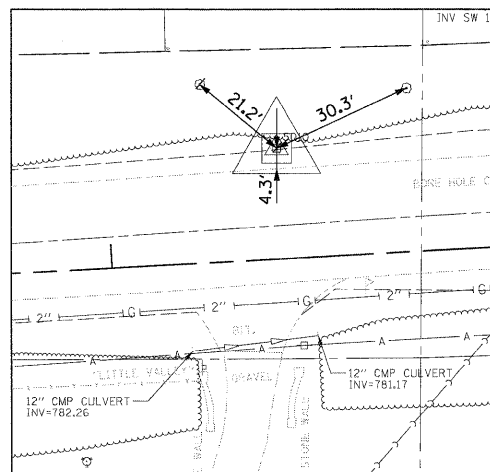

C.P. 5010

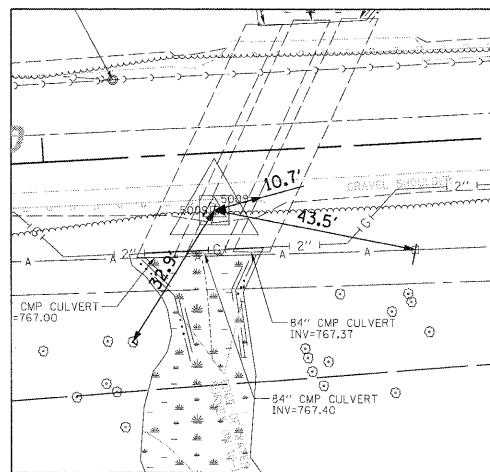

C.P. 5009

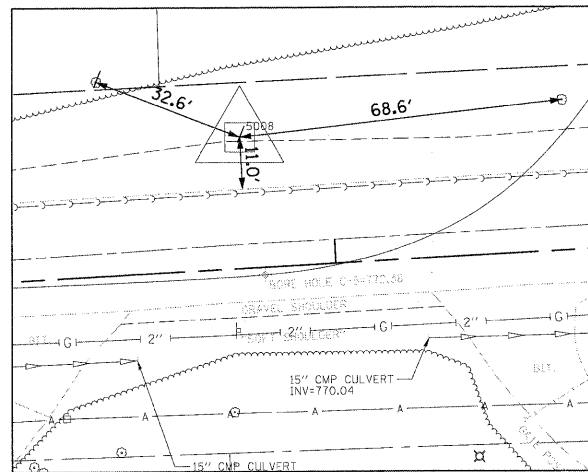

C.P. 5008

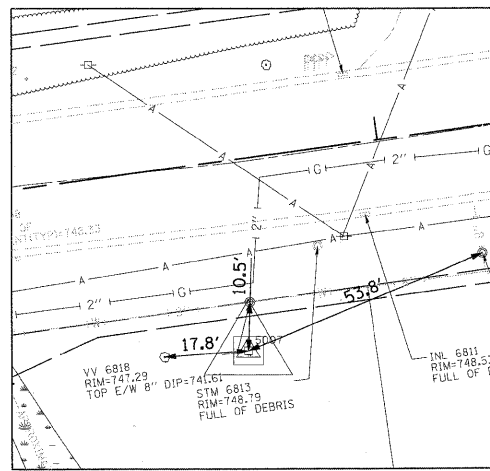

C.P. 5007

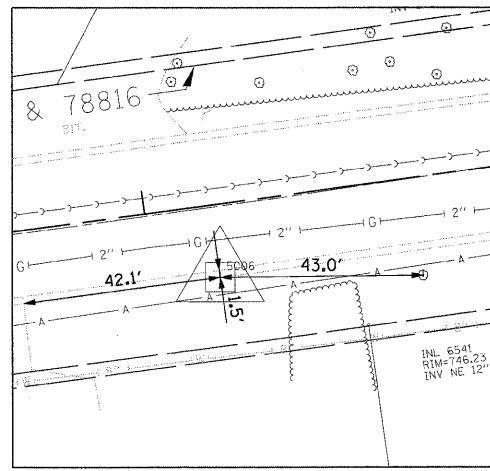

C.P. 5006

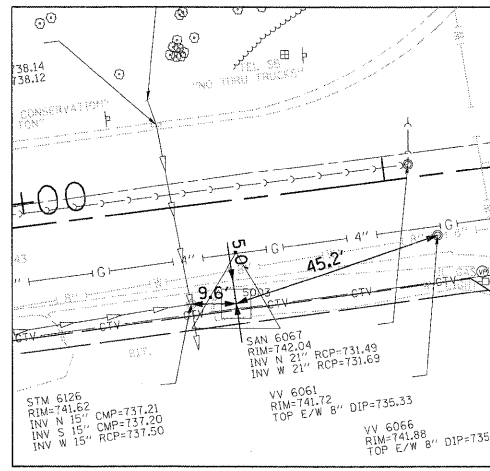

C.P. 5003

HORIZONTAL CONTROL POINTS					
CP#	NORTHING	EASTING	DESCRIPTION	STATION	OFFSET
5017	2000079.87	989208.87	SET REBAR	102+58.08	14.11 LT
5016	2000051.83	989628.12	SET REBAR	106+76.96	17.70 RT
5014	2000069.03	990304.18	SET 60D NAIL	113+53.23	13.42 RT
5013	2000075.02	990664.12	SET REBAR	117+13.22	14.30 RT
5012	2000115.56	991030.68	SET REBAR	120+80.59	19.14 LT
5010	2000146.42	991584.92	SET REBAR	126+36.29	23.42 LT
5009	2000127.15	991885.79	SET REBAR	129+35.68	12.04 RT
5008	2000190.86	992328.46	SET REBAR	133+81.14	27.72 LT
5007	2000172.94	993119.09	SET REBAR	141+66.82	40.78 RT
5006	2000231.47	993360.63	X CUT	144+14.06	15.43 RT
5003	2000306.94	994007.45	SET 60D NAIL	150+65.37	22.02 RT

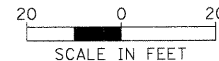

FILE NAME = N:\ALGONGQUIN\078273.00026\Civil\BNH\078273_3.SHT	USER NAME = mworman	DESIGNED -	REVISED -	STATE OF ILLINOIS DEPARTMENT OF TRANSPORTATION	EDGEWOOD DRIVE IMPROVEMENTS ALIGNMENTS, TIES AND BENCHMARK	F.A.U. RTE. 4010	SECTION 09-00078-00-WR	COUNTY McHENRY	TOTAL SHEETS 128	SHEET NO. 11
PLOT SCALE = 20'	CHECKED -	REVISED -	SCALE:			SHEET NO. OF SHEETS STA. TO STA.	CONTRACT NO. 63655	ILLINOIS FED. AID PROJECT		
PLOT DATE = 11/15/2011	DATE	REVISED -								