

PROFILE SURVEYED BY DATE  
 NOTE BOOK NO. DATE  
 STRUCTURE NOTATION CHECKED  
 PLAN SURVEYED BY DATE  
 NOTE BOOK NO. DATE  
 CHECKED BY DATE  
 NO. DATE

**CHRISTOPHER B. BURKE ENGINEERING LTD.**  
 3575 West Higgins Road, Suite 600  
 Rosemont, Illinois 60018  
 (847) 823-0500

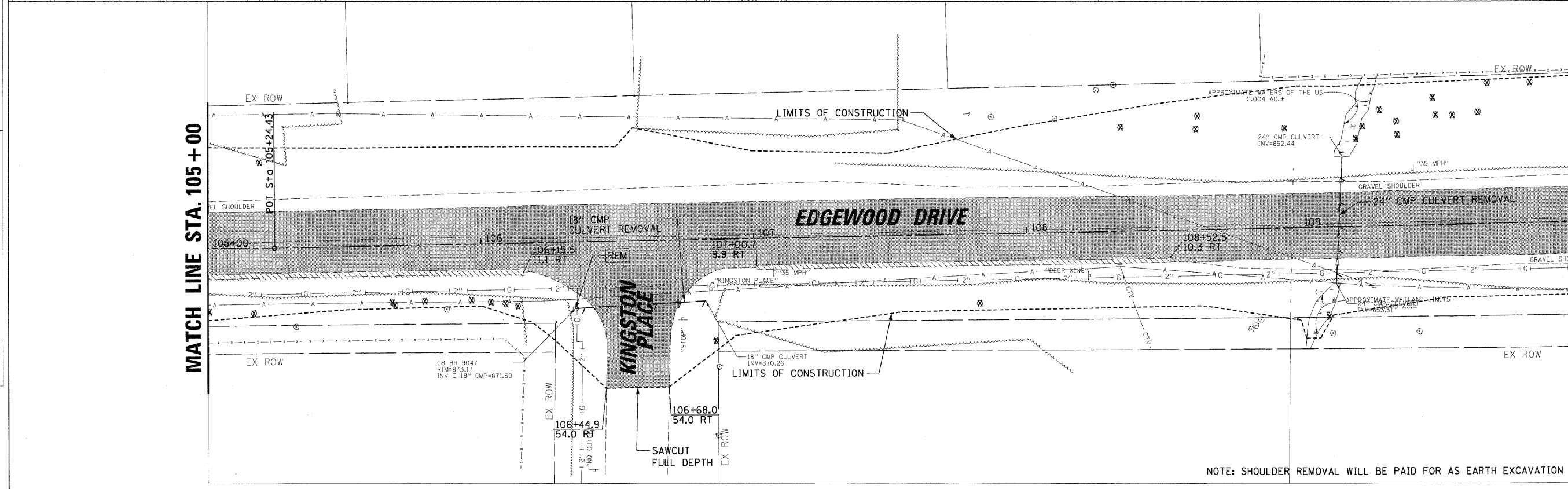
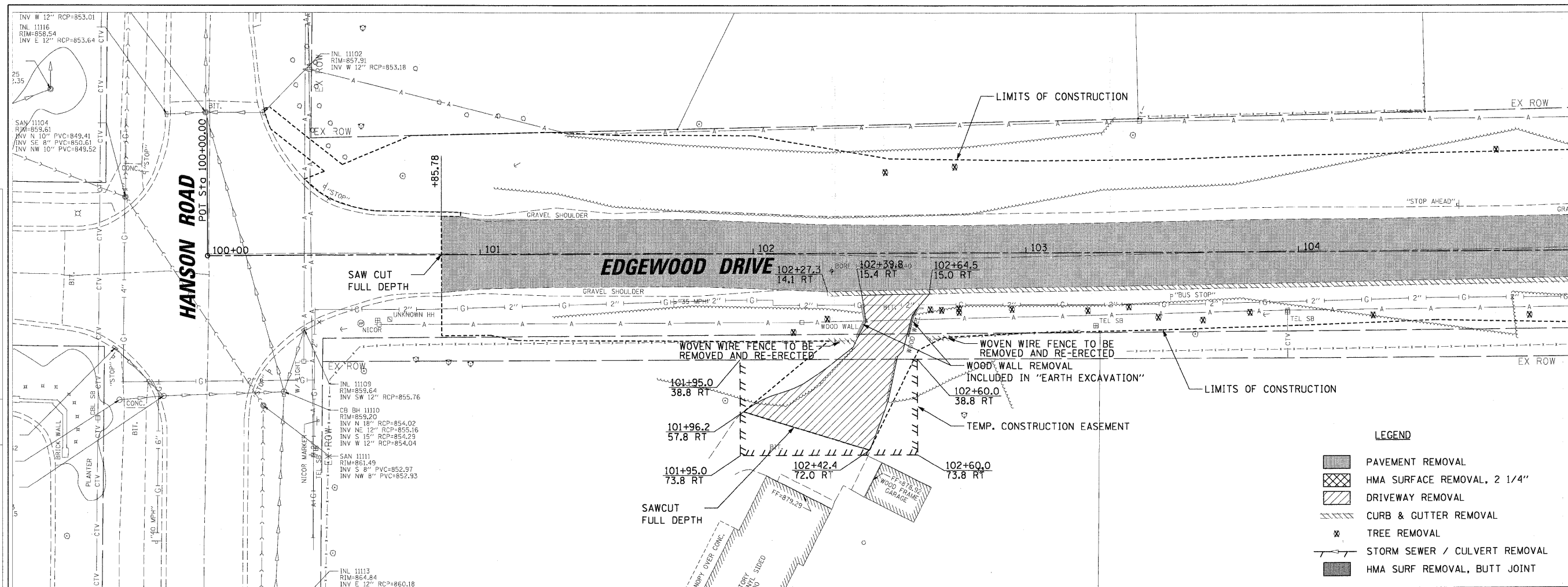

MATCH LINE STA. 105+00

MATCH LINE STA. 110+00

- LEGEND**
- PAVEMENT REMOVAL
  - HMA SURFACE REMOVAL, 2 1/4"
  - DRIVEWAY REMOVAL
  - CURB & GUTTER REMOVAL
  - TREE REMOVAL
  - STORM SEWER / CULVERT REMOVAL
  - HMA SURF REMOVAL, BUTT JOINT

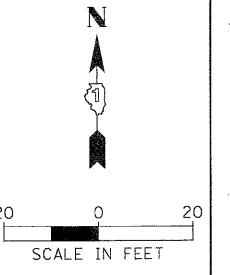

NOTE: SHOULDER REMOVAL WILL BE PAID FOR AS EARTH EXCAVATION

FILE NAME = N:\ALDONGUIN\070273.00026\civ1\REM_070273.LSHT	USER NAME = sworman	DESIGNED -	REVISED -	<b>STATE OF ILLINOIS DEPARTMENT OF TRANSPORTATION</b>	<b>EDGEWOOD DRIVE IMPROVEMENTS EXISTING CONDITIONS AND REMOVAL PLANS</b>	F.A.JJ RTE. 4010	SECTION 09-00078-00-WR	COUNTY McHENRY	TOTAL SHEETS 128	SHEET NO. 16		
PLOT SCALE = 20'	DATE = 11/15/2011	DRAWN -	REVISED -			SCALE:	SHEET NO. OF SHEETS STA. TO STA.	CONTRACT NO. 63655				
		CHECKED -	REVISED -			ILLINOIS FED. AID PROJECT						
		DATE -	REVISED -									