

PROFILE SURVEYED, DATE: \_\_\_\_\_ BY: \_\_\_\_\_  
 CHECKED, DATE: \_\_\_\_\_ BY: \_\_\_\_\_  
 B.M. NOTED, DATE: \_\_\_\_\_ BY: \_\_\_\_\_  
 STRUCTURE NOTATIONS CHFD  
 PLAN SURVEYED, DATE: \_\_\_\_\_ BY: \_\_\_\_\_  
 CHECKED, DATE: \_\_\_\_\_ BY: \_\_\_\_\_  
 RT. OF WAY CHECKED, DATE: \_\_\_\_\_ BY: \_\_\_\_\_  
 NO. \_\_\_\_\_ DATE FILE NAME: \_\_\_\_\_

**CHRISTOPHER B. BURKE ENGINEERING LTD.**  
 9575 West Higgins Road, Suite 600  
 Rosemont, Illinois 60018  
 (847) 825-0500

MATCH LINE STA. 110+00

MATCH LINE STA. 115+00

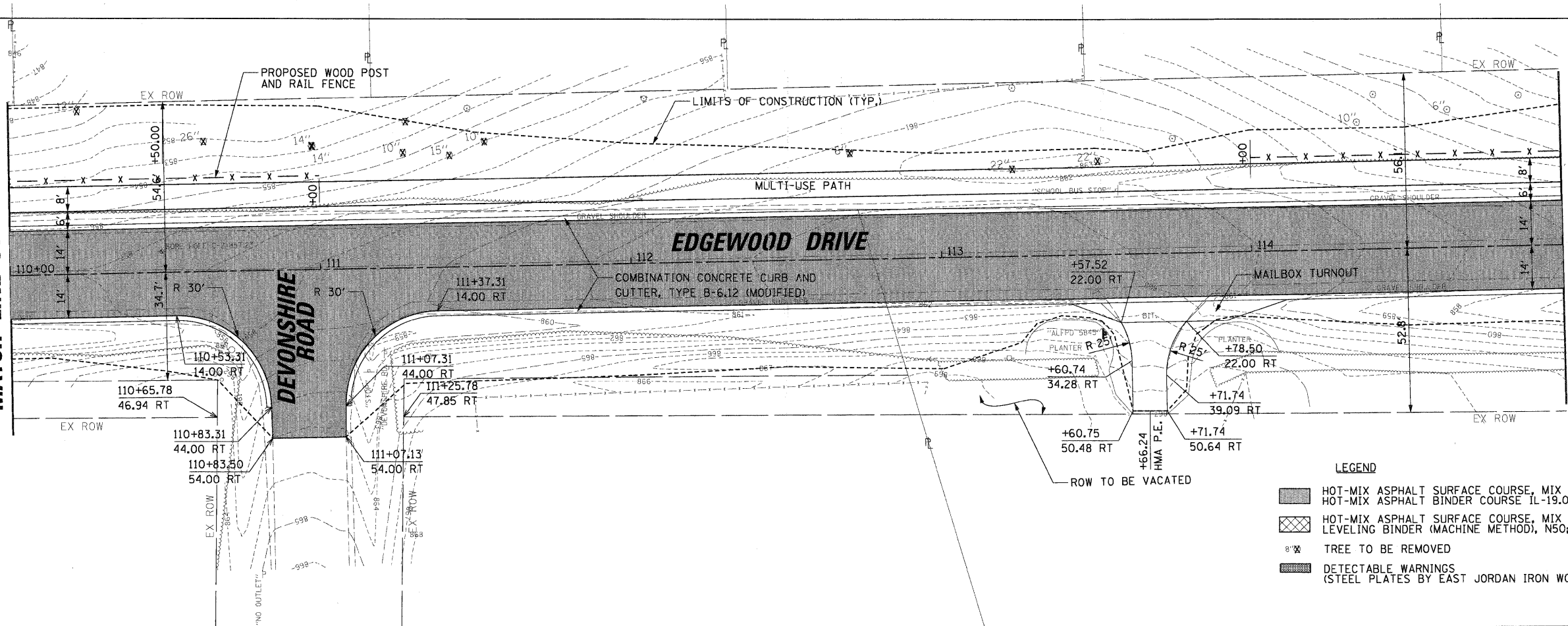

- LEGEND**
- HOT-MIX ASPHALT SURFACE COURSE, MIX D N50; 2 IN
  - HOT-MIX ASPHALT BINDER COURSE 1L-19.0, N50; 6 1/4 IN
  - HOT-MIX ASPHALT SURFACE COURSE, MIX D N50; 1 1/2 IN LEVELING BINDER (MACHINE METHOD), N50; 3/4 IN (MIN)
  - TREE TO BE REMOVED
  - DETECTABLE WARNINGS (STEEL PLATES BY EAST JORDAN IRON WORKS OR APPROVED EQUAL)

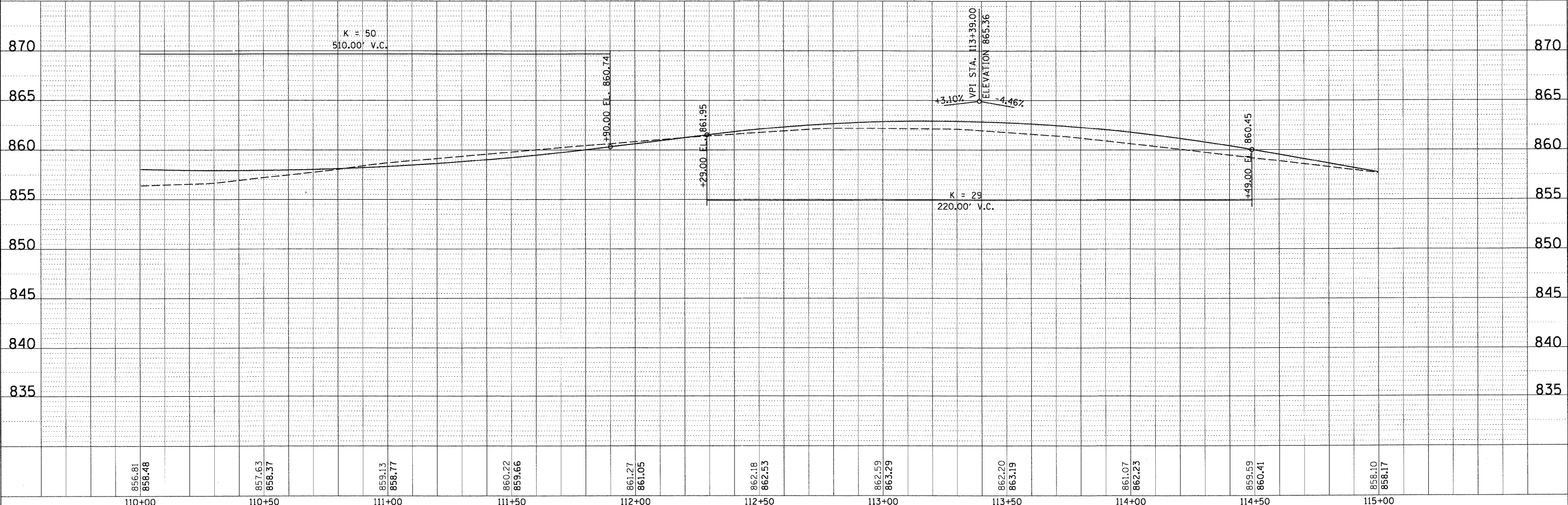

856.81 858.48	857.63 858.57	859.13 858.77	860.22 859.66	861.27 861.05	862.18 862.53	862.59 863.29	862.20 863.19	861.07 862.23	859.59 860.41	858.10 858.17
110+00	110+50	111+00	111+50	112+00	112+50	113+00	113+50	114+00	114+50	115+00

FILE NAME = N:\ALGONDQUIN\070273.00026\Civil\VRPP\_070273\_3.SHT  
 USER NAME = morman  
 DESIGNED -  
 DRAWN -  
 CHECKED -  
 PLOT DATE = 11/15/2011

REVISIONS:  
 REVISION -  
 REVISION -  
 REVISION -  
 DATE -

**STATE OF ILLINOIS**  
**DEPARTMENT OF TRANSPORTATION**

**EDGEWOOD DRIVE IMPROVEMENTS**  
**ROADWAY PLAN AND PROFILE**  
**STA. 110+00 TO 115+00**

F.A. RTE. 4010	SECTION 09-00078-00-WR	COUNTY McHENRY	TOTAL SHEETS 128	SHEET NO. 24
CONTRACT NO. 63655			ILLINOIS FED. AID PROJECT	

SCALE: SHEET NO. OF SHEETS STA. TO STA.