

SURVEYED BY: DATE: \_\_\_\_\_  
 PLOTTED BY: DATE: \_\_\_\_\_  
 CHECKED BY: DATE: \_\_\_\_\_  
 NOTE BOOK NO.: \_\_\_\_\_  
 STRUCTURE NOTATIONS: CKFD  
 FILE NAME: \_\_\_\_\_  
 USER NAME: morman  
 DESIGNED: \_\_\_\_\_  
 DRAWN: \_\_\_\_\_  
 CHECKED: \_\_\_\_\_  
 DATE: \_\_\_\_\_  
 REVISIONS: \_\_\_\_\_  
 REVISIONS: \_\_\_\_\_  
 REVISIONS: \_\_\_\_\_  
 REVISIONS: \_\_\_\_\_

**CHRISTOPHER B. BURKE** ENGINEERING LTD.  
 9575 West Higgins Road, Suite 600  
 Rosemont, Illinois 60018  
 (847) 823-0500

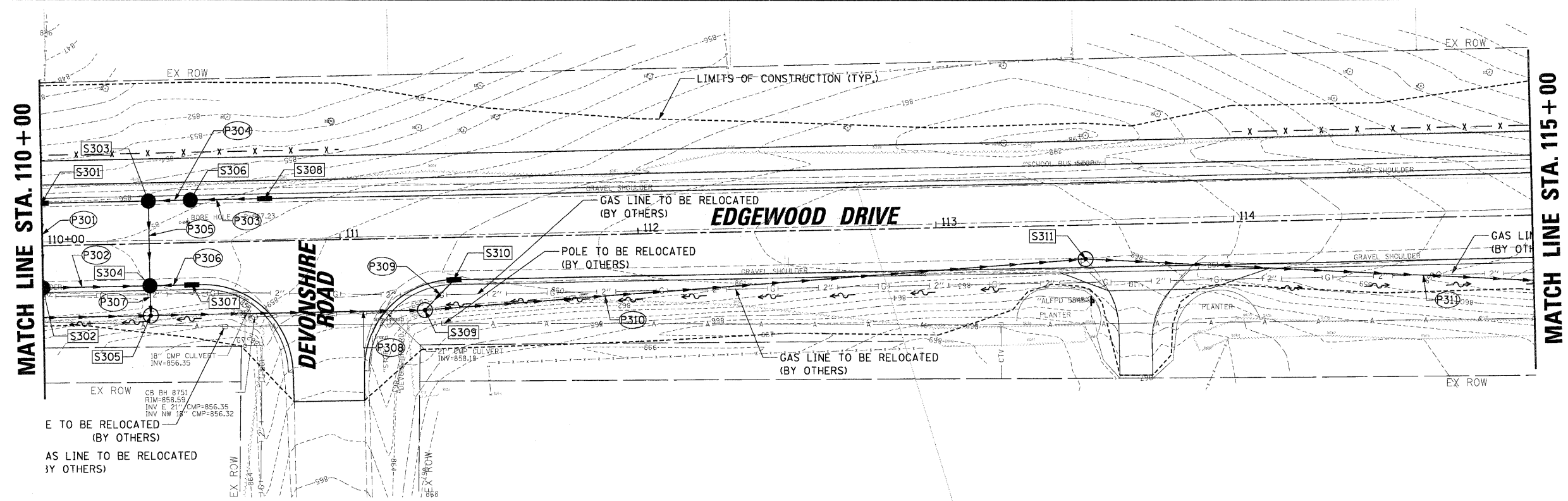

NO.	STRUCTURE	FRAME TYPE	STATION	OFFSET	RIM ELEVATION	INVERT ELEVATIONS			
						N	S	E	W
S301	INL TA	7010-T1-M4	110+00	14' LT	858.2		854.35		
S302	CB TA 4'	7010-T1-M4	110+00	14' RT	858.2	854.18		854.08	854.18
S303	CB TA 4'	7010-T1-M4	110+35.9	14' LT	858.07		853.95	854.05	
S304	CB TA 4'	7010-T1-M4	110+35.9	14' RT	858.07	853.78		854.16	853.86
S305	MH TA 5'	1050-Z1-CL	110+36	24' RT	857.21	853.14		852.62	853.12
S306	CB TA 4'	7010-T1-M4	110+50	14' LT	858.09			854.23	854.13
S307	INL TA	7010-T1-M4	110+50	14' RT	858.09				854.24
S308	INL TA	7010-T1-M4	110+75	14' LT	858.23				854.38
S309	MH TA 5'	6508	111+28	24' RT	858.4	852.26		852.26	852.36
S310	INL TA	7010-T1-M4	111+38	14' RT	859.12		855.27		
S311	MH TA 5'	1050-Z1-CL	113+50	10' RT	862.99			851.29	851.39

NO	UPSTREAM STRUCTURE	DOWNSTREAM STRUCTURE	LENGTH (FEET)	SIZE (INCHES)	TYPE	SLOPE (%)	UPSTREAM INVERT	DOWNSTREAM INVERT	TRENCH BACKFILL (CU. YD.)
P301	S301	S302	25	12	2	0.70%	854.35	854.18	4.4
P302	S302	S304	32	12	2	0.70%	854.08	853.86	6.4
P303	S308	S306	22	12	2	0.70%	854.38	854.23	3.7
P304	S306	S303	12	12	2	0.70%	854.13	854.05	2.2
P305	S303	S304	24	12	2	0.70%	853.95	853.78	4.9
P306	S307	S304	11	12	2	0.70%	854.24	854.16	1.9
P307	S304	S305	6	18	2	0.70%	853.18	853.14	1.4
P308	S305	S309	87	30	2	0.30%	852.62	852.36	27.4
P309	S310	S309	11	12	1	0.70%	855.27	855.19	2.2
P310	S309	S311	217	30	2	0.40%	852.26	851.39	153.5
P311	S311	S401	174	30	2	0.40%	851.29	850.60	108.5

