

SURVEYED BY: _____ DATE: _____
 PLOTTED BY: _____
 CHECKED BY: _____
 NOTE BOOK NO. _____
 STRUCTURE NOTATION: _____
 SURVEYED BY: _____ DATE: _____
 PLOTTED BY: _____
 CHECKED BY: _____
 NOTE BOOK NO. _____
 STRUCTURE NOTATION: _____

CHRISTOPHER B. BURKE ENGINEERING LTD.
 9575 West Higgins Road, Suite 600
 Rosemont, Illinois 60018
 (847) 823-0500

MATCH LINE STA. 135+00

MATCH LINE STA. 140+00

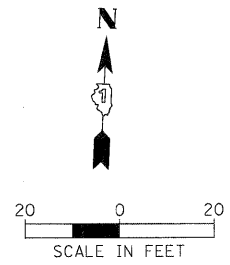
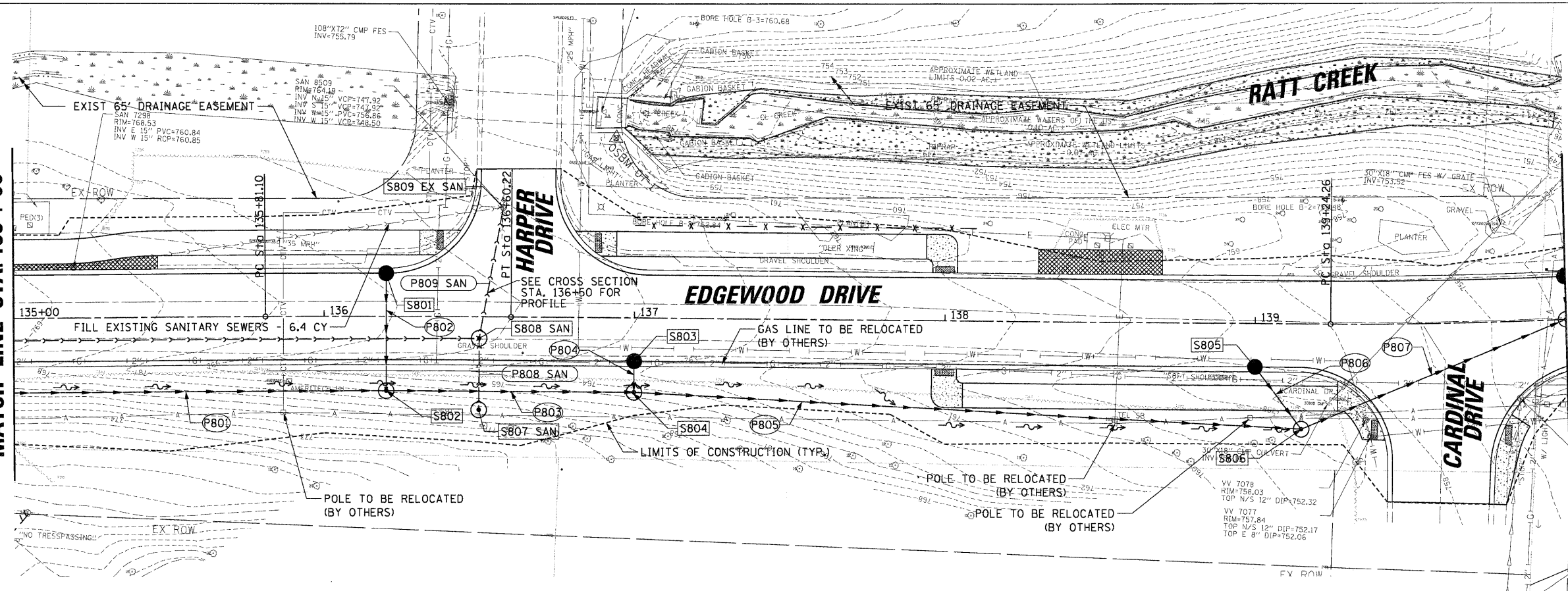

NO	UPSTREAM STRUCTURE	DOWNSTREAM STRUCTURE	LENGTH (FEET)	SIZE (INCHES)	TYPE	SLOPE (%)	UPSTREAM INVERT	DOWNSTREAM INVERT	TRENCH BACKFILL (CU. YD.)
P801	S707	S802	151	18	2	2.93%	765.35	760.93	
P802	S801	S802	35	12	2	0.70%	761.76	761.52	9.5
P803	S802	S804	75	18	2	2.38%	760.83	759.04	
P804	S803	S804	3	12	1	0.70%	759.39	759.34	0.7
P805	S804	S806	209	48	3	0.30%	748.70	748.07	265.3
P806	S805	S806	21	12	2	0.70%	753.46	753.31	4.1
P807	S806	S902	87	24	2	2.00%	747.97	746.23	108.9
P808 SAN	S807 SAN	S808 SAN	19	8		1.47%	751.82	751.54	23.2
P809 SAN	S808 SAN	S809 EX SAN	39	8		8.72%	751.42	748.02	76.7

NO.	STRUCTURE	FRAME TYPE	STATION	OFFSET	RIM ELEVATION	INVERT ELEVATIONS		
						N	S	E
S801	CB TA 4'	7010-T1-M4	136+20	14' LT	765.61		761.76	
S802	MH TA 4'	6508	136+20	24' RT	766.05	761.52	760.83	760.93
S803	CB TA 4'	7010-T1-M4	137+00	14' RT	763.24		759.39	
S804	MH TA 6'	6508	137+00	24' RT	763.2	759.34	748.70	759.04
S805	CB TA 4'	7010-T1-M4	139+00	14' RT	757.31		753.46	
S806	MH TA 6' (RESTRICTOR)	6508 & 1050-Z1-CL	139+15	33.83' RT	756.36	753.31	747.97	748.07
S807 SAN	MH TA 4' (SAN)	1050-Z1-CL	136+50	30' RT	767.55		751.82	
S808 SAN	MH TA 4' (SAN)	1050-Z1-CL	138+50	7' RT	764.85		751.42	751.54
S809 EX SAN	EXISTING	NA	136+57.5	35.4' LT	764.11	747.92(EX)	748.02	748.50(EX)

