

STATE OF ILLINOIS
DEPARTMENT OF TRANSPORTATION

GENERAL NOTES

- All work and materials shall be in accordance with the Illinois Department of Transportation (IDOT) Standard Specifications for Road and Bridge Construction adopted January 1, 2007 and latest supplemental specifications and recurring special provisions, unless noted otherwise.
- The Contractor shall verify all dimensions in the field prior to commencing work. The engineer shall be notified of any discrepancies which may exist prior to proceeding with the work.
- Any information concerning type or location of underground and other utilities is not guaranteed to be accurate or all inclusive. The Contractor is responsible for making his own determinations as to the type and location of the utilities as may be necessary to avoid damage thereto. Contractor shall call J.U.L.I.E. prior to excavation.
- The contractor is responsible for design, installation and removal of all excavation support systems.
- The excavation and work area shall be properly drained at all times during construction. All wet, loose, frozen or other unsuitable material shall be removed prior to placement of concrete or compacted backfill. The cost of any pumping required shall be included in the cost of "Concrete Structures".
- Foundation design is based on soil information provided in Testing Service Corporation Report 73,706. Contractor shall have a geotechnical engineer to field verify the allowable bearing capacity under the retaining wall exceeds 3000 psf. Cost included in "Concrete Structures".
- It shall be the responsibility of the Contractor to divert the stream flow during construction in order to keep the construction areas free of water. The method of water diversion shall be subject to the approval of the Engineer and cost shall be included with "Concrete Structures".
- All removal or excavation items being disposed of at an uncontaminated soil fill operation or clean construction and demolition debris (CCDD) fill site shall meet the requirements of Public Act 96-1416. All costs associated with meeting these requirements shall be included in the unit price cost for the associated removal or excavation items in the contract. These costs shall include but are not limited to all required testing, lab analysis, certification by a licensed professional engineer, and state or local tipping fees.
- The exposed face of the proposed retaining wall and north culvert headwall shall have a form liner textured surface. The pattern shall be Spec Formliners, Inc. Pattern #1548 - Chester Drystack or an approved equal. A 4" smooth border shall be added to the top of the wall and at all joints.
- The color of the form liner shall be approved by the Village. Cost included in "Form Liner Textured Surface".

CAST-IN-PLACE CONCRETE NOTES

- All cast-in-place concrete work shall be in accordance with section 503 of the Illinois Department of Transportation (IDOT) Standard Specifications for Road and Bridge Construction adopted January 1, 2007, supplemental specifications and recurring special provisions and as noted below.
- Reinforcement bars shall conform to the requirements of ASTM A 706 GR60.
- Exposed edges of cast-in-place concrete shall be beveled $\frac{3}{4}$ ".
- All construction joints shall be bonded.
- Concrete mix designs shall be submitted to the Engineer for review and approval a minimum of 7 days prior to ordering or placing concrete.
- Cover from the face of concrete to face of reinforcement bars shall be 3" for surfaces cast against earth and 2" for all other surfaces unless otherwise noted.

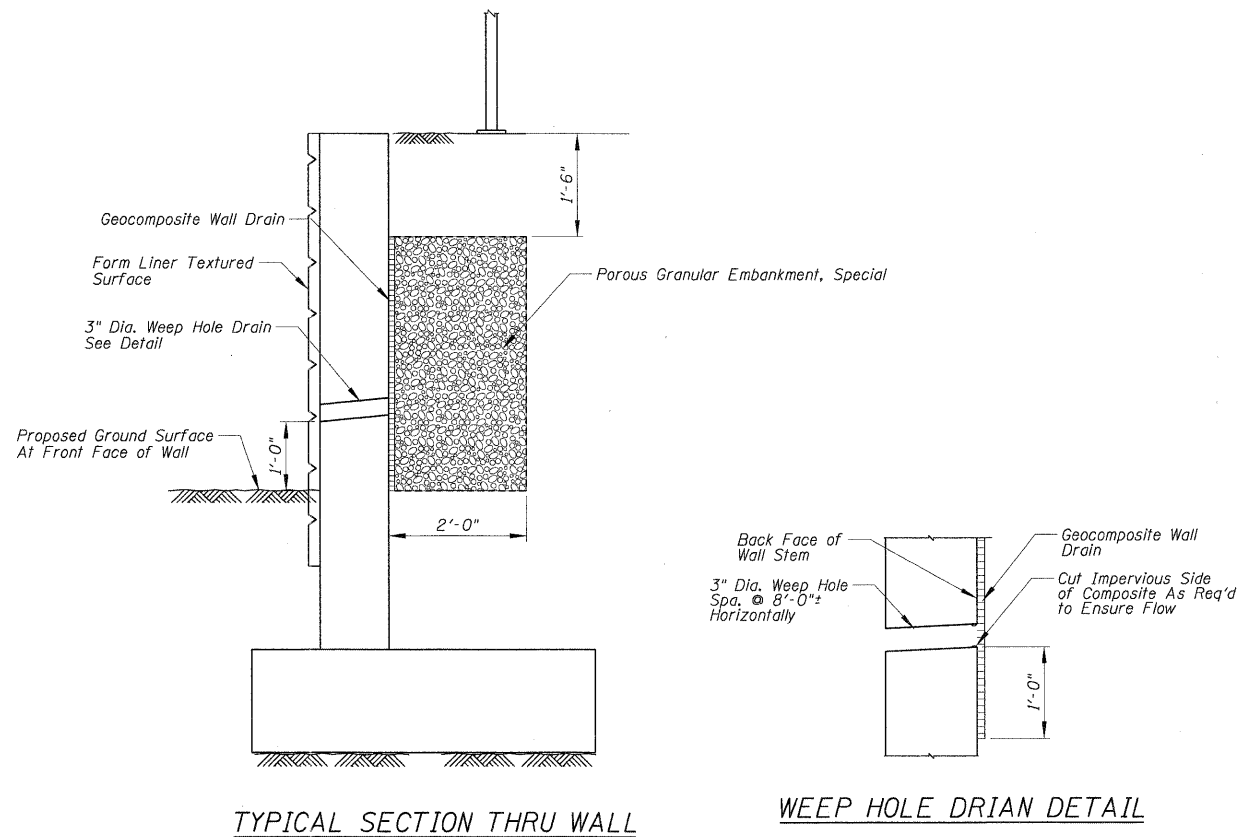

GENERAL NOTES

EDGEWOOD DRIVE OVER
RATT CREEK TRIBUTARY
F.A.U. RTE. 4010
SECTION 09-00078-00-WR
MCHENRY COUNTY

STA. 129+00.00 TO STA. 134+00.00

DESIGNED -	200
CHECKED -	EXAMINED
DRAWN -	PASSED
CHECKED -	

ENGINEER OF BRIDGE DESIGN
ENGINEER OF BRIDGES AND STRUCTURES

SHEET NO.	F.A. RTE.	SECTION	COUNTY	TOTAL SHEETS	SHEET NO.
S-7	4010	09-00078-00-WR	MCHENRY	128	86
CONTRACT NO. 63655					
FED. ROAD DIST. NO.		ILLINOIS	FED. AID PROJECT		