

PROFILE	REVIEWED	DATE	BY	PLAN	REVIEWED	DATE	BY
NOTE BOOK	GRADES CHECKED			NOTE BOOK	ALIGNMENT CHECKED		
NO.	STRUCTURE NOTATIONS CHECKED			NO.	ROAD FILE NAME		

CHRISTOPHER B. BURKE ENGINEERING LTD.
 3151 N. W. 10th St.
 Rosemont, Illinois 60018
 (847) 823-0500

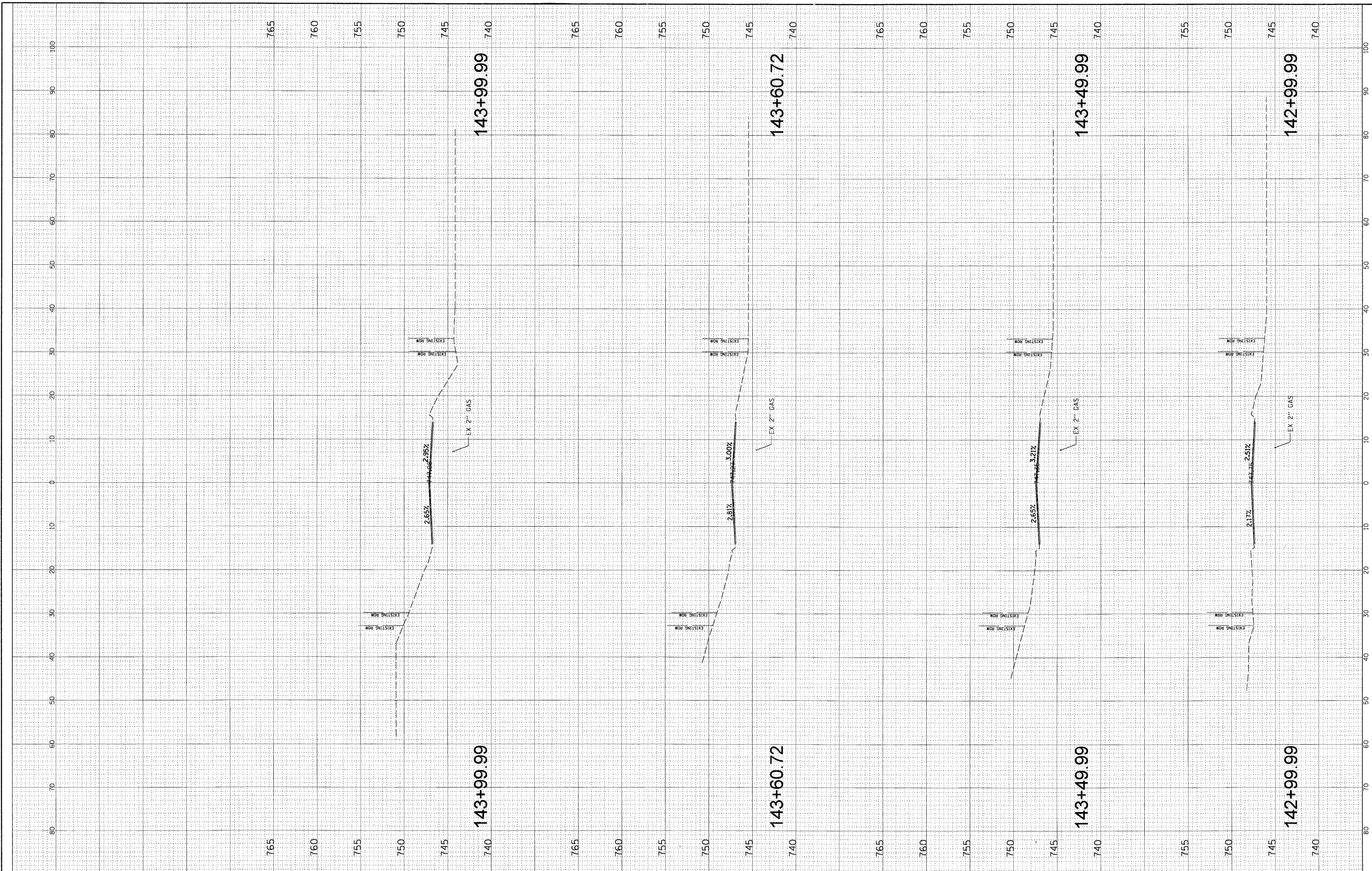

FILE NAME = N:\ALCONQUIN\07273.0026\Civil\XS_07273	USER NAME = morman	DESIGNED - ABR	REVISED -	STATE OF ILLINOIS DEPARTMENT OF TRANSPORTATION	EDGEWOOD ROAD			F.A.P. RTE. 4010	SECTION 09-0078-00-WR	COUNTY McHENRY	TOTAL SHEETS 128	SHEET NO. 124
	PLOT SCALE = 10'	DRAWN - FPB	REVISED -		STA. 142 + 99.99 - STA. 143 + 99.99			CONTRACT NO. 63655				
	PLOT DATE = 11/15/2011	CHECKED - MJT	REVISED -		SCALE: SHEET NO. OF SHEETS STA. TO STA.							
		DATE -	REVISED -		I			I				