

MATCHLINE - SEE SHEET 6

This document, together with the concepts and designs presented herein, is intended only for the specific purpose and client for which it was prepared. Reuse of any part of this document for any other project without the written consent of the engineer is prohibited. The engineer and its staff shall not be held responsible for any errors or omissions in this document. The engineer and its staff shall not be held responsible for any damages, including consequential damages, arising from the use of this document. The engineer and its staff shall not be held responsible for any claims, damages, or liabilities, including consequential damages, arising from the use of this document. The engineer and its staff shall not be held responsible for any claims, damages, or liabilities, including consequential damages, arising from the use of this document.

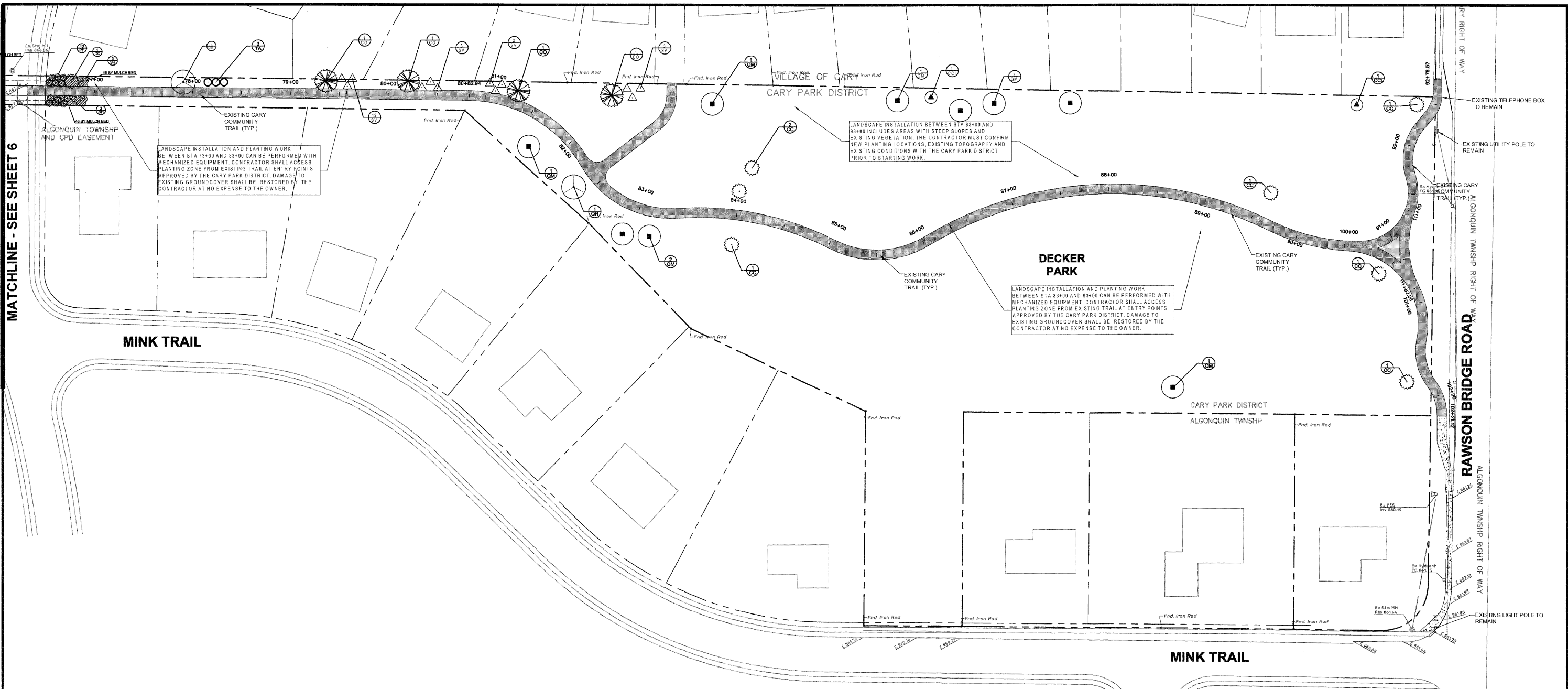

BENCHMARKS

SOURCE BENCHMARK
 DESCRIPTION: MANHOLE #46 FROM THE ABSULT RECORD DRAWINGS BY MANHARD CONSULTING LTD DATED 3-6-07 FOR THE FOXFORD HILLS SUBDIVISION-PHASE 1 IN THE VILLAGE OF CARY, ILLINOIS.
 LOCATION: 120' NORTHEAST OF THE OAKMAN DRIVE AND PARKSTONE DRIVE INTERSECTION ON OAKMAN DRIVE.
 ELEVATION: 861.45

SITE BENCHMARKS
 HE CP #100
 DESCRIPTION: IRON PIPE.
 LOCATION: 1000' EAST OF THE INTERSECTION OF 1ST AND THREE OAKS ROAD, 584' NORTH OF THE NORTH SIDE OF THREE OAKS ROAD, 31' NORTHEAST OF STORM MANHOLE, AND 26' NORTHWEST OF POWER POLE.
 ELEVATION: 854.94

HE CP #1
 DESCRIPTION: "PK" NAIL IN EDGE OF PAVEMENT.
 LOCATION: 592' WEST OF THE INTERSECTION OF RAWSON BRIDGE ROAD AND MINK TRAIL, 45' SOUTHWEST OF TREE, 27' SOUTHEAST OF IRON ROD, AND 10' SOUTH OF CONCRETE WALK.
 ELEVATION: 860.97

HE CP #6
 DESCRIPTION: RAIL ROAD SPIKE.
 LOCATION: NORTHWEST CORNER OF INTERSECTION OF CRYSTAL LAKE ROAD AND RAWSON BRIDGE ROAD, 22' SOUTHEAST OF FENCE CORNER, 18' SOUTHWEST OF POWER POLE, AND 11' NORTHWEST OF PAVEMENT.
 ELEVATION: 823.23

LANDSCAPING LEGEND:

- PROPOSED LANDSCAPE ITEM (SEE SHEET 2 FOR PLANTING LEGEND AND SCHEDULE SHEET)
- EXISTING TRAIL
- EXISTING TREE LINE

GENERAL NOTES

1. THE CONTRACTOR SHALL REFERENCE THE CARY COMMUNITY TRAIL ENGINEERING PLANS DATED 10-02-2009 (ILLINOIS DEPARTMENT OF TRANSPORTATION PROJECT TE-00D1708) PRIOR TO STARTING WORK. PLANS ARE AVAILABLE UPON REQUEST FROM THE CARY PARK DISTRICT.
2. THE CONTRACTOR SHALL CONFIRM EXISTING TRAIL CONDITIONS AND NEW LANDSCAPING ITEM PLACEMENT LOCATIONS WITH THE CARY PARK DISTRICT PRIOR TO STARTING CONSTRUCTION. CONTACT DAVE RAICA, CARY PARK DISTRICT, AT 847-639-4901.

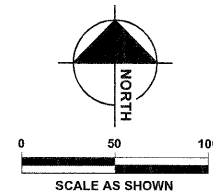
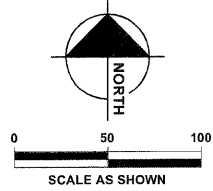

DESIGNED - JWH	REVISED
DRAWN - JKM	REVISED
CHECKED - JWH	REVISED
DATE - 10/21/2011	REVISED

**STATE OF ILLINOIS
DEPARTMENT OF TRANSPORTATION**

**CARY PARK DISTRICT
CARY TRAIL LANDSCAPING**

**LANDSCAPE PLAN: STA. 76+00 TO 92+76.57
STA. 100+00 TO 102+21.12
STA. 111+00 TO 111+82.06**

SECTION	COUNTY	TOTAL SHEETS	SHEET NO.
06-P4001-01-BT	MCHENRY	7	6
FED. ROAD DIST. NO. 1	ILLINOIS	CONTRACT NO. 63656	