

NOTES:

1. THE ACTUAL LOCATION OF PAVEMENT PATCHING WILL BE DETERMINED IN THE FIELD, DURING CONSTRUCTION, BY THE RESIDENT ENGINEER.
2. ALL CRACK FILL MATERIAL TO BE REMOVED IN ENTIRETY ALONG CURB LINE. REMOVAL OF THE MATERIAL SHALL BE PAID FOR AS HOT MIX ASPHALT REMOVAL.
3. THE CONTRACTOR SHALL REESTABLISH THE AGGREGATE SHOULDER AREAS UP TO 4 FEET WIDE FROM THE ROADWAY EDGE LINE. PAID FOR AS AGGREGATE SHOULDERS, TYPE B 6" (48101200)

LEGEND:

- 1. HOT MIX ASPHALT SURFACE REMOVAL, 2 1/2" (44000159)
- 2. DRAINAGE AND UTILITY STRUCTURES TO BE ADJUSTED (Z0017400)
- 3. FRAMES AND LIDS TO BE ADJUSTED (SPECIAL) (X6030310)
- 4. HMA SURFACE REMOVAL - BUTT JOINT (40600982)

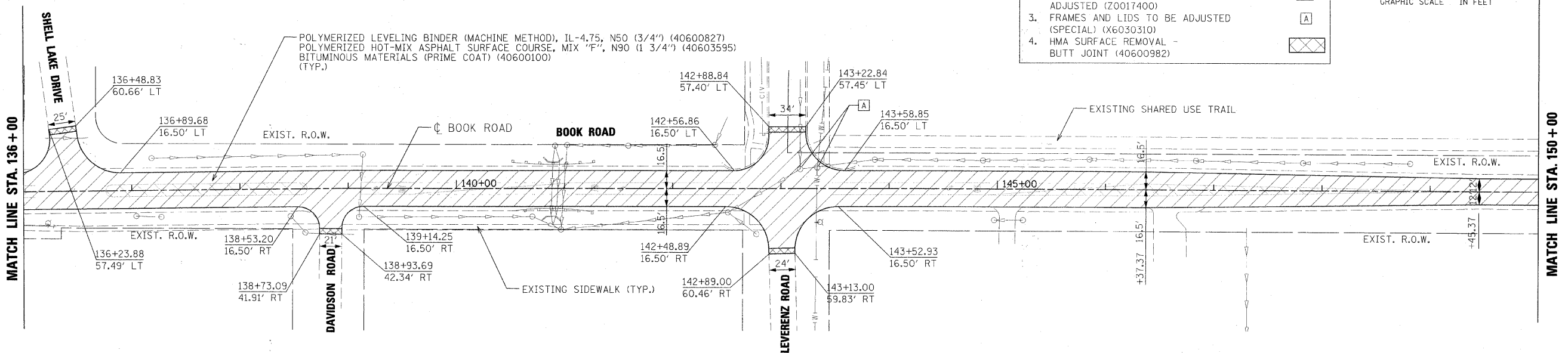
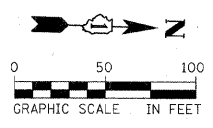

FILE NAME = SFILES



USER NAME = #USER#	DESIGNED - EVI	REVISED -
PLOT SCALE = #SCALE#	DRAWN - KJB	REVISED -
PLOT DATE = #DATE#	CHECKED - DAK	REVISED -
#TIME#	DATE - 10/24/2011	REVISED -

**STATE OF ILLINOIS
DEPARTMENT OF TRANSPORTATION**

**BOOK ROAD
PROPOSED ROADWAY PLAN**

SCALE: 1" = 50 FT SHEET NO. 5 OF 6 SHEETS STA. 122+00 TO STA. 150+00

F.A.U. RTE. 0082	SECTION 11-00149-00-RS	COUNTY WILL	TOTAL SHEETS 30	SHEET NO. 10
CONTRACT NO. 63659				
FED. ROAD DIST. NO. 1 ILLINOIS FED. AID PROJECT				