

PLAN	SURVEYED	BY	DATE
	PLOTTED		
	CHECKED		
	DATE		
	BY		
	CHECKED		
	DATE		
	BY		
	CHECKED		
	DATE		
	BY		
	CHECKED		
	DATE		
	BY		
	CHECKED		
	DATE		

PROFILE	SURVEYED	BY	DATE
	PLOTTED		
	CHECKED		
	DATE		
	BY		
	CHECKED		
	DATE		
	BY		
	CHECKED		
	DATE		
	BY		
	CHECKED		
	DATE		

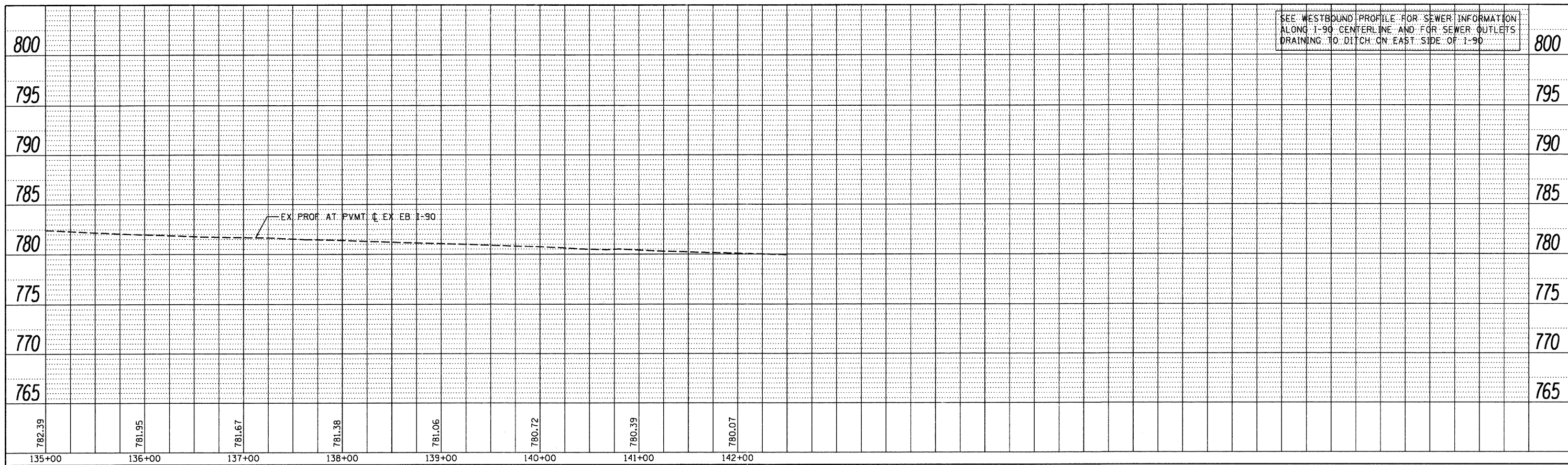

SEE WESTBOUND PROFILE FOR SEWER INFORMATION ALONG I-90 CENTERLINE AND FOR SEWER OUTLETS DRAINING TO DITCH ON EAST SIDE OF I-90

EASTBOUND PROFILE

WESTBOUND PROFILE

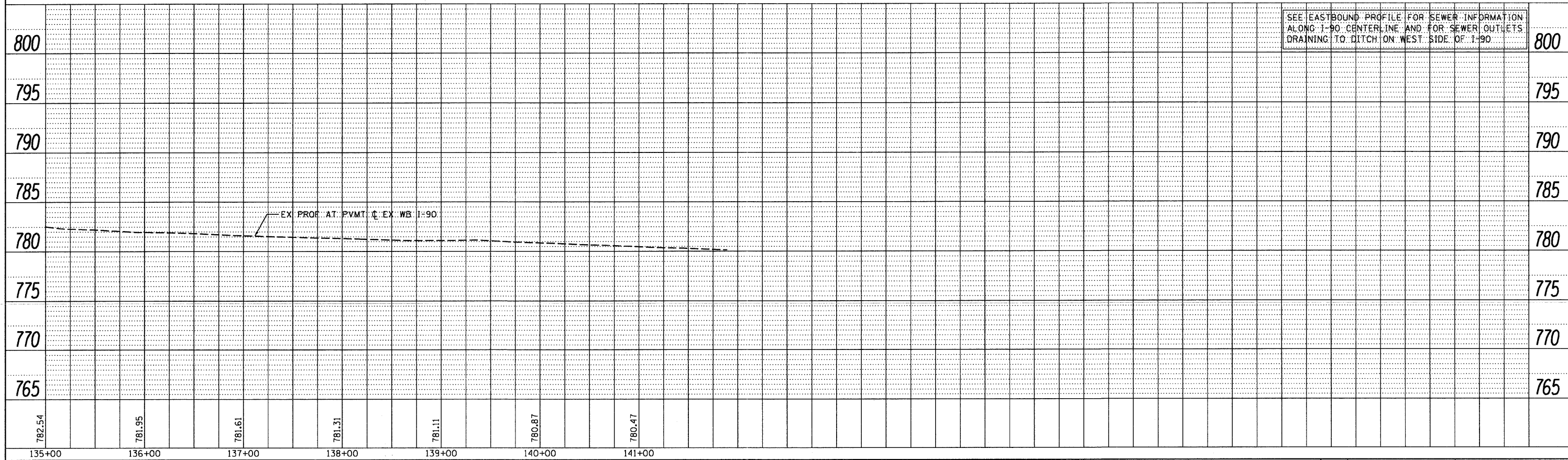

SEE EASTBOUND PROFILE FOR SEWER INFORMATION ALONG I-90 CENTERLINE AND FOR SEWER OUTLETS DRAINING TO DITCH ON WEST SIDE OF I-90

 	USER NAME = .USERNAME. PLOT SCALE = 50.0000' / IN. PLOT DATE = 10/19/2011	DESIGNED - DRAWN - BSL CHECKED - PDS DATE - 10-21-2011	REVISED - REVISED - REVISED - REVISED -	STATE OF ILLINOIS DEPARTMENT OF TRANSPORTATION	PROPOSED I-90 MAINLINE PROFILES			F.A. RTE. 90	SECTION (X2-1) R	COUNTY WINNEBAGO	TOTAL SHEETS 510	SHEET NO. 99
	SCALE: SHEET NO. OF SHEETS STA. 135+00 TO STA.				ILLINOIS FED. AID PROJECT CONTRACT NO. 64C29							