

DATE	
BY	
SURVEYED	
PLOTTED	
CHECKED	
REVISIONS	
NOTE BOOK	
NO.	
CADD FILE NAME	

DATE	
BY	
SURVEYED	
PLOTTED	
CHECKED	
REVISIONS	
NOTE BOOK	
NO.	
STRUCTURE NOTATION CHRD	

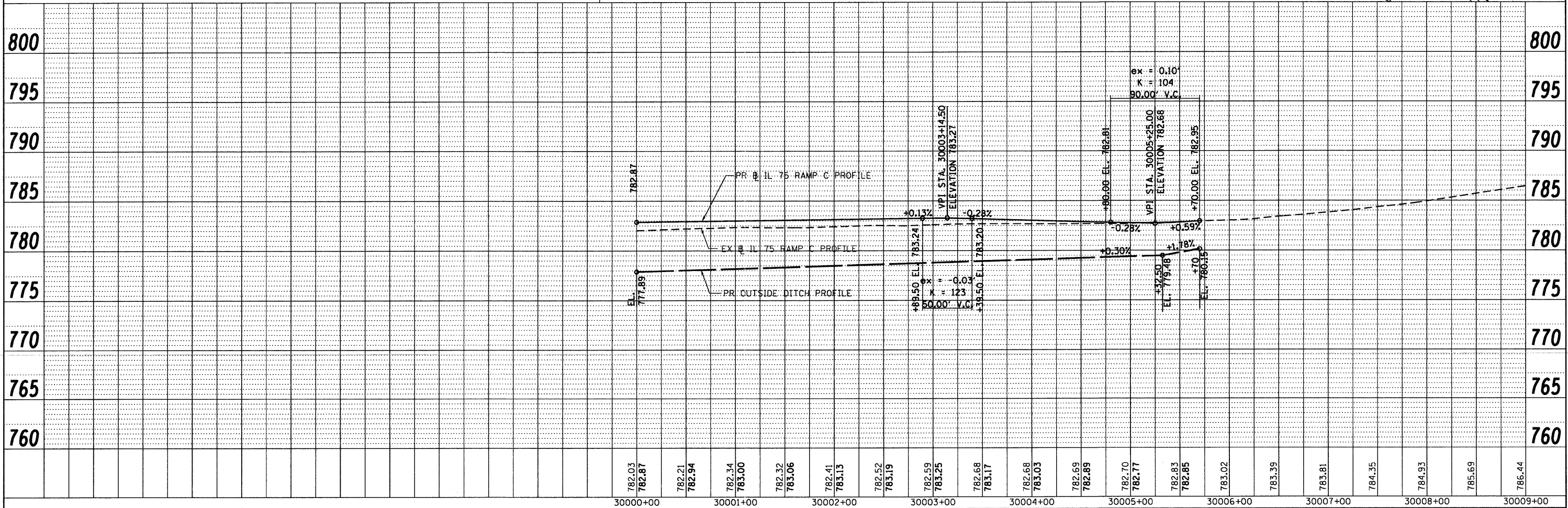
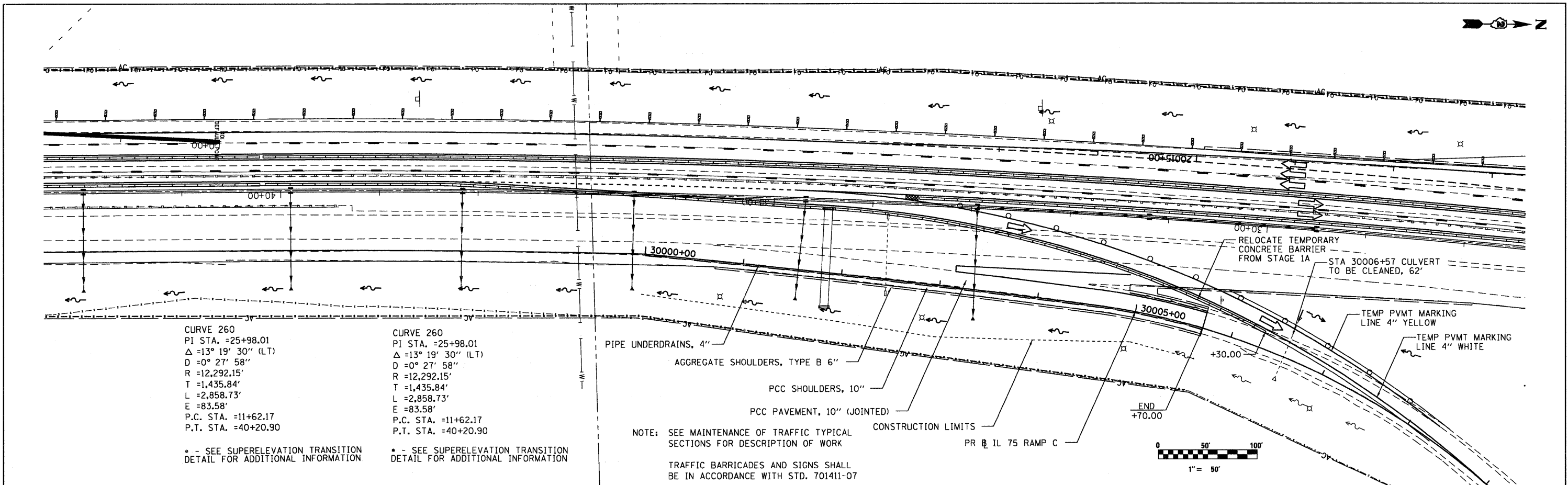

782.03	782.87	782.21	782.94	782.34	783.00	782.32	783.06	782.41	783.13	782.52	783.19	782.59	783.25	782.68	783.17	782.68	783.03	782.69	782.89	782.70	782.77	782.83	782.85	783.02	783.39	783.81	784.35	784.93	785.69	786.44		
30000+00	30001+00	30002+00	30003+00	30004+00	30005+00	30006+00	30007+00	30008+00	30009+00																							

McClure LOCHNER
 Engineering Associates, Inc.
 1701 W. LOCHNER, MC. CHICAGO, ILLINOIS

RWA
 Registered Professional Engineer
 State of Illinois

QEI
 QUIGG ENGINEERING INC.

USER NAME = .USERNAME.	DESIGNED - MM	REVISED -
FILE NAME = sht.plrprf_ramp.stg1B.dgn	DRAWN - MS	REVISED -
PLT SCALE = 50.0000' / 1"	CHECKED - MM	REVISED -
PLT DATE = 10/19/2011	DATE - 10/21/2011	REVISED -

STATE OF ILLINOIS
DEPARTMENT OF TRANSPORTATION

SCALE: 1" = 50'

PLAN AND PROFILE - STAGE 1B	
IL 75 RAMP C	
SHEET NO. 1 OF 1 SHEETS	STA. 30000+00 TO STA. 30009+00

F.A.I. RTE. 90	SECTION (X2-1) R	COUNTY WINNEBAGO	TOTAL SHEETS 510	SHEET NO. 101
CONTRACT NO. 64C29			ILLINOIS FED. AID PROJECT	