

DATE: \_\_\_\_\_ BY: \_\_\_\_\_  
 SURVEYED \_\_\_\_\_  
 PLOTTED \_\_\_\_\_  
 CHECKED \_\_\_\_\_  
 NOTE BOOK NO. \_\_\_\_\_  
 CAD FILE NAME \_\_\_\_\_

DATE: \_\_\_\_\_ BY: \_\_\_\_\_  
 SURVEYED \_\_\_\_\_  
 PLOTTED \_\_\_\_\_  
 CHECKED \_\_\_\_\_  
 NOTE BOOK NO. \_\_\_\_\_  
 CAD FILE NAME \_\_\_\_\_

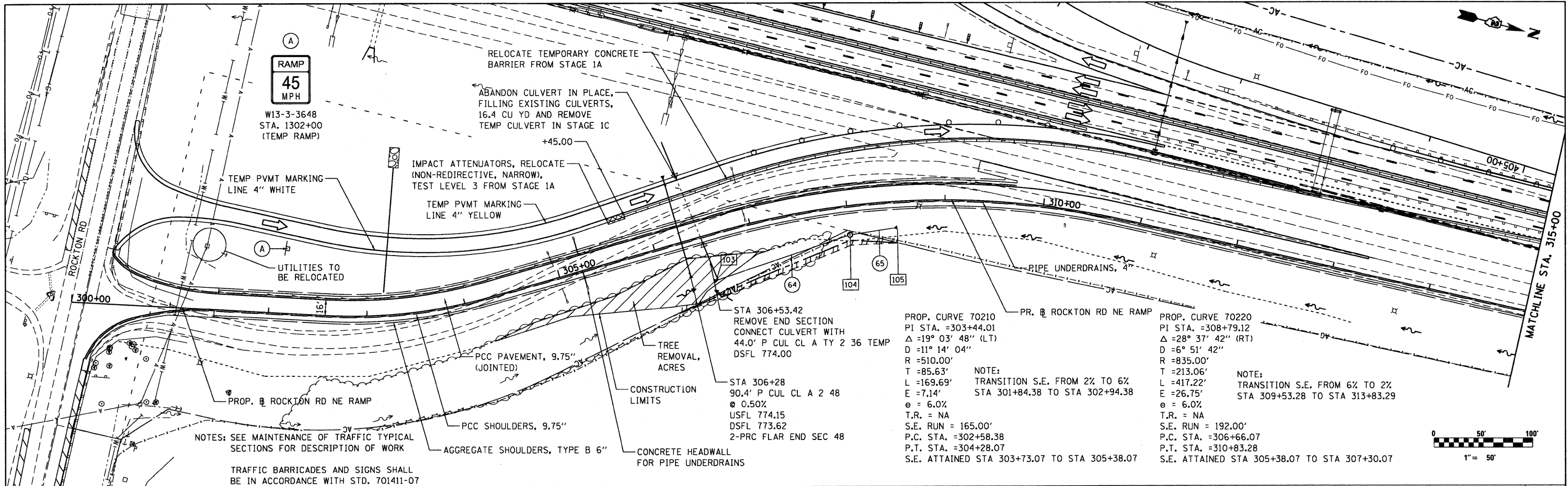

NOTES: SEE MAINTENANCE OF TRAFFIC TYPICAL SECTIONS FOR DESCRIPTION OF WORK  
 TRAFFIC BARRICADES AND SIGNS SHALL BE IN ACCORDANCE WITH STD. 701411-07

DRAINAGE STRUCTURE SCHEDULE

NO.	LOCATION		TYPE	RIM ELEV	INVERT ELEVATION			
	STATION	OFFSET			(IN)	(IN)	(IN)	(OUT)
103	306+50	46.9' RT	PRC FLAR END SEC 24	-				774.46
104	308+00	29.5' RT	MAN TA 5 DIA TIF CL	780.46	776.17			776.12
105	308+50	26.4' RT	PRC FLAR END SEC 24	-	776.71			

DRAINAGE SEWER SCHEDULE

SEWER NO.	TYPE	SIZE (INCH)	LENGTH (FEET)	SLOPE (%)
65	STORM SEW CL A 1	24	39.8	1.13%

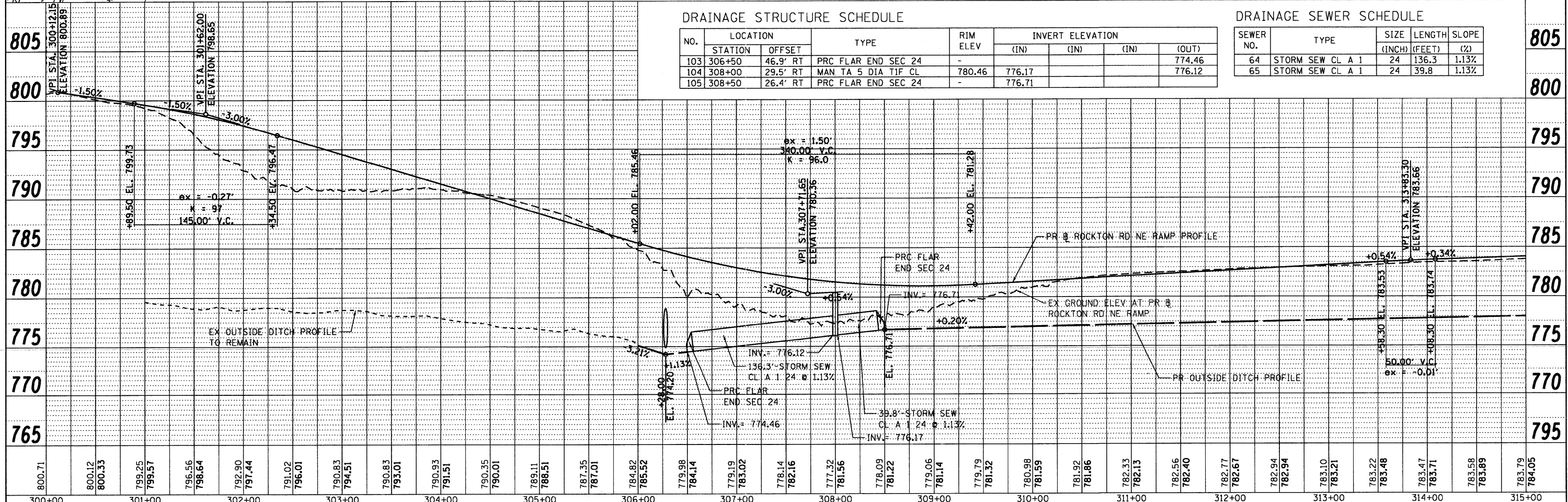

300+00	301+00	302+00	303+00	304+00	305+00	306+00	307+00	308+00	309+00	310+00	311+00	312+00	313+00	314+00	315+00																																													
800.71	800.12	800.33	799.25	799.57	796.56	798.64	792.90	797.44	791.02	796.01	790.83	794.51	790.83	793.01	790.93	791.51	790.35	790.01	789.11	788.51	787.35	787.01	784.82	785.52	779.98	784.14	779.19	783.02	778.14	782.16	777.32	781.56	778.09	781.22	779.06	781.14	779.79	781.32	780.98	781.59	781.92	781.86	782.33	782.15	782.56	782.40	782.77	782.67	782.94	782.94	783.10	783.21	783.22	783.48	783.47	783.71	783.58	783.89	783.79	784.05

STATE OF ILLINOIS  
 DEPARTMENT OF TRANSPORTATION

PLAN AND PROFILE - STAGE 1B  
 ROCKTON RD NE RAMP  
 SCALE: 1"=50' SHEET NO. 1 OF 1 SHEETS STA. 300+00 TO STA. 315+00

F.A.I. RTE. 90	SECTION (X2-1) R	COUNTY WINNEBAGO	TOTAL SHEETS 510	SHEET NO. 109
CONTRACT NO. 64C29			ILLINOIS FED. AID PROJECT	

McClure LOCHNER  
 ENGINEERS, INC.  
 RWA  
 QUICO ENGINEERING, INC.

USER NAME = .USERNAME.  
 FILE NAME = sht.plnprf.ramp.stg1b.dgn  
 PLOT SCALE = 50.0000' / in.  
 PLOT DATE = 10/19/2011  
 DESIGNED - MM  
 DRAWN - MS  
 CHECKED - MM  
 DATE - 10/21/2011  
 REVISED -  
 REVISED -  
 REVISED -  
 REVISED -