

SEE SHT 109 FOR RAMP MOT DETAIL

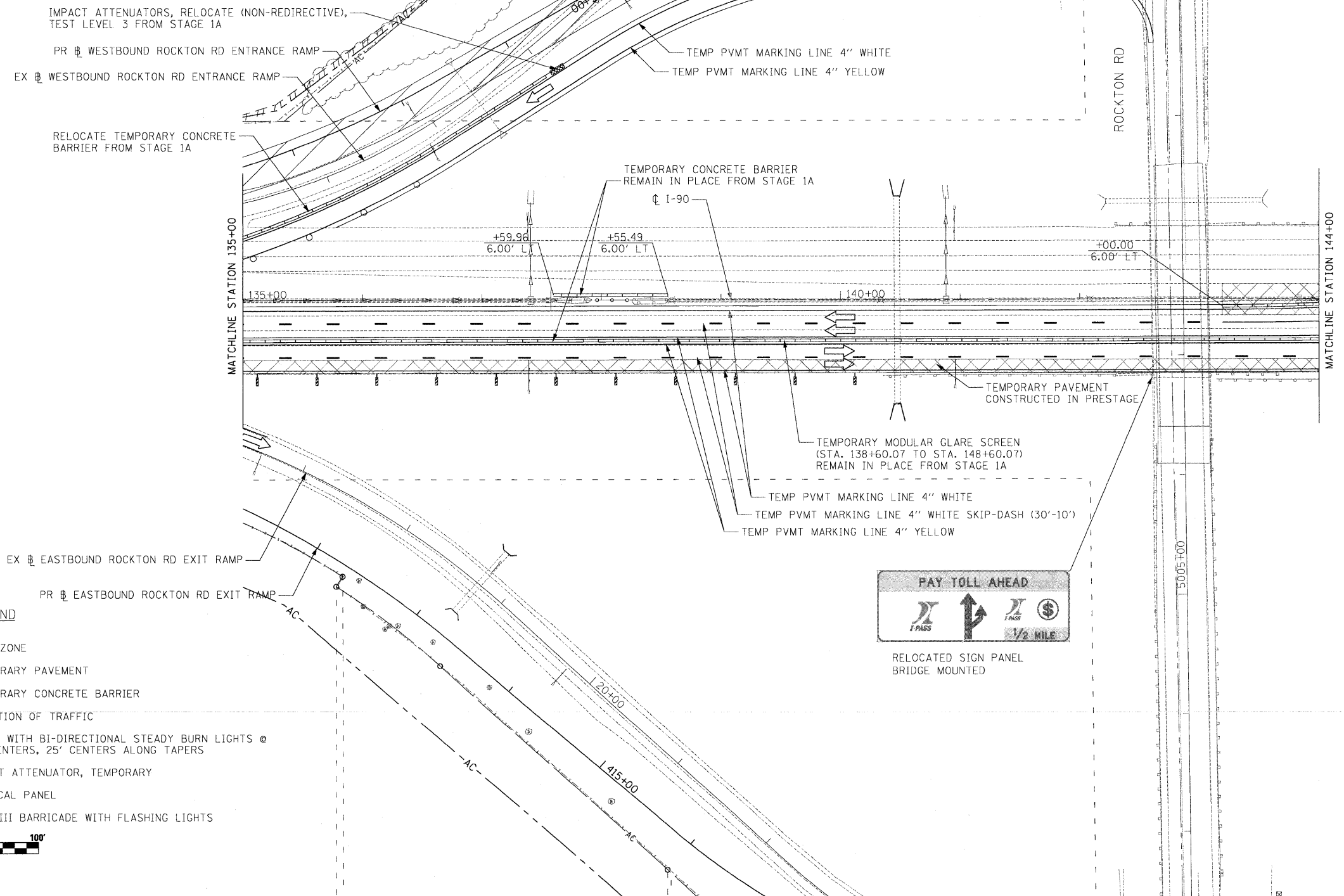

**LEGEND**

- WORK ZONE
- TEMPORARY PAVEMENT
- TEMPORARY CONCRETE BARRIER
- DIRECTION OF TRAFFIC
- DRUMS WITH BI-DIRECTIONAL STEADY BURN LIGHTS @ 50' CENTERS, 25' CENTERS ALONG TAPERS
- IMPACT ATTENUATOR, TEMPORARY
- VERTICAL PANEL
- TYPE III BARRICADE WITH FLASHING LIGHTS

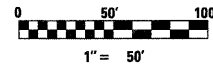

**McClure LOCHNER**  
Engineering Associates, Inc.  
**RWA**  
Engineering & Construction, Inc.

USER NAME = .USERNAME_	DESIGNED - CGC	REVISED -
LOT SCALE = 50.0000' / IN.	DRAWN - CGC	REVISED -
LOT DATE = 10/19/2011	CHECKED - AM	REVISED -
	DATE - 10/14/2011	REVISED -

**STATE OF ILLINOIS  
DEPARTMENT OF TRANSPORTATION**

**MOT I-90 STAGE 1B**

SCALE: 1"=50' SHEET NO. OF SHEETS STA. 135+00 TO STA. 144+00

F.A.I. RTE. 90	SECTION (X2-1)R	COUNTY WINNEBAGO	TOTAL SHEETS 510	SHEET NO. 166
CONTRACT NO. 64C29				
ILLINOIS FED. AID PROJECT				