

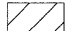





LEGEND

-  WORK ZONE
-  TEMPORARY PAVEMENT
-  TEMPORARY CONCRETE BARRIER
-  DIRECTION OF TRAFFIC
-  DRUMS WITH BI-DIRECTIONAL STEADY BURN LIGHTS @ 50' CENTERS, 25' CENTERS ALONG TAPERS
-  IMPACT ATTENUATOR, TEMPORARY (NON-REDIRECTIVE)
-  VERTICAL PANEL

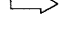

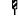
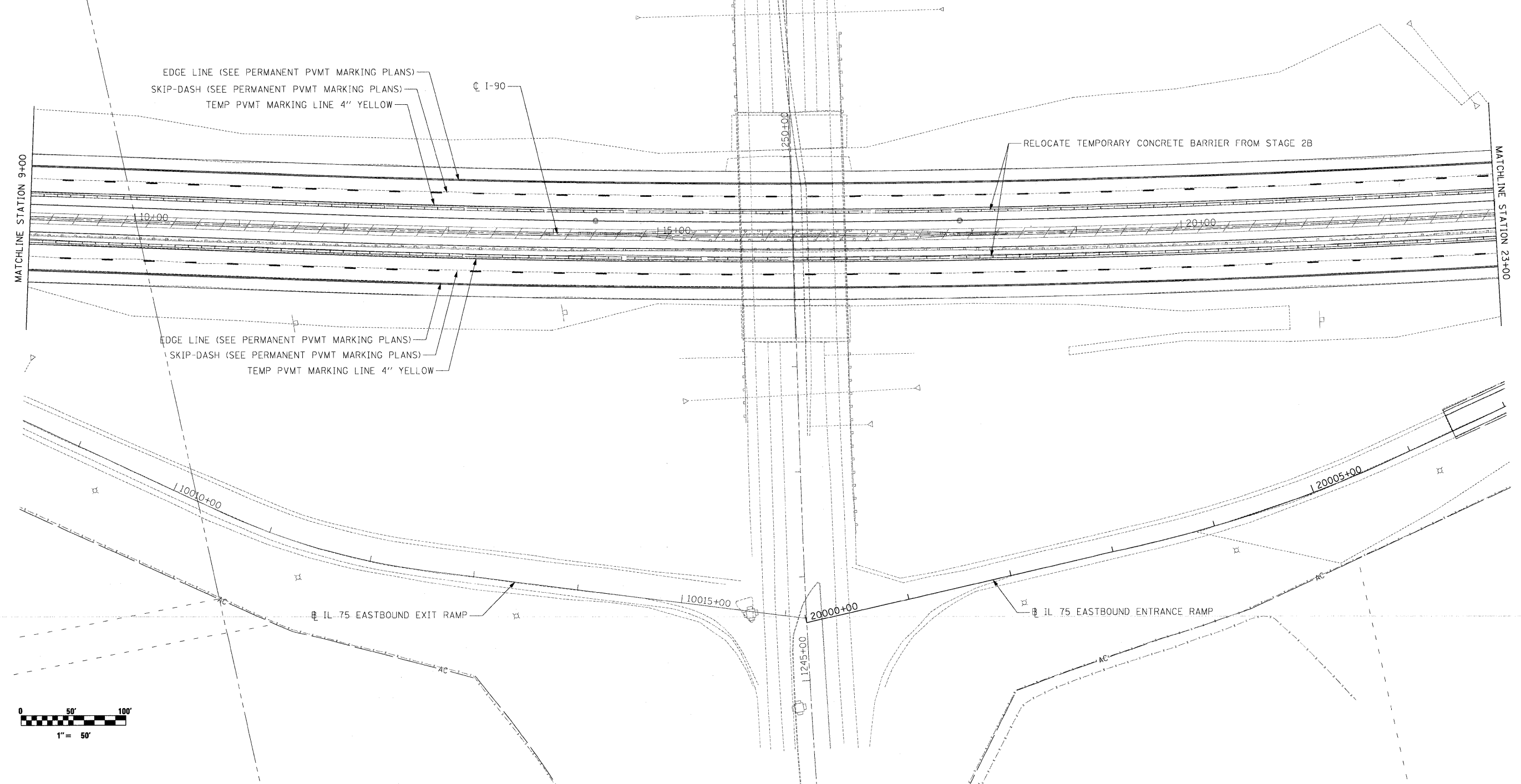
McClure LOCHNER
Engineering Associates, Inc.
RWA
Engineering Inc.

USER NAME = .USERNAME.
PLOT SCALE = 50,0000 ' / IN.
PLOT DATE = 10/19/2011

DESIGNED - CGC
DRAWN - CGC
CHECKED - AM
DATE - 10/14/2011

REVISED -
REVISED -
REVISED -
REVISED -

**STATE OF ILLINOIS
DEPARTMENT OF TRANSPORTATION**

MOT I-90 STAGE 3

SCALE: 1"=50' SHEET NO. OF SHEETS STA. 9+00 TO STA. 23+00

F.A.I. RTE. 90	SECTION (X2-1)R	COUNTY WINNEBAGO	TOTAL SHEETS 510	SHEET NO. 202
CONTRACT NO. 64C29				
ILLINOIS FED. AID PROJECT				