

- LEGEND**
- WORK ZONE
 - TEMPORARY PAVEMENT
 - TEMPORARY CONCRETE BARRIER
 - DIRECTION OF TRAFFIC
 - DRUMS WITH BI-DIRECTIONAL STEADY BURN LIGHTS @ 50' CENTERS, 25' CENTERS ALONG TAPERS
 - IMPACT ATTENUATOR, TEMPORARY (NON-REDIRECTIVE)
 - VERTICAL PANEL

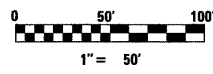
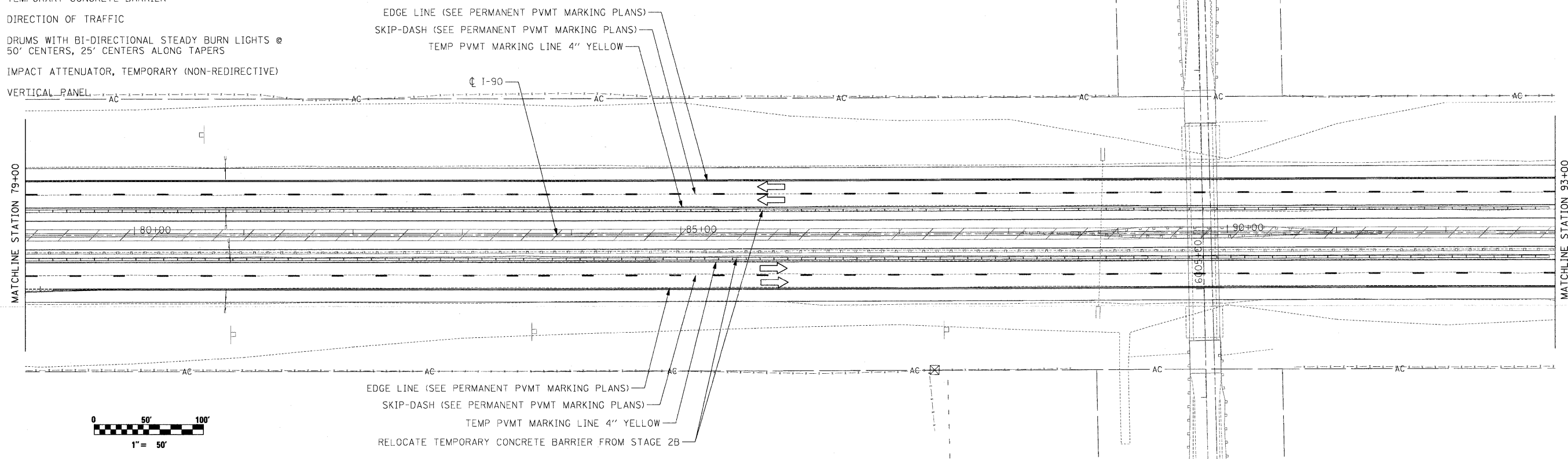
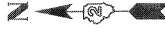

McClure LOCHNER
Engineering Associates, Inc.
RVA
QUIGO ENGINEERING ETC.

USER NAME = .USERNAME_	DESIGNED - CGC	REVISED -
PLLOT SCALE = 50.0000' / IN.	DRAWN - CGC	REVISED -
PLLOT DATE = 10/19/2011	CHECKED - AM	REVISED -
	DATE - 10/14/2011	REVISED -

**STATE OF ILLINOIS
DEPARTMENT OF TRANSPORTATION**

MOT I-90 STAGE 3

SCALE: 1"=50' SHEET NO. OF SHEETS STA. 65+00 TO STA. 93+00

F.A.I. RTE. 90	SECTION (X2-1)R	COUNTY WINNEBAGO	TOTAL SHEETS 510	SHEET NO. 205
CONTRACT NO. 64C29			ILLINOIS FED. AID PROJECT	