

EAST CURB LINE (48'-0" LT)

Location	Station	Offset	Theoretical Grade Elevations
End North Appr. Slab	71+98.49	-48.00	777.48
A	72+08.49	-48.00	777.53
B	72+18.49	-48.00	777.58
Back North Abutment	72+28.49	-48.00	777.63

EAST EDGE OF PAVEMENT (37'-0" LT)

Location	Station	Offset	Theoretical Grade Elevations
End North Appr. Slab	72+01.44	-37.00	777.72
A	72+11.44	-37.00	777.77
B	72+21.44	-37.00	777.82
Back North Abutment	72+31.44	-37.00	777.87

LANE LINE (CROWN PT) (24'-0" LT)

Location	Station	Offset	Theoretical Grade Elevations
End North Appr. Slab	72+04.92	-24.00	777.94
A	72+14.92	-24.00	777.99
B	72+24.92	-24.00	778.04
Back North Abutment	72+34.92	-24.00	778.09

LANE LINE (12'-0" LT)

Location	Station	Offset	Theoretical Grade Elevations
End North Appr. Slab	72+08.13	-12.00	777.77
A	72+18.13	-12.00	777.82
B	72+28.13	-12.00	777.87
Back North Abutment	72+38.13	-12.00	777.92

WEST EDGE OF PAVEMENT & P.G.L.

Location	Station	Offset	Theoretical Grade Elevations
End North Appr. Slab	72+11.35	0.00	777.54
A	72+21.35	0.00	777.59
B	72+31.35	0.00	777.64
Back North Abutment	72+41.35	0.00	777.69

WEST CURB LINE (11'-6" RT)

Location	Station	Offset	Theoretical Grade Elevations
End North Appr. Slab	72+14.43	11.50	777.31
A	72+24.43	11.50	777.36
B	72+34.43	11.50	777.41
Back North Abutment	72+44.43	11.50	777.46

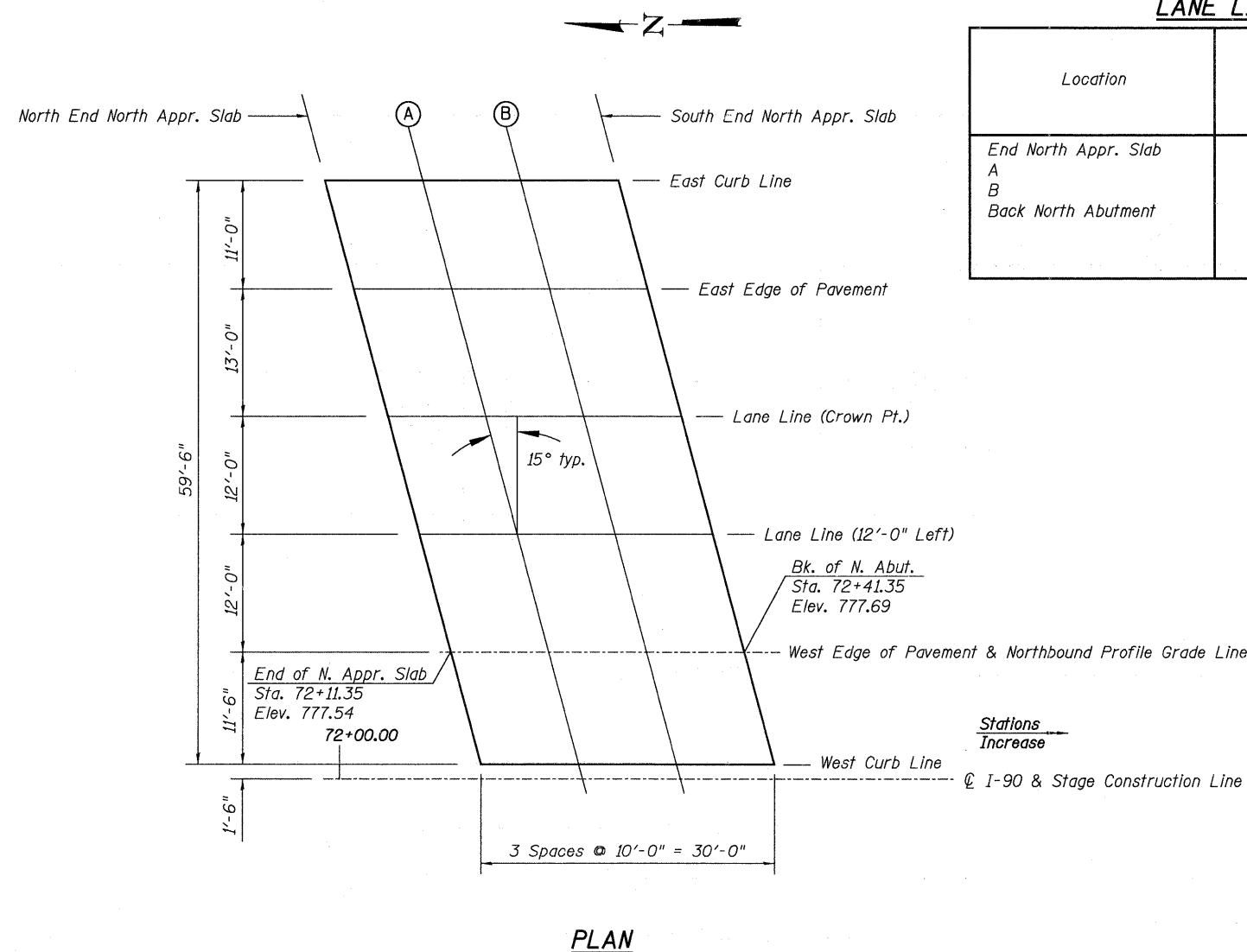

Note:
Positive offset means right of profile grade line.
Negative offset means left of profile grade line.