

EAST CURB LINE (48'-0" LT)

Location	Station	Offset	Theoretical Grade Elevations
Back South Abut.	73+81.83	-48.00	778.39
A	73+91.83	-48.00	778.44
B	74+01.83	-48.00	778.49
End South Appr. Slab	74+11.83	-48.00	778.54

EAST EDGE OF PAVEMENT (37'-0" LT)

Location	Station	Offset	Theoretical Grade Elevations
Back South Abut.	73+84.78	-37.00	778.64
A	73+94.78	-37.00	778.69
B	74+04.78	-37.00	778.74
End South Appr. Slab	74+14.78	-37.00	778.79

LANE LINE (CROWN PT) (24'-0" LT)

Location	Station	Offset	Theoretical Grade Elevations
Back South Abut.	73+88.26	-24.00	778.86
A	73+98.26	-24.00	778.91
B	74+08.26	-24.00	778.96
End South Appr. Slab	74+18.26	-24.00	779.01

LANE LINE (12'-0" LT)

Location	Station	Offset	Theoretical Grade Elevations
Back South Abut.	73+91.47	-12.00	778.69
A	74+01.47	-12.00	778.74
B	74+11.47	-12.00	778.79
End South Appr. Slab	74+21.47	-12.00	778.84

WEST EDGE OF PAVEMENT & P.G.L.

Location	Station	Offset	Theoretical Grade Elevations
Back South Abut.	73+94.69	0.00	778.45
A	74+04.69	0.00	778.50
B	74+14.69	0.00	778.55
End South Appr. Slab	74+24.69	0.00	778.60

WEST CURB LINE (11'-6" RT)

Location	Station	Offset	Theoretical Grade Elevations
Back South Abut.	73+97.77	11.50	778.23
A	74+07.77	11.50	778.28
B	74+17.77	11.50	778.33
End South Appr. Slab	74+27.77	11.50	778.38

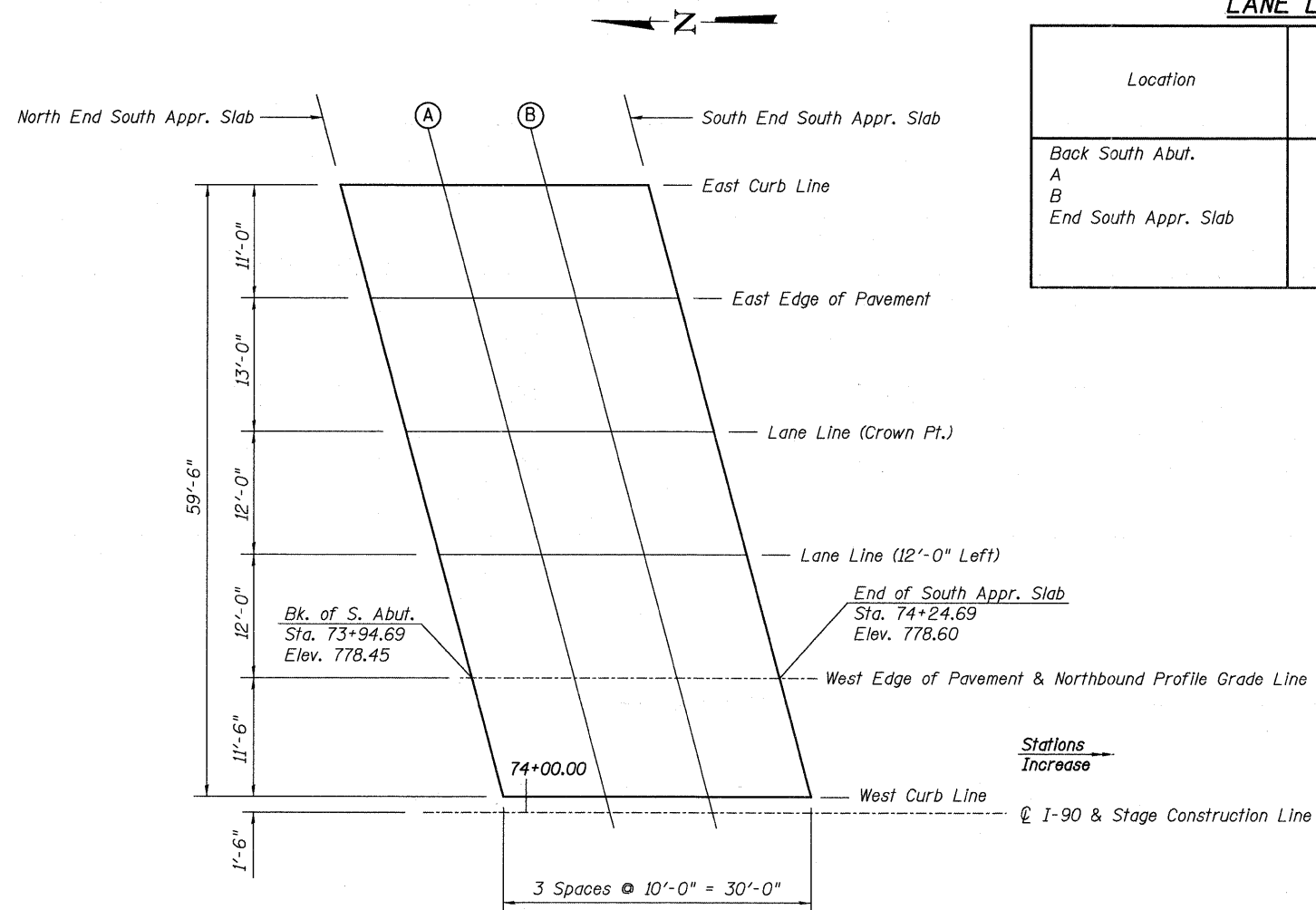

PLAN

Note:
Positive offset means right of profile grade line.
Negative offset means left of profile grade line.