

Bench Mark: Toe of Sign, Sta. 100+84.16, 86.5' RT; Elevation 777.04

Existing Structure: S.N. 101-1031 built 1959 at sta. 96+09.07  
is a R.C. double 8'x4' box culvert 154 feet long. Skew 29° 49' 23"  
RT. Structure to be removed and replaced.

Salvage: No Salvage

Staging: Two lanes of traffic shall be maintained in each  
direction utilizing stage construction.

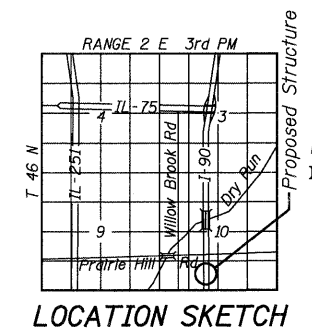

**INDEX OF CULVERT SHEETS**

- 1 GENERAL PLAN AND ELEVATION
- 2 GENERAL DATA
- 3 MAINTENANCE OF TRAFFIC
- 4 BOX CULVERT END SECTION DETAILS (SHEET 1 OF 2)
- 5 BOX CULVERT END SECTION DETAILS (SHEET 2 OF 2)
- 6 SOIL BORING LOGS
- 7 SOIL BORING LOGS

**TOTAL BILL OF MATERIAL**

ITEM	UNIT	TOTAL
Removal and Disposal of Unsuitable Material for Structures	Cu. Yd.	714.5
Removal of Existing Structures	Each	1
Name Plates	Each	1
Box Culvert End Sections, Culvert No. 1	Each	2
Precast Concrete Box Culverts, 8' x 4'	Foot	352
Breaker Run Crushed Stone	Ton	1133.2
Temporary Sheet Piling	Sq. Ft.	1465
Temporary Support System	L. Sum	1

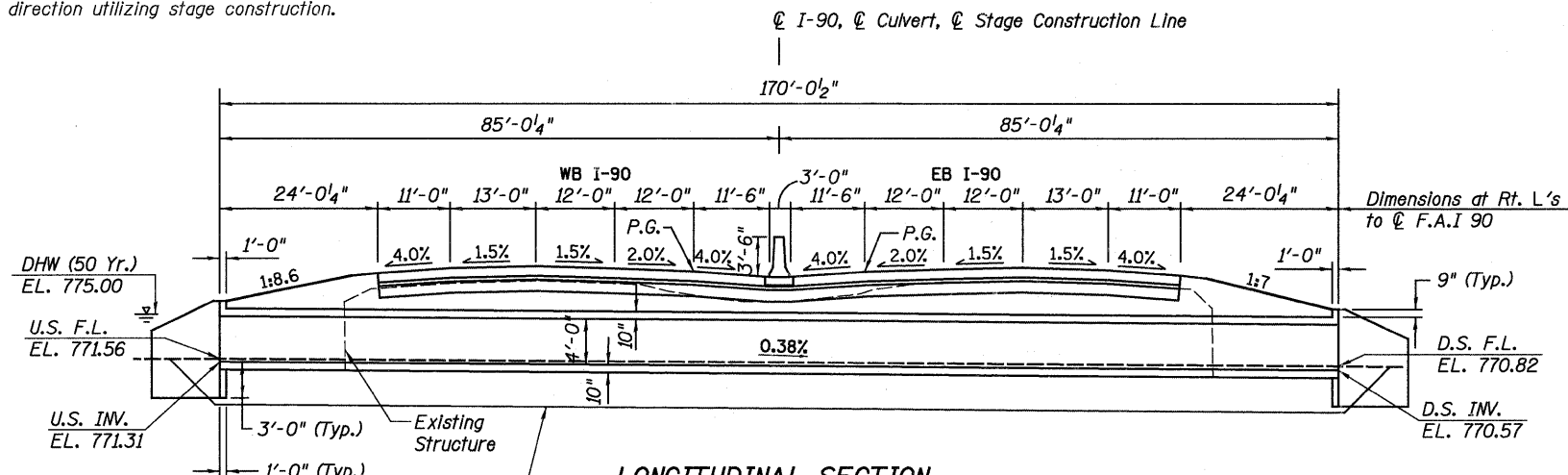

**LONGITUDINAL SECTION**

(Looking South)  
(Dimensions are  $\perp$  to  $\odot$  Roadway)

See Sheet 3 of 7 for Stage Construction  
and Maintenance of Traffic Details.

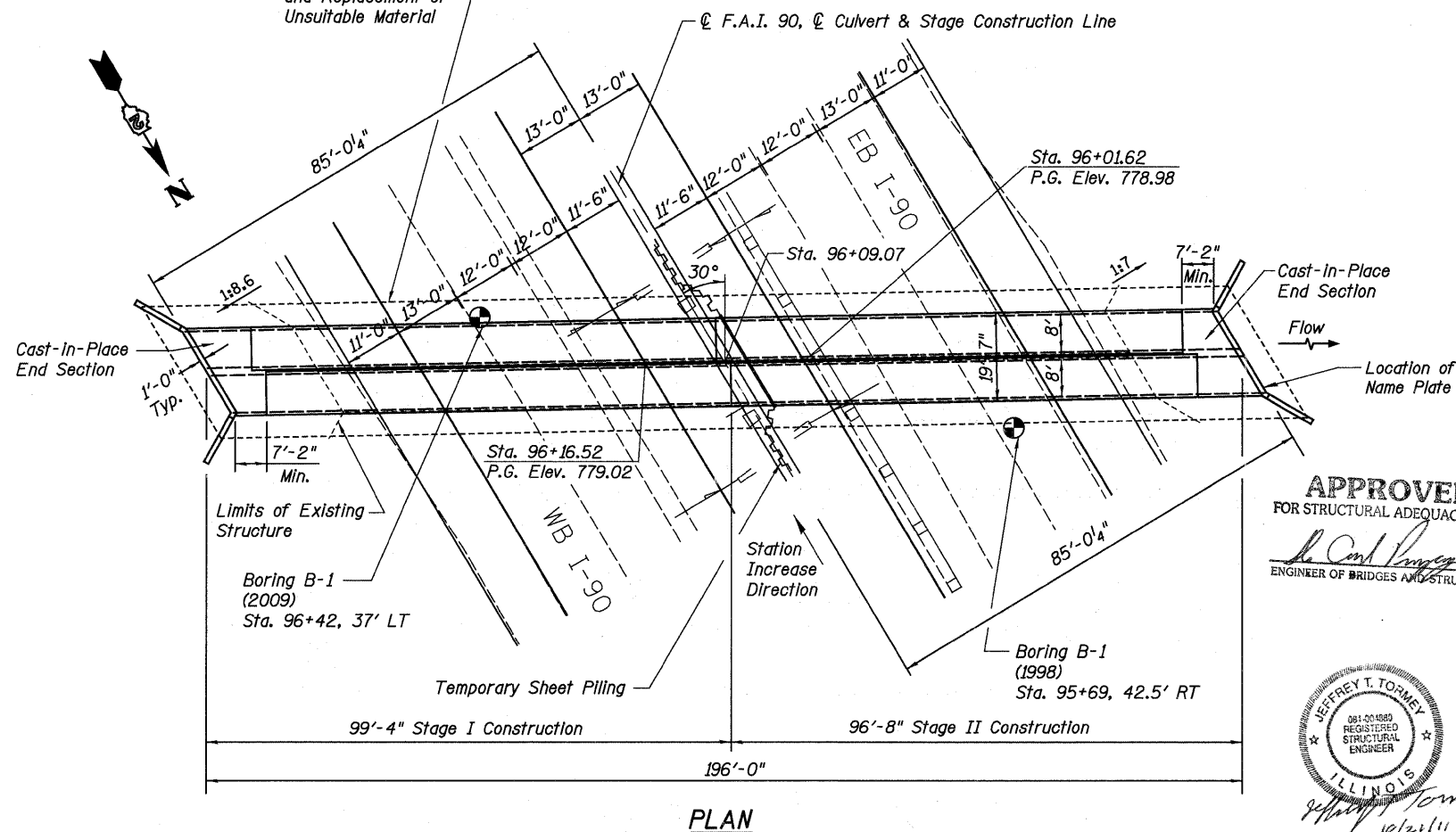

**PLAN**

STATION 96+09.07  
BUILT 20\_\_ BY  
STATE OF ILLINOIS  
F.A.I. RTE 90 SEC (X2-1)R  
LOADING HS-20 & ALT  
STRUCTURE NO. 101-1095

**NAME PLATE**  
See Std. 515001

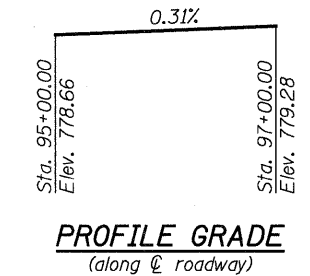

**PROFILE GRADE**  
(along  $\odot$  roadway)

**LOADING HS 20-44 & ALTERNATE**  
Allow 50#/sq. ft. for future wearing surface.

**DESIGN SPECIFICATIONS**  
2002 AASHTO Standard Specifications

**DESIGN SCOUR ELEVATION TABLE**

	Upstream	Downstream
Design Scour Elevation (ft)	768.31	767.57

**DESIGN STRESSES**

**FIELD UNITS**  
f'c = 3,500 psi  
fy = 60,000 psi

**PRECAST UNITS**  
f'c = 5,000 psi  
fy = 65,000 psi  
(welded wire fabric)

**SMALL CULVERT WATERWAY  
INFORMATION TABLE**

Drainage Area = 271 ac.  
Low Grade Elev. 778.40 @ Sta. 92+50.92

Flood Yr.	Freq.	Q C.F.S.	Headwater El. Exst.	Headwater El. Prop.
Ten Year	10	134	773.67	773.81
Design	50	266	774.79	775.00
Base	100	345	775.41	775.65
Max. Calc.	500	535	776.74	777.08

**GENERAL PLAN AND ELEVATION  
I-90 OVER TRIBUTARY TO DRY RUN CREEK  
F.A.I. ROUTE 90 (I-90)  
SECTION (X2-1)R  
WINNEBAGO COUNTY  
STATION 96+09.07  
STRUCTURE NO. 101-1095**

**APPROVED**  
FOR STRUCTURAL ADEQUACY ONLY  
*Jeffrey T. Tormey*  
ENGINEER OF BRIDGES AND STRUCTURES

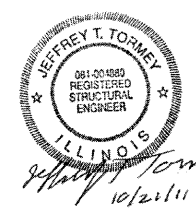

JEFFREY T. TORMEY  
IL REGISTRATION #081-004880  
EXPIRATION DATE 11/30/12



USER NAME =	DESIGNED - JTT	REVISOR -
PLDT SCALE =	CHECKED - VAC	REVISIONS -
PLDT DATE =	DRAWN - JBB	REVISIONS -
	CHECKED - JTT	REVISIONS -

**STATE OF ILLINOIS  
DEPARTMENT OF TRANSPORTATION**

**GENERAL PLAN AND ELEVATION  
STRUCTURE NO. 101-1095**  
BOX CULVERT SHEET NO. 1 OF 7 SHEETS

F.A.I. RTE.	SECTION	COUNTY	TOTAL SHEETS	SHEET NO.
90	(X2-1)R	WINNEBAGO	510	394

CONTRACT NO. 64C29  
ILLINOIS FED. AID PROJECT