

BY	DATE
SURVEYED	
PLOTTED	
TEMPLATE	
NOTE BOOK	
AREAS CHECKED	
NO.	

BY	DATE
SURVEYED	
PLOTTED	
TEMPLATE	
NOTE BOOK	
AREAS CHECKED	
NO.	

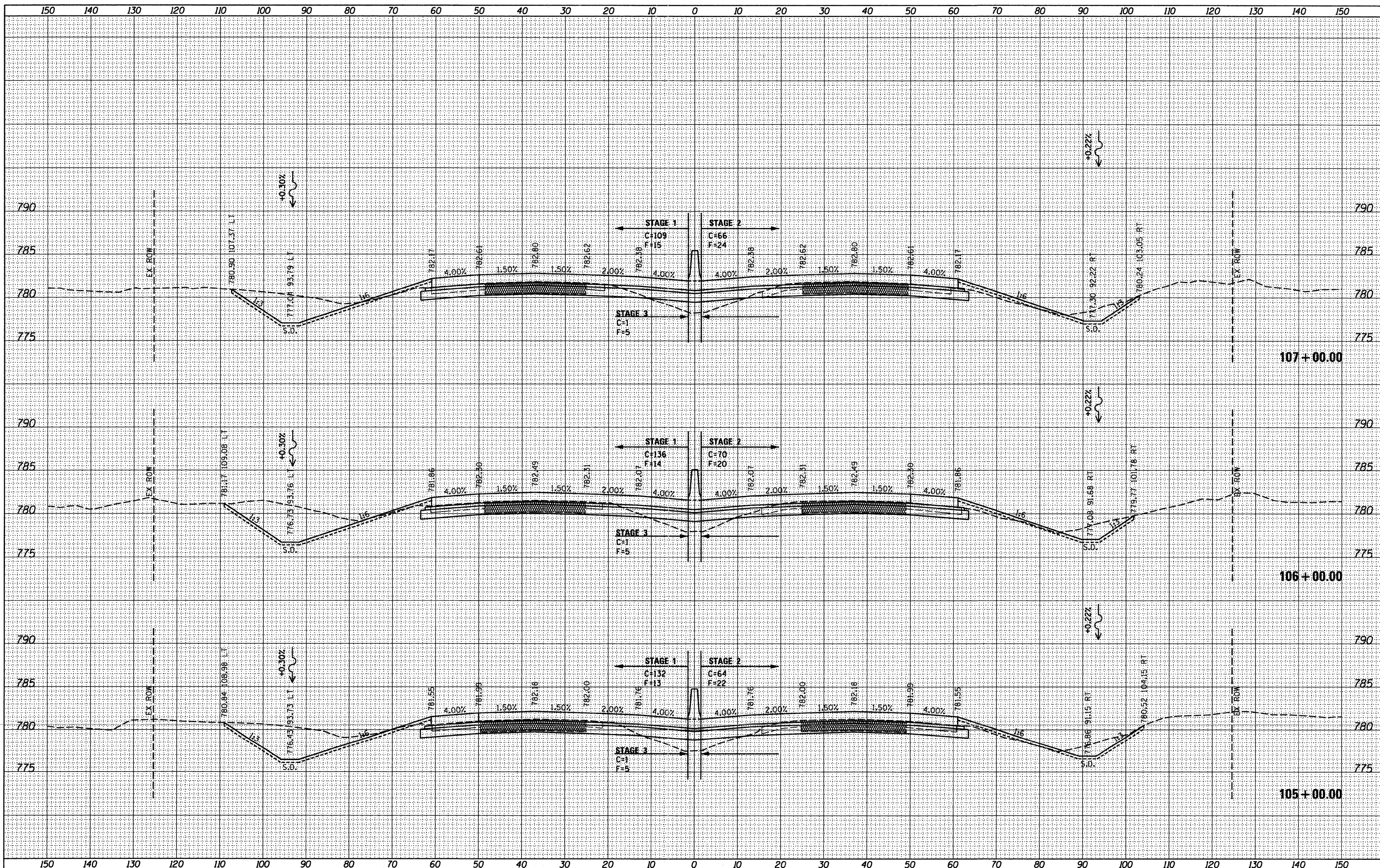

McClure
Engineering Associates, Inc.
LOCHNER
Engineering Associates, Inc.
RWA
Regional Water & Associates, Inc.
QEI
QUIGG ENGINEERING INC.

USER NAME =	USERNAME	DESIGNED -	REVISED -
FILE NAME =	FILES	DRAWN -	REVISED -
PLOT SCALE =	10.0000 / IN.	CHECKED -	REVISED -
PLOT DATE =	10/19/2011	DATE -	10-21-2011

DESIGNED -	REVISED -
DRAWN -	REVISED -
CHECKED -	REVISED -
DATE -	REVISED -

**STATE OF ILLINOIS
DEPARTMENT OF TRANSPORTATION**

I-90 CROSS SECTIONS

SCALE: $\frac{1}{2}$ " = 10' $\frac{1}{4}$ " = 5' SHEET NO. OF SHEETS STA. 105+00.00 TO STA. 107+00.00

F.A. RTE.	SECTION	COUNTY	TOTAL SHEETS	SHEET NO.
90	(X2-1) R	WINNEBAGO	510	450
				CONTRACT NO. 64C29
ILLINOIS FED. AID PROJECT				