

PLAN	SURVEYED	DATE
	PLOTTED	
	NOTES CHECKED	
	BY	
	CADD FILE NAME	

PROFILE	REVIEWED	DATE
	PLOTTED	
	GRADES CHECKED	
	STRUCTURE NOTATIONS CHKD	
	NO.	

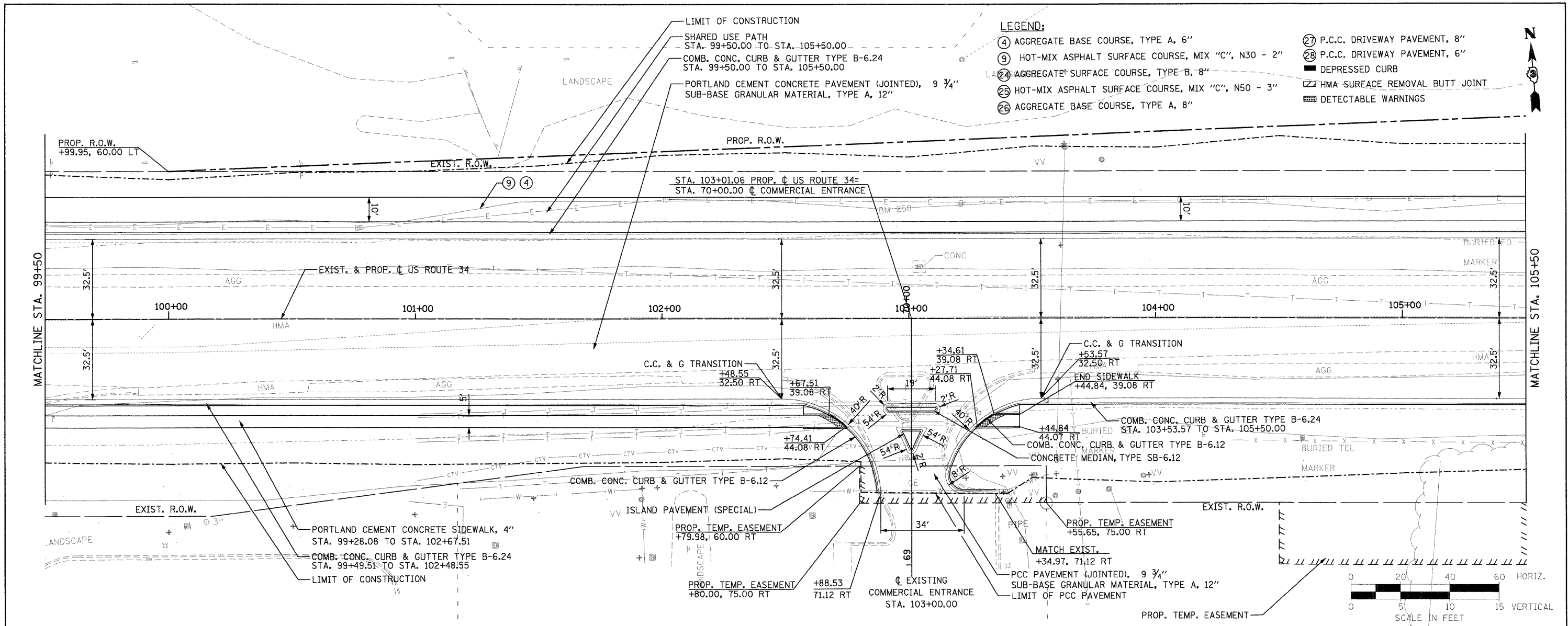

- LEGEND:**
- ④ AGGREGATE BASE COURSE, TYPE A, 6"
  - ⑨ HOT-MIX ASPHALT SURFACE COURSE, MIX "C", N30 - 2"
  - ②④ AGGREGATE SURFACE COURSE, TYPE-B, 8"
  - ②⑤ HOT-MIX ASPHALT SURFACE COURSE, MIX "C", N50 - 3"
  - ②⑥ AGGREGATE BASE COURSE, TYPE A, 8"
  - ②⑦ P.C.C. DRIVEWAY PAVEMENT, 8"
  - ②⑧ P.C.C. DRIVEWAY PAVEMENT, 6"
  - DEPRESSED CURB
  - ▨ HMA SURFACE REMOVAL BUTT JOINT
  - ▩ DETECTABLE WARNINGS

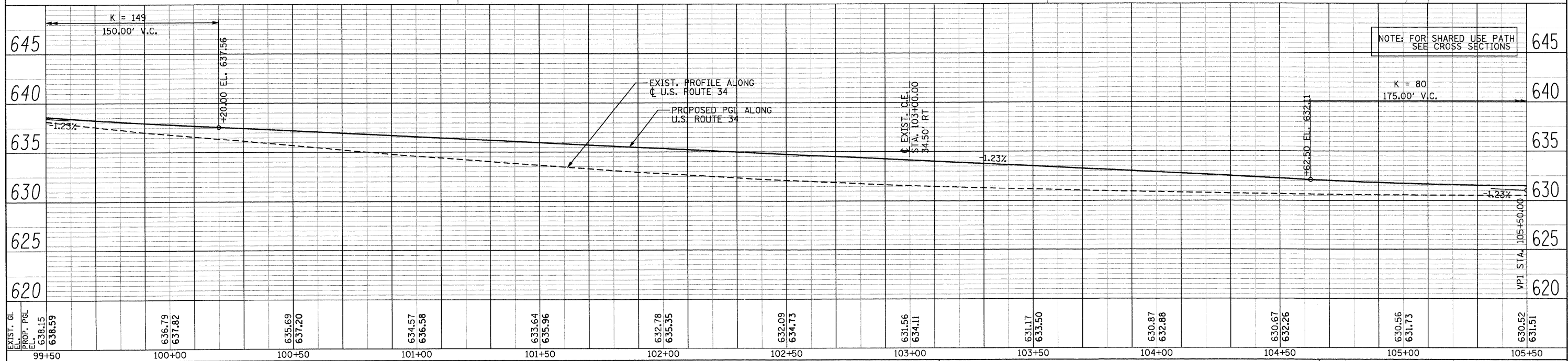
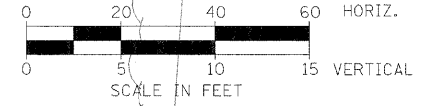

EXIST. G.L.	638.59	636.79	635.69	634.57	633.64	632.78	632.09	631.56	631.17	630.87	630.67	630.56	630.52
PROP. P.G.L.	638.15	637.82	637.20	636.58	635.96	635.35	634.75	634.11	633.50	632.88	632.26	631.73	631.51
EL.													
STATION	99+50	100+00	100+50	101+00	101+50	102+00	102+50	103+00	103+50	104+00	104+50	105+00	105+50

**PB Americas, Inc.**  
 230 WEST MONROE STREET,  
 SUITE 900  
 CHICAGO, IL 60606  
 (312)782-8150

FILE NAME = D366985-sh1-17p1npr.f.dgn	DESIGNED - MMS	REVISED -
PLOT SCALE = 20	DRAWN - MMS	REVISED -
PLOT DATE = 19-AUG-2011 08:15	CHECKED - KJB	REVISED -
	DATE - 08-18-2011	REVISED -

**STATE OF ILLINOIS  
 DEPARTMENT OF TRANSPORTATION**

**U.S. 34 PLAN & PROFILE**

SCALE: 1"=20' Horz | PNP - 17 OF 27 | STA. 99+50 TO STA. 105+50

F.A.P. RTE.	SECTION	COUNTY	TOTAL SHEETS	SHEET NO.
591	13R-214R-1 & BR-10115R-1	KENDALL	429	78
FINAL SUBMITTAL			CONTRACT NO. 66985	
ILLINOIS FED. AID PROJECT				