

LEGEND:

- ⑧ HOT-MIX ASPHALT SURFACE COURSE, MIX "C", N50 - 1 1/2 "
- ⑩ HOT-MIX ASPHALT BINDER COURSE, IL-19.0, N50 - 2 1/4 "
- ③ SUB BASE GRANULAR MATERIAL, TYPE A 8"
- ②5 HOT-MIX ASPHALT SURFACE COURSE, MIX "C", N50 - 3"
- ②6 AGGREGATE BASE COURSE, TYPE A, 8"
- ②4 AGGREGATE SURFACE COURSE, TYPE B, 8"
- ⑭ PORTLAND CEMENT CONCRETE SIDEWALK, 4"
- DEPRESSED CURB
- ▨ HMA SURFACE REMOVAL BUTT JOINT

DATE	
BY	
REVISIONS	
NO.	
PLAN	
NO.	
NO.	
NO.	
NO.	
NO.	
NO.	
NO.	
NO.	

DATE	
BY	
REVISIONS	
NO.	
PROFILE	
NO.	
NO.	
NO.	
NO.	
NO.	
NO.	
NO.	

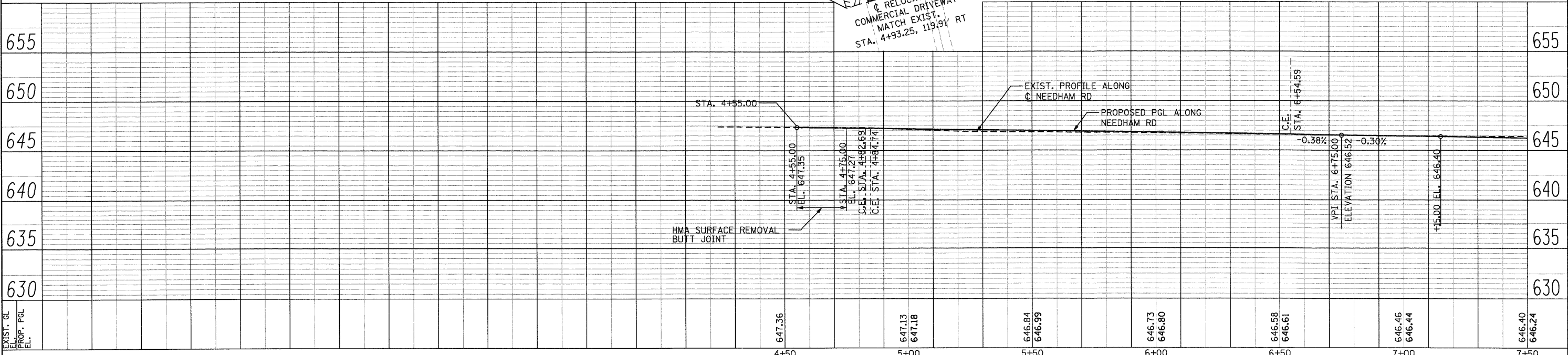
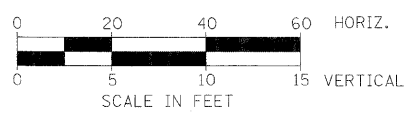
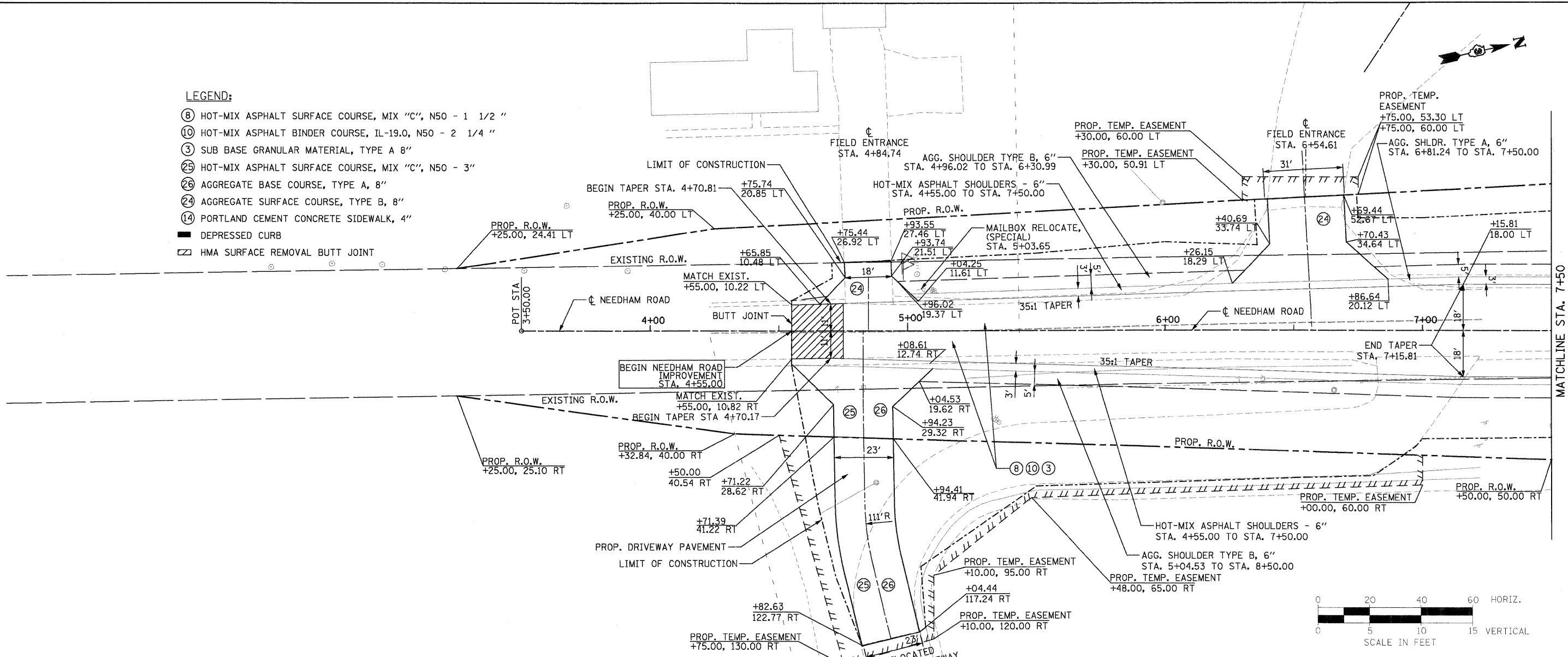

PB Americas, Inc.
 230 WEST MONROE STREET,
 SUITE 900
 CHICAGO, IL 60606
 (312)782-8150

FILE NAME = D366986-shr-21p1nrf.dgn
 DESIGNED - MMS
 DRAWN - MMS
 CHECKED - KJB
 DATE - 08-18-2011

REVISED -
 REVISED -
 REVISED -
 REVISED -

**STATE OF ILLINOIS
 DEPARTMENT OF TRANSPORTATION**

**CROSS ROAD PLAN & PROFILE
 NEEDHAM ROAD**
 SCALE: 1"=20' Horiz
 PNP - 21 OF 27
 STA. BEGIN TO STA. 7+50

F.A.P. RTE.	SECTION	COUNTY	TOTAL SHEETS	SHEET NO.
591	13R-2;14R-1 & BR-1(1);15R-1	KENDALL	429	82
FINAL SUBMITTAL			CONTRACT NO. 66985	
ILLINOIS FED. AID PROJECT				