







LEGEND

-  VERTICAL PANELS AT 50' SPACING IN CURVES AND 100' SPACING IN TANGENTS
-  DRUMS W/ STEADY BURN LIGHTS AT 25' C-C IN TAPERS AND 50' C-C IN TANGENTS
-  WORK ZONE
-  TEMPORARY PAVEMENT (HMA BINDER IL-19mm) 9"
-  TRAFFIC FLOW ARROW
-  TEMPORARY CONCRETE BARRIER

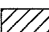

**STAGE I TYPICAL SECTION
U.S. ROUTE 34**
STA. 7+00.00 TO STA. 12+85.32

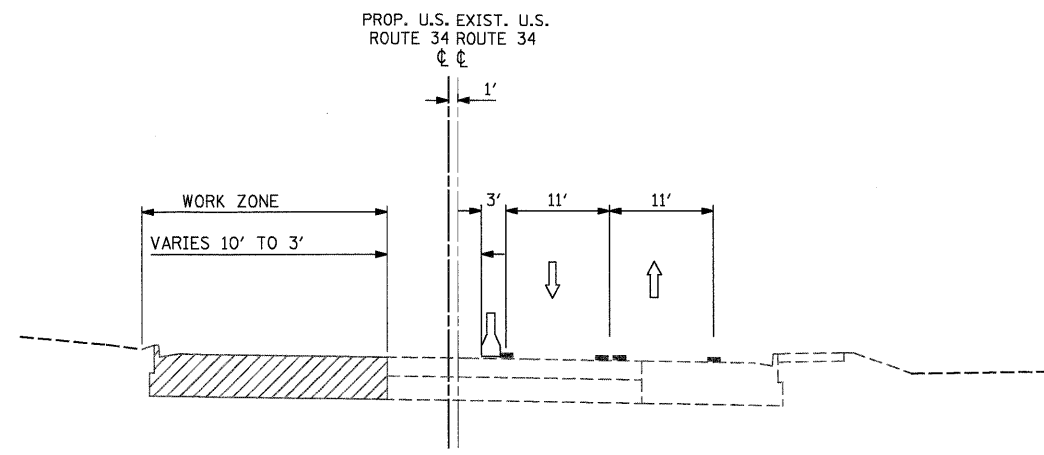
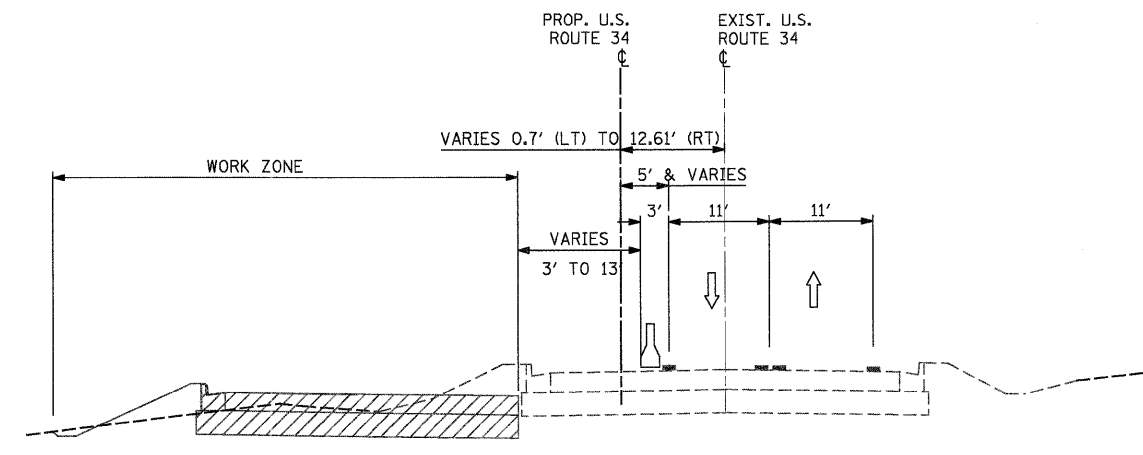

**STAGE I TYPICAL SECTION
U.S. ROUTE 34**
FROM STA. 29+52.22 TO STA. 37+65.92

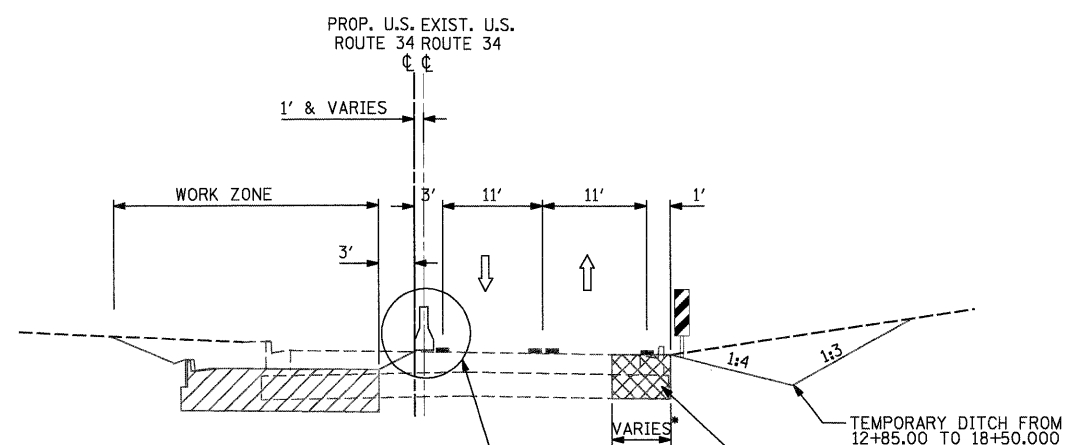

**STAGE I TYPICAL SECTION
U.S. ROUTE 34**
FROM STA. 12+85.85 TO STA. 29+52.22
BRIDGE AND APPROACH OMISSION STA. 19+37.75 TO STA. 21+59.79

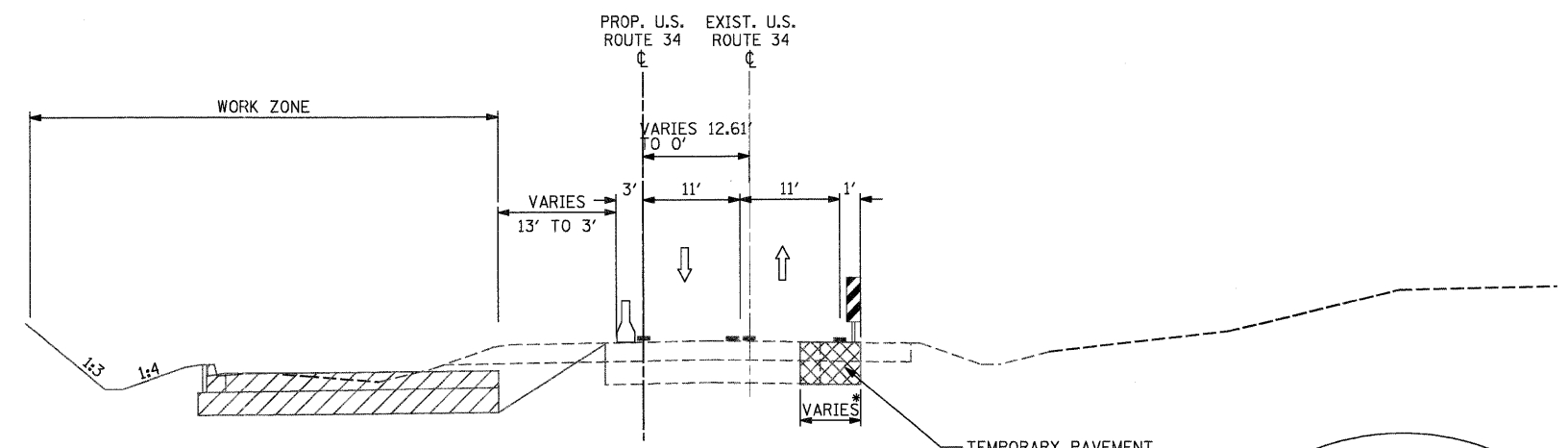

**STAGE I TYPICAL SECTION
U.S. ROUTE 34**
FROM STA. 37+65.92 TO STA. 59+13.47

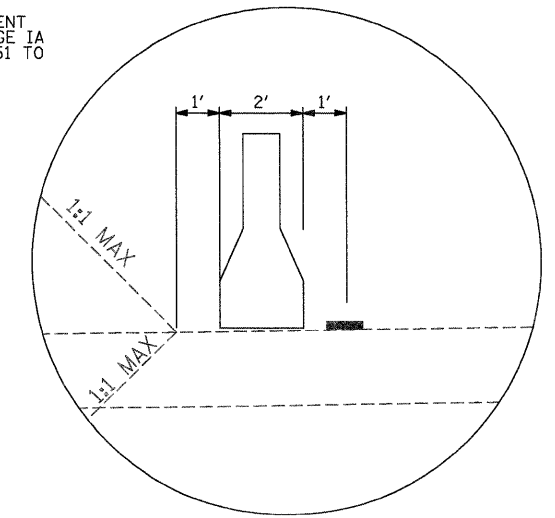

DETAIL A
STA. 13+26.00 TO STA. 30+50.00
STA. 40+00.00 TO STA. 64+30.80
STA. 78+50.00 TO STA. 111+63.70

* 0' TO 7.5' FROM STA. 12+82.98 TO STA. 19+38.26
7.5' FROM STA 19+38.26 TO STA. 26+00.00
7.5' TO 0' FROM STA. 26+00.00 TO STA.29+52.22
0' TO 5.0' FROM STA. 52+00.51 TO STA. 59+13.47