

STA. 98+71.01 U.S. ROUTE 34=
 STA. 60+00.00 TURNER AVENUE

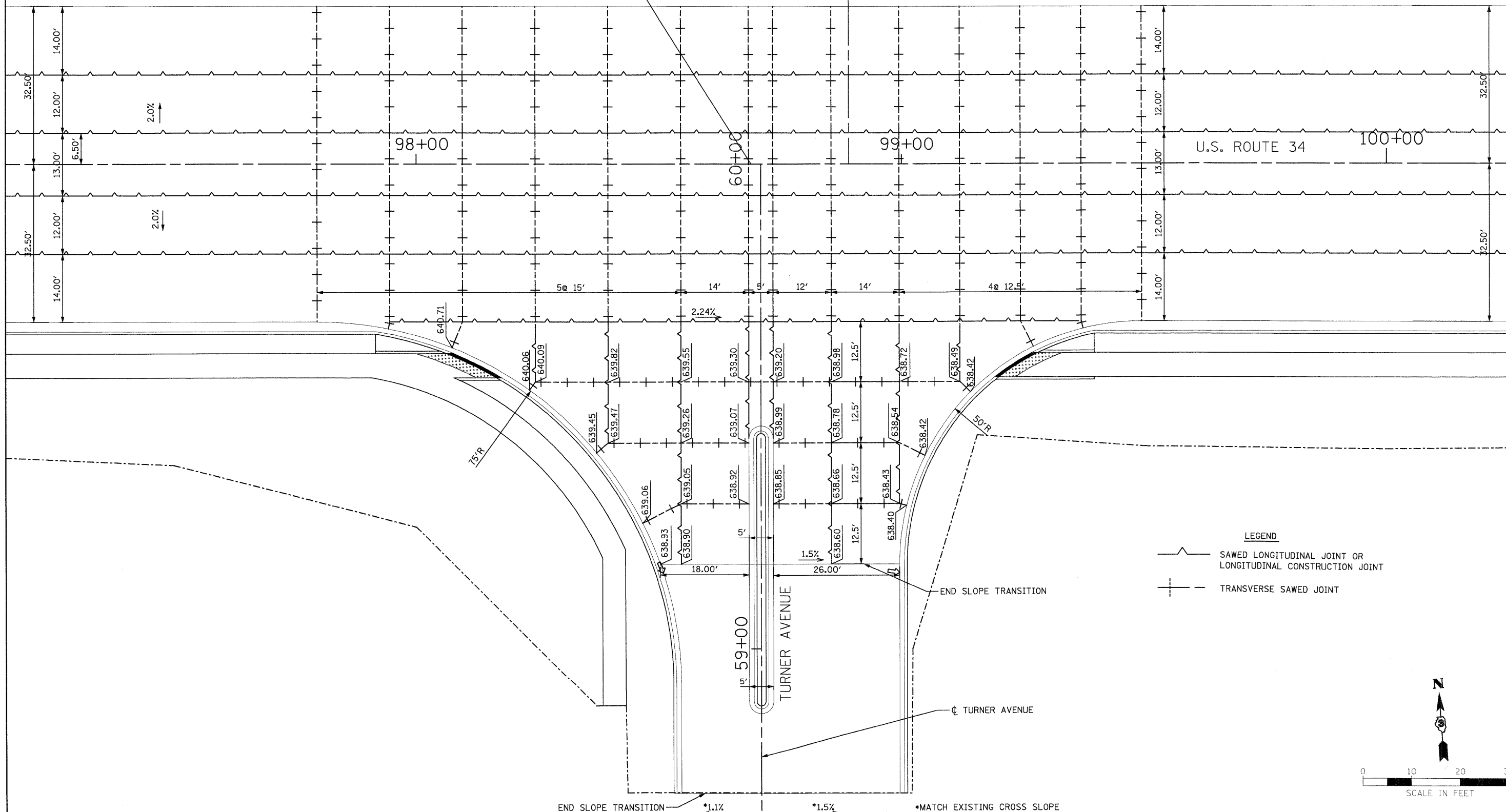

LEGEND
 ——— SAWED LONGITUDINAL JOINT OR LONGITUDINAL CONSTRUCTION JOINT
 +—— TRANSVERSE SAWED JOINT

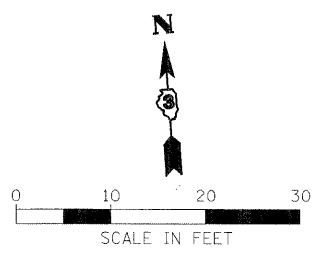

END SLOPE TRANSITION *1.1% *1.5% *MATCH EXISTING CROSS SLOPE

**STATE OF ILLINOIS
 DEPARTMENT OF TRANSPORTATION**

**INTERSECTION DETAIL
 TURNER AVE**

SCALE: AS SHOWN INT - 6 OF 7 STA. TO STA.

PB Americas, Inc.
 230 WEST MONROE STREET,
 SUITE 900
 CHICAGO, IL. 60606
 (312)782-8150

FILE NAME = D366985-sht-6TurnerAvenue.dwg	DESIGNED - MGM	REVISED -
DRAWN - MGM	CHECKED - MMS	REVISED -
PLOT SCALE =	DATE - 08-18-2011	REVISED -
PLOT DATE = 19-AUG-2011 08:25		

F.A.P. RTE.	SECTION	COUNTY	TOTAL SHEETS	SHEET NO.
591	13R-2;14R-1 & BR-1(1);15R-1	KENDALL	429	213
FINAL SUBMITTAL			CONTRACT NO. 66985	
ILLINOIS FED. AID PROJECT				