

ELECTRICAL LOAD FOR INTERSECTION				
STREET NAME	COMPONENT	NUMBER	WATTAGE EACH	BURNTIME %
US 6 / IL 47	RED	7	7	35
	YELLOW	7	12	5
	GREEN	7	9.5	60
	YELLOW ARROW LT.	4	6	5
	GREEN ARROW LT.	4	6	10
	YELLOW ARROW RT.	1	6	5
	GREEN ARROW RT.	1	6	10
GREEN ACRES/ US 6	RED	7	7	60
	YELLOW	7	12	5
	GREEN	7	9.5	35
	YELLOW ARROW LT.	4	6	5
	GREEN ARROW LT.	4	6	10
	YELLOW ARROW RT.	2	6	5
	GREEN ARROW RT.	2	6	10
TRAFFIC SIGNAL CABINET	CONTROLLER	1	6	100
	UPS	1	50	100

THERE MAY BE ADDITIONAL ELECTRICAL LOADS DUE TO LIGHTING AND EMERGENCY VEHICLE DETECTION EQUIPMENT.
AGENCY RESPONSIBLE FOR TRAFFIC SIGNAL ENERGY CHARGES:
CITY OF MORRIS

CONSTRUCTION NOTES:

- MODIFY EXISTING CONTROLLER CABINET.
- INSTALL UNINTERRUPTABLE POWER SUPPLY.
- RETROFIT THE THREE (3) 3-SECTION HEADS WITH LED SIGNAL HEADS.
- RETROFIT THE NINE (9) 5-SECTION HEADS WITH LED SIGNAL HEADS.
- REMOVE AND REPLACE TWO (2) 4-SECTION HEADS WITH LED 5-SECTION HEADS.
- REMOVE AND REPLACE TWO (2) PEDESTRIAN HEADS WITH LED PEDESTRIAN HEADS WITH COUNT DOWN TIMERS.
- REMOVAL OF THE FOLLOWING ITEMS SHALL BE PAID FOR AS REMOVE EXISTING TRAFFIC SIGNAL EQUIPMENT:
2 EACH - SIGNAL HEAD, 1-FACE, 4-SECTION, BRACKET MOUNTED
2 EACH - PEDESTRIAN SIGNAL HEAD, 1-FACE, BRACKET MOUNTED

THE RED BALLS OF THE NEW MAST ARM MOUNTED 5-SECTION SIGNAL HEADS SHALL BE POSITIONED TO MATCH THE EXISTING LOCATION OR TO PROVIDE 16' MINIMUM VERTICAL CLEARANCE, WHICHEVER IS GREATER.

BRACKET MOUNTED SIGNAL HEADS SHALL MATCH EXISTING LOCATION.

HOLES IN TRAFFIC SIGNAL POSTS OR MAST ARM POLES RESULTING FROM REMOVAL OF 4-SECTION SIGNAL HEADS SHALL BE COVERED WITH STAINLESS STEEL PLATES AND MOUNTING HARDWARE. THIS WORK SHALL BE CONSIDERED INCLUDED IN THE COST OF REMOVE EXISTING TRAFFIC SIGNAL EQUIPMENT.

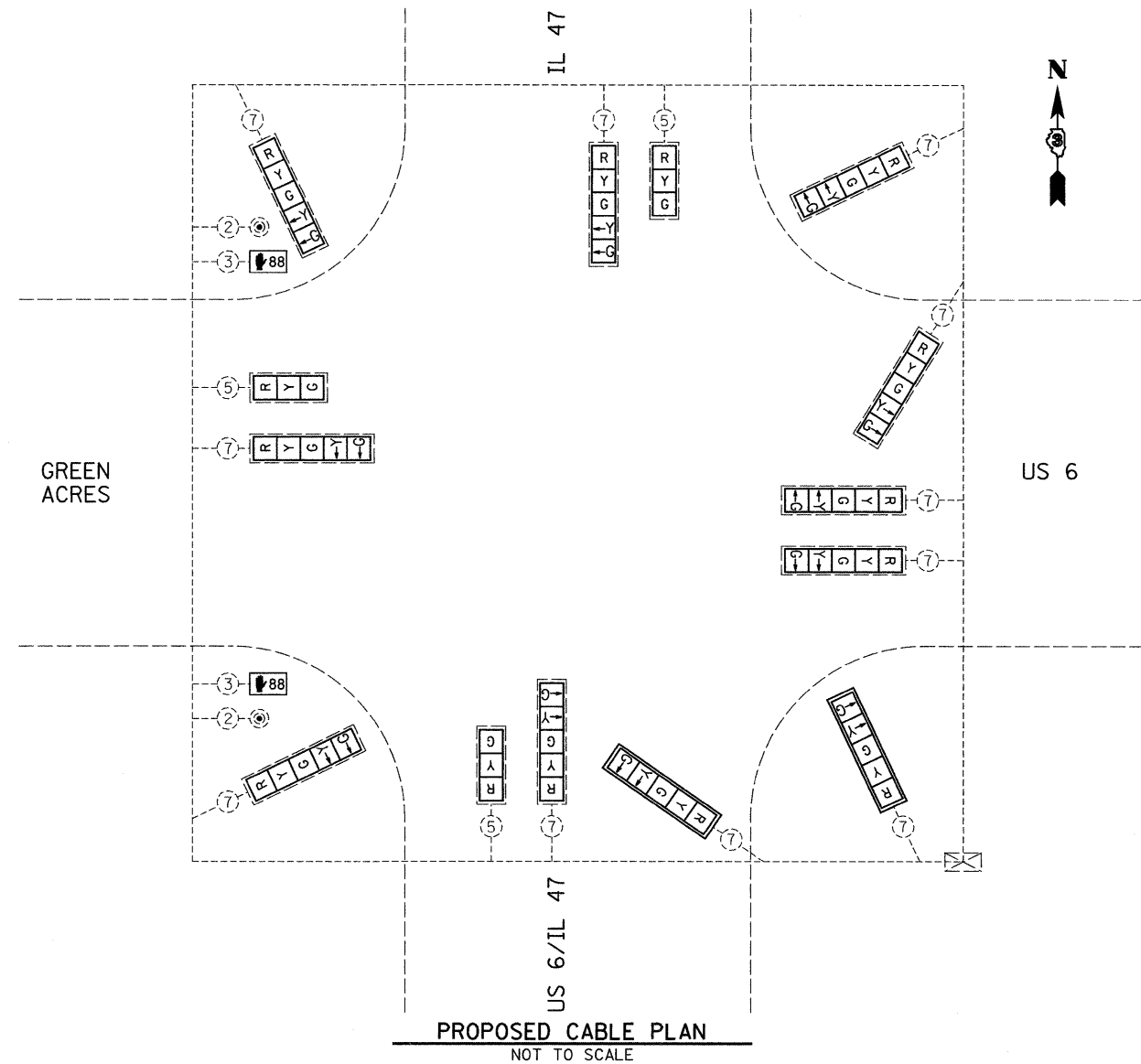

TRAFFIC SIGNALS LEGEND	
	DENOTES NUMBER OF EXISTING CONDUCTORS
	EXISTING CONTROLLER AND CABINET
	SIGNAL SECTION 12"
	LEFT TURN YELLOW
	LEFT TURN GREEN
	RIGHT TURN YELLOW
	RIGHT TURN GREEN
	EXISTING PEDESTRIAN PUSH BUTTON
	PROPOSED WALK/DON'T WALK WITH COUNT DOWN TIMER
	TRAFFIC SIGNAL BACKPLATE
	RETROFIT EXISTING TRAFFIC SIGNAL WITH LED HEADS

SCHEDULE OF QUANTITIES (97.5% STATE / 2.5% CITY)

ITEM NO.	DESCRIPTION	UNIT	TOTAL QUANTITY
86200300	UNINTERRUPTABLE POWER SUPPLY, EXTENDED	EACH	1
88040150	SIGNAL HEAD, POLYCARBONATE, LED, 1-FACE, 5-SECTION, BRACKET MOUNTED	EACH	2
88102825	PEDESTRIAN SIGNAL HEAD, POLYCARBONATE, LED, 1-FACE, BRACKET MOUNTED WITH COUNT DOWN TIMER	EACH	2
88200410	TRAFFIC SIGNAL BACKPLATE, LOUVERED, FORMED PLASTIC	EACH	2
89502210	MODIFY EXISTING CONTROLLER CABINET	EACH	1
89502375	REMOVE EXISTING TRAFFIC SIGNAL EQUIPMENT	EACH	1
Z0033002	LED SIGNAL FACE RETROFIT, RED BALL	EACH	12
Z0033004	LED SIGNAL FACE RETROFIT, GREEN BALL	EACH	12
Z0033008	LED SIGNAL FACE RETROFIT, YELLOW BALL	EACH	12
Z0033010	LED SIGNAL FACE RETROFIT, YELLOW ARROW	EACH	9
Z0033012	LED SIGNAL FACE RETROFIT, GREEN ARROW	EACH	9

FILE NAME = 0366856-SHT-TS-CABLE-MORRIS-US6-IL47-NORTH.DGN

USER NAME = --

DESIGNED - --

REVISED - ---

PLOT SCALE = 1" = 20'

DRAWN - ARR/NV

REVISED - ---

PLOT DATE = 10/11

CHECKED - JKC

REVISED - ---

DATE - 10/11

REVISED - ---

STATE OF ILLINOIS
DEPARTMENT OF TRANSPORTATION

TRAFFIC SIGNAL CABLE PLAN
MORRIS - US 6 & IL 47 (NORTH INTERSECTION)

SCALE: 1" = 20' SHEET NO. ___ OF ___ SHEETS STA. _____ TO STA. _____

F.A. RTE.	SECTION	COUNTY	TOTAL SHEETS	SHEET NO.
--	D-3 LED RETROFIT 2012-3	*	29	16

CONTRACT NO. 66B56

ILLINOIS FED. AID PROJECT

* FORD, GRUNDY, KENDALL & LIVINGSTON