

STRUCTURE #20
 STA. 231+00.00, 30.0' LT
 INLET-MANHOLE,
 TY G-1, 5'-DIA.
 RIM ELEV = 760.29
 INV ELEV = 754.57 (27" E)
 INV ELEV = 754.37 (27" W)

STRUCTURE #21
 STA. 233+00.00, 30.0' LT
 INLET-MANHOLE,
 TY G-1, 5'-DIA.
 RIM ELEV = 763.49
 INV ELEV = 757.75 (27" E)
 INV ELEV = 757.55 (27" W)

STRUCTURE #22
 STA. 235+00.00, 30.0' LT
 INLET-MANHOLE,
 TY G-1, 5'-DIA.
 RIM ELEV = 766.36
 INV ELEV = 760.93 (24" E)
 INV ELEV = 760.73 (27" W)

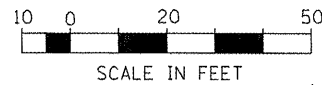

DATE	
BY	
PLAN	
NO.	
DATE	
BY	
PROFILE	
NO.	

DATE	
BY	
PROFILE	
NO.	

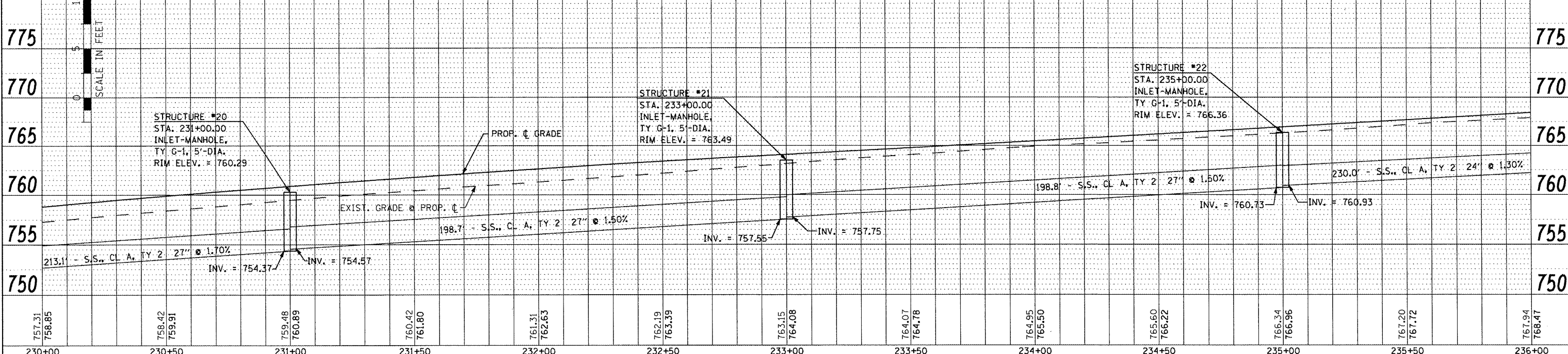
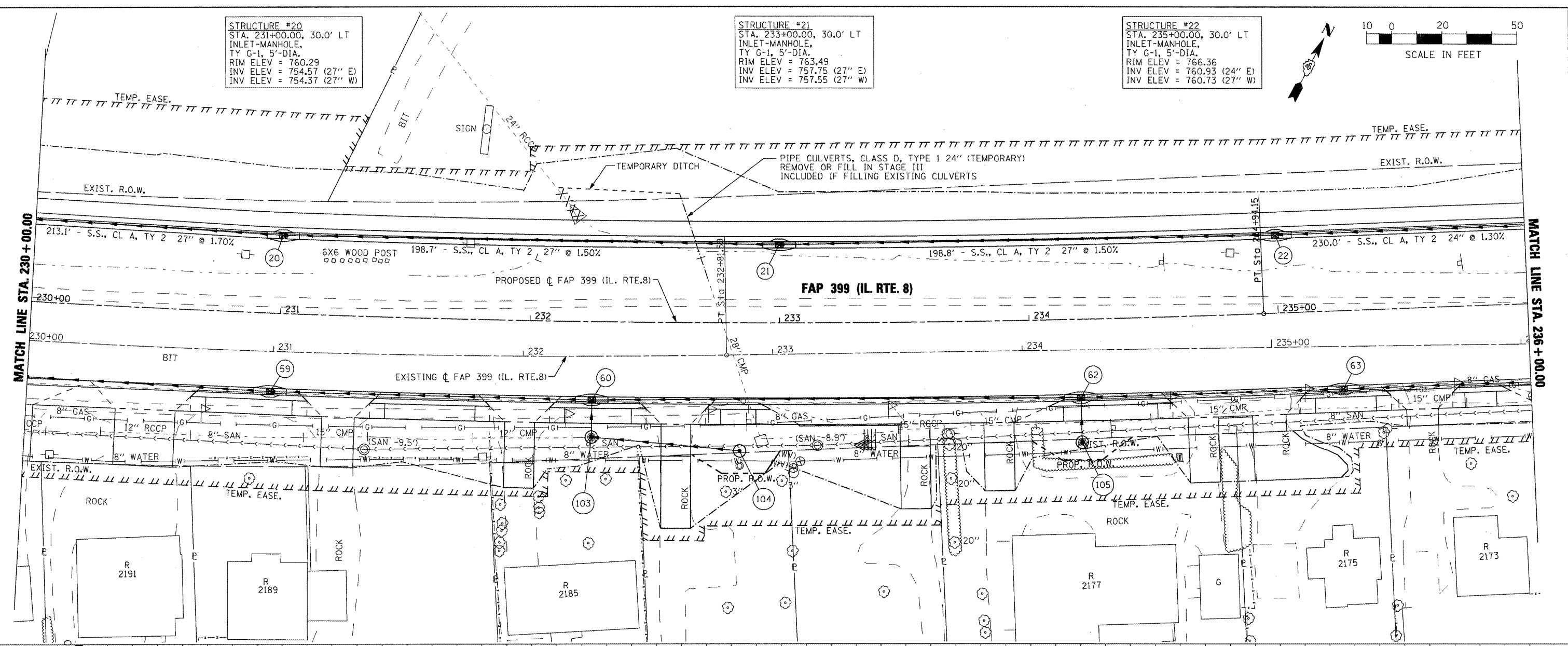

FILE NAME =	USER NAME = IDOT	DESIGNED -	REVISED -	STATE OF ILLINOIS DEPARTMENT OF TRANSPORTATION	FAP 399 (IL. RTE. 8) DRAINAGE PLAN AND PROFILE - NORTH		F.A. RTE.	SECTION	COUNTY	TOTAL SHEET NO.
x:\projects\200803566\dgn\14-Rte8-sh-t-DRN-6-NORTH.dgn		DRAWN -	REVISED -		SCALE: AS SHOWN	SHEET NO. OF SHEETS	399	36 R-7	TAZEWELL	390 182
PLOT SCALE = 40.0000' / IN.		CHECKED -	REVISED -		STA. 230+00.00 TO STA. 236+00.00	ILLINOIS FED. AID PROJECT				
PLOT DATE = 10/21/2011		DATE -	REVISED -		CONTRACT NO. 68370					