

DATE	
BY	
REVISIONS	
NO.	
DESCRIPTION	
DATE	
BY	
REVISIONS	
NO.	
DESCRIPTION	
DATE	
BY	
REVISIONS	
NO.	
DESCRIPTION	
DATE	
BY	
REVISIONS	
NO.	
DESCRIPTION	
DATE	
BY	
REVISIONS	
NO.	
DESCRIPTION	
DATE	
BY	
REVISIONS	
NO.	
DESCRIPTION	
DATE	
BY	
REVISIONS	
NO.	
DESCRIPTION	

DATE	
BY	
REVISIONS	
NO.	
DESCRIPTION	
DATE	
BY	
REVISIONS	
NO.	
DESCRIPTION	
DATE	
BY	
REVISIONS	
NO.	
DESCRIPTION	
DATE	
BY	
REVISIONS	
NO.	
DESCRIPTION	
DATE	
BY	
REVISIONS	
NO.	
DESCRIPTION	
DATE	
BY	
REVISIONS	
NO.	
DESCRIPTION	

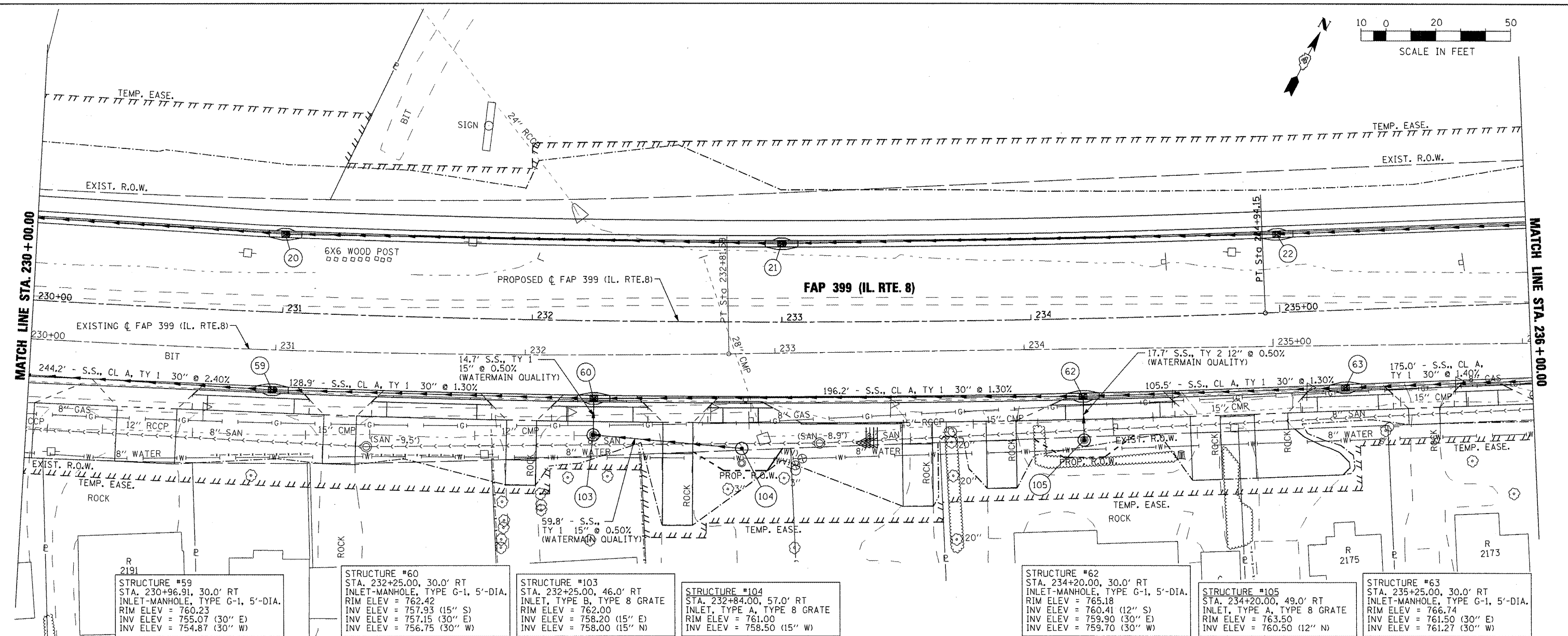

STRUCTURE #59
STA. 230+96.91, 30.0' RT
INLET-MANHOLE, TYPE G-1, 5'-DIA.
RIM ELEV = 760.23
INV ELEV = 755.07 (30" E)
INV ELEV = 754.87 (30" W)

STRUCTURE #60
STA. 232+25.00, 30.0' RT
INLET-MANHOLE, TYPE G-1, 5'-DIA.
RIM ELEV = 762.42
INV ELEV = 757.93 (15" S)
INV ELEV = 757.15 (30" E)
INV ELEV = 756.75 (30" W)

STRUCTURE #103
STA. 232+25.00, 46.0' RT
INLET, TYPE B, TYPE 8 GRATE
RIM ELEV = 762.00
INV ELEV = 758.20 (15" E)
INV ELEV = 758.00 (15" N)

STRUCTURE #104
STA. 232+84.00, 57.0' RT
INLET, TYPE A, TYPE 8 GRATE
RIM ELEV = 761.00
INV ELEV = 758.50 (15" W)

STRUCTURE #62
STA. 234+20.00, 30.0' RT
INLET-MANHOLE, TYPE G-1, 5'-DIA.
RIM ELEV = 765.18
INV ELEV = 760.41 (12" S)
INV ELEV = 759.90 (30" E)
INV ELEV = 759.70 (30" W)

STRUCTURE #105
STA. 234+20.00, 49.0' RT
INLET, TYPE A, TYPE 8 GRATE
RIM ELEV = 763.50
INV ELEV = 760.50 (12" N)

STRUCTURE #63
STA. 235+25.00, 30.0' RT
INLET-MANHOLE, TYPE G-1, 5'-DIA.
RIM ELEV = 766.74
INV ELEV = 761.50 (30" E)
INV ELEV = 761.27 (30" W)

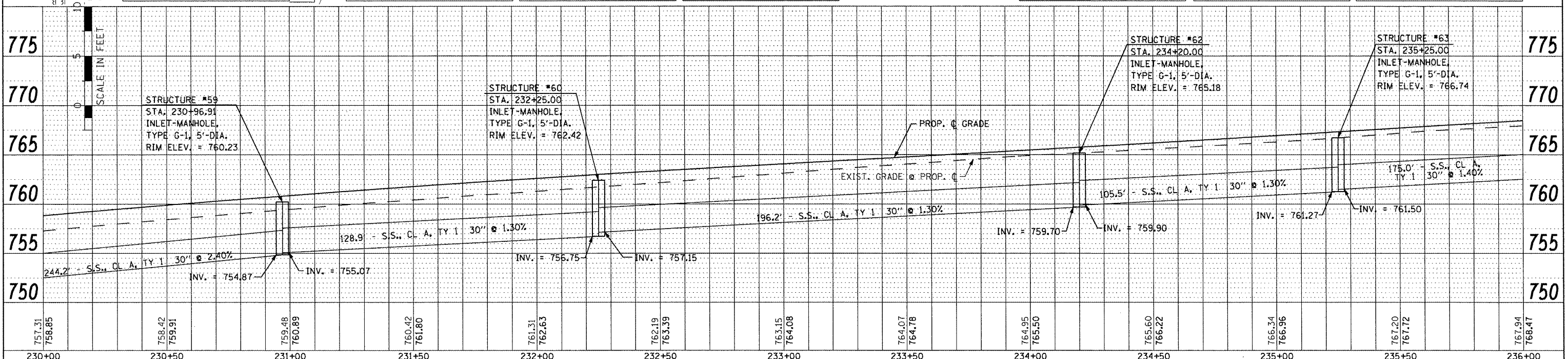

FILE NAME =	USER NAME = IDOT	DESIGNED -	REVISED -	STATE OF ILLINOIS DEPARTMENT OF TRANSPORTATION FAP 399 (IL RTE. 8) DRAINAGE PLAN AND PROFILE - SOUTH				F.A. RTE.	SECTION	COUNTY	TOTAL SHEETS	SHEET NO.
NOTE BOOK NO.	DATE	DRAWN -	REVISED -					399	36 R-7	TAZEWELL	390	194
DATE	BY	CHECKED -	REVISED -					CONTRACT NO. 68370				
DATE	BY	DATE	REVISED -					ILLINOIS FED. AID PROJECT				