

STA. 194 + 00.00

MATCH LINE STA. 200 + 00.00

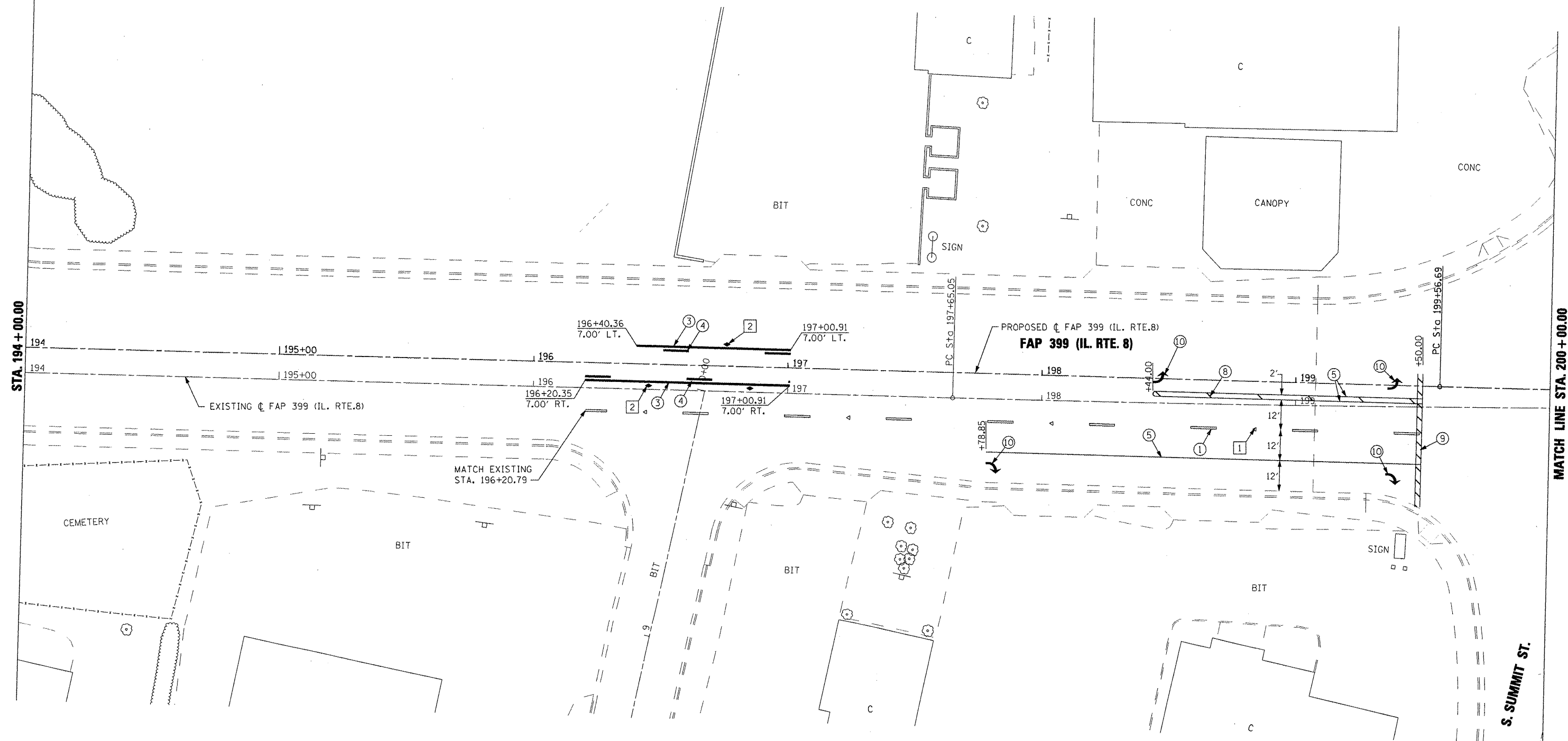
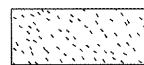
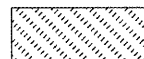

**LANDSCAPING LEGEND**

-  SEEDING, CLASS 2A
-  SODDING, SALT TOLERANT

**PAVEMENT MARKING LEGEND**

- ① PREFORMED PLASTIC PAVEMENT MARKING - LINE 6" WHITE SKIP DASH
- ② EPOXY PAVEMENT MARKING - LINE 4" YELLOW SOLID (DOUBLE LINE)
- ③ EPOXY PAVEMENT MARKING - LINE 4" YELLOW SOLID
- ④ EPOXY PAVEMENT MARKING - LINE 4" YELLOW SKIP DASH
- ⑤ EPOXY PAVEMENT MARKING - LINE 8" WHITE SOLID
- ⑥ EPOXY PAVEMENT MARKING - LINE 8" WHITE SKIP DASH
- ⑦ EPOXY PAVEMENT MARKING - LINE 12" YELLOW SOLID
- ⑧ EPOXY PAVEMENT MARKING - LINE 12" WHITE SOLID
- ⑨ EPOXY PAVEMENT MARKING - LINE 24" WHITE SOLID (STOP BAR)
- ⑩ EPOXY PAVEMENT MARKING - LETTERS AND SYMBOLS

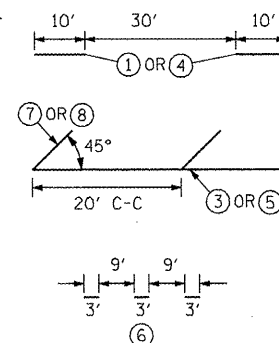

1. PAVEMENT MARKINGS SHALL BE IN ACCORDANCE WITH DISTRICT CADD DETAILS - STANDARD 780001.

**RAISED REFLECTIVE PAVEMENT MARKERS (RRPM) LEGEND**

- ① Δ ONE-WAY CRYSTAL MARKER AT 80' CENTERS
- ② ◆ TWO-WAY AMBER MARKER AT 40' CENTERS

**SIGN POST LEGEND**

- WOOD POST LENGTH
- OFFSET FROM EDGE OF PAVEMENT

• SEE STANDARD 720006 FOR OFFSET

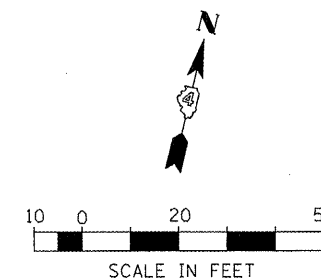

|  |                  |                 |           |
|--|------------------|-----------------|-----------|
| FILE NAME =                                      | USER NAME = IDOT | DESIGNED -      | REVISED - |
| x:\projects\200803566\dgn\04-Rte8-sht-10-K-2.dgn |                  | DRAWN -         | REVISED - |
| PLOT SCALE = 48.004 FT / IN.                     |                  | CHECKED -       | REVISED - |
| PLOT DATE = 10/21/2011                           |                  | DATE = 10-21-11 | REVISED - |

**STATE OF ILLINOIS  
DEPARTMENT OF TRANSPORTATION**

**FAP 399 (IL. RTE. 8)  
PAVEMENT MARKING & LANDSCAPING PLANS**

SCALE: AS SHOWN SHEET NO. OF SHEETS STA. 194+00.00 TO STA. 200+00.00

|                           |                |                 |                  |                    |
|---------------------------|----------------|-----------------|------------------|--------------------|
| F.A.P. RTE. 399           | SECTION 36 R-7 | COUNTY TAZEWELL | TOTAL SHEETS 390 | SHEET NO. 238      |
|                           |                |                 |                  | CONTRACT NO. 68370 |
| ILLINOIS FED. AID PROJECT |                |                 |                  |                    |