

MATCH LINE STA. 230+00.00

MATCH LINE STA. 236+00.00

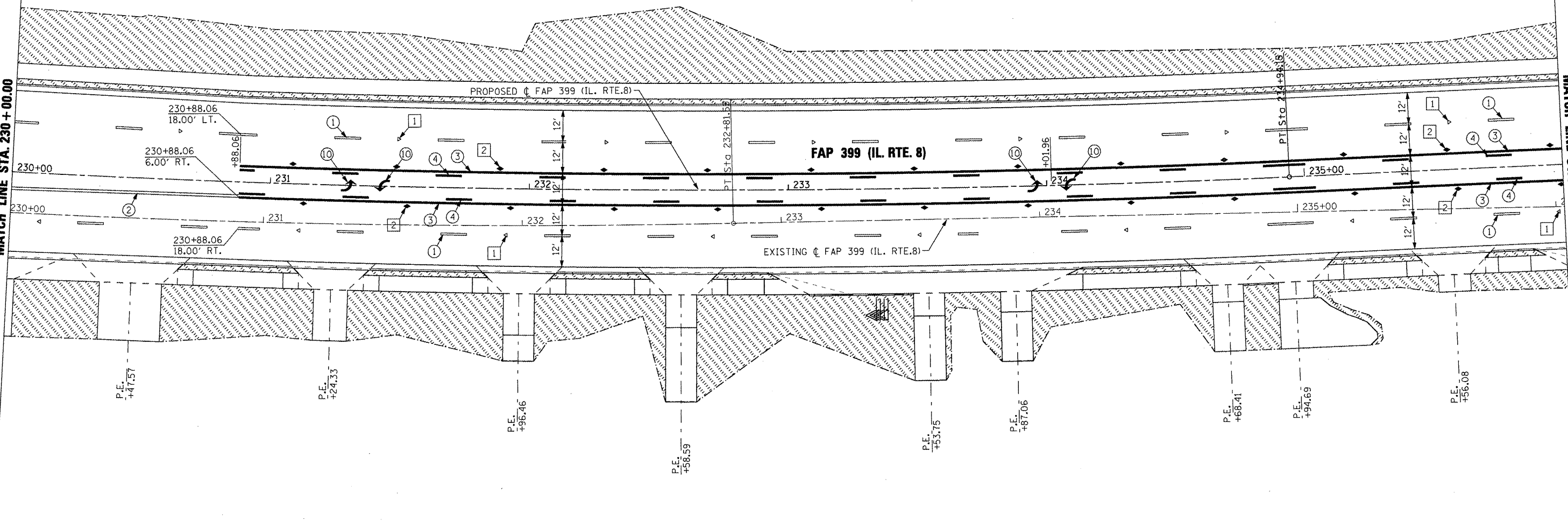

LANDSCAPING LEGEND

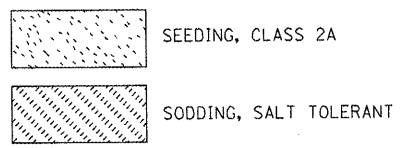

PAVEMENT MARKING LEGEND

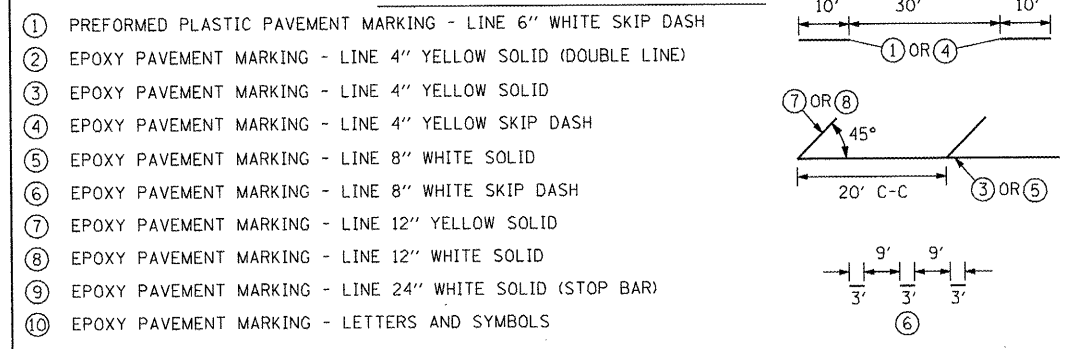

1. PAVEMENT MARKINGS SHALL BE IN ACCORDANCE WITH DISTRICT CADD DETAILS - STANDARD 780001.

RAISED REFLECTIVE PAVEMENT MARKERS (RRPM) LEGEND

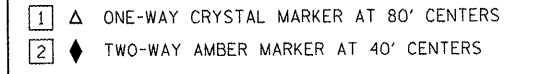

SIGN POST LEGEND

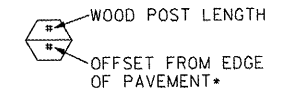

• SEE STANDARD 720006 FOR OFFSET

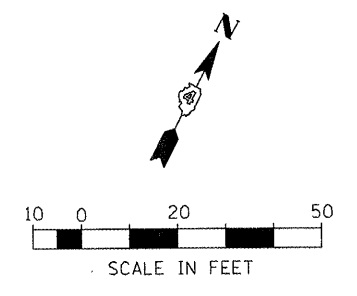

FILE NAME =	USER NAME = IDOT	DESIGNED -	REVISED -	STATE OF ILLINOIS DEPARTMENT OF TRANSPORTATION	FAP 399 (IL. RTE. 8) PAVEMENT MARKING & LANDSCAPING PLANS			F.A.P. RTE. 399	SECTION 36 R-7	COUNTY TAZEWELL	TOTAL SHEETS 390	SHEET NO. 244
x:\projects\200803566\dgn\04-Rte8-shft-FK-6.dgn		DRAWN -	REVISED -		SCALE: AS SHOWN	SHEET NO. OF	SHEETS	STA. 230+00.00 TO STA. 236+00.00	CONTRACT NO. 68370			
		CHECKED -	REVISED -						ILLINOIS FED. AID PROJECT			
		DATE - 10-21-11	REVISED -									