

FINAL SURVEY	DATE
NO.	
BY	
DATE	
NO.	
BY	
DATE	
NO.	
BY	
DATE	
NO.	

ORIGINAL SURVEY	DATE
NO.	
BY	
DATE	
NO.	
BY	
DATE	
NO.	
BY	
DATE	
NO.	

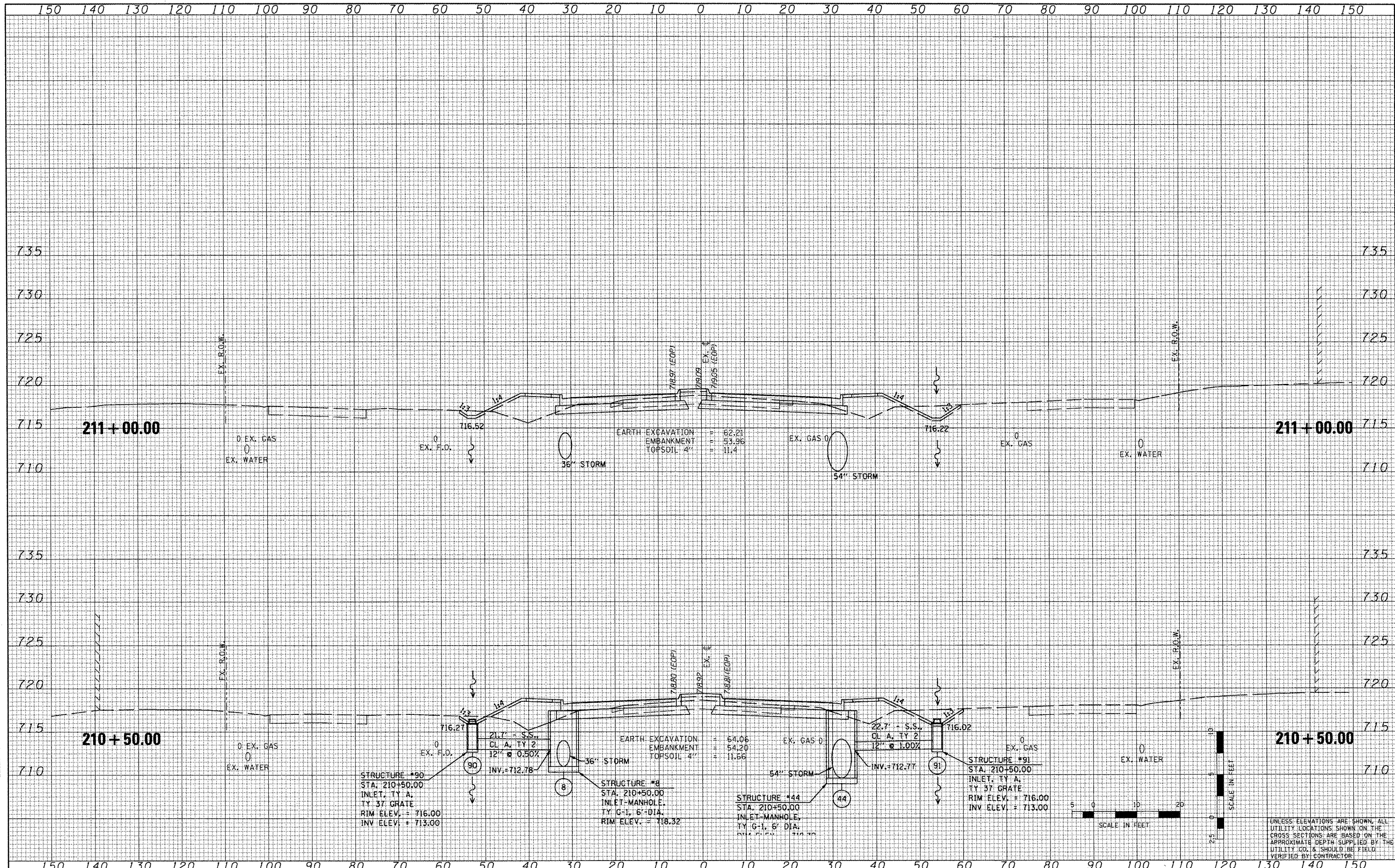

UNLESS ELEVATIONS ARE SHOWN, ALL UTILITY LOCATIONS SHOWN ON THE CROSS SECTIONS ARE BASED ON THE APPROXIMATE DEPTH SUPPLIED BY THE UTILITY CO. & SHOULD BE FIELD VERIFIED BY CONTRACTOR

FILE NAME =  
 x:\projects\200803566\dgn\pk\X5-IL-RT8-sheets.dgn

USER NAME = I00T  
 PLOT SCALE = 20.7420' / IN.  
 PLOT DATE = 10/21/2011

DESIGNED -	REVISED -
DRAWN -	REVISED -
CHECKED -	REVISED -
DATE - 10-21-11	REVISED -

STATE OF ILLINOIS  
 DEPARTMENT OF TRANSPORTATION

FAP 399 (IL RTE. 8)  
 CROSS SECTIONS  
 SCALE: SHEET NO. OF SHEETS STA. 210+50.00 TO STA. 211+00.00

F.A.P. RTE. 399	SECTION 36 R-7	COUNTY TAZEWELL	TOTAL SHEETS 390	SHEET NO. 314
ILLINOIS FED. AID PROJECT			CONTRACT NO. 68370	