

TRAFFIC SIGNAL MODERNIZATION

F.A.P. 804 (U.S. 150 / SPRINGFIELD AVE.)

&
PROSPECT AVENUE

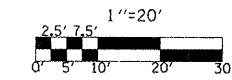

SIGNAL LAYOUT

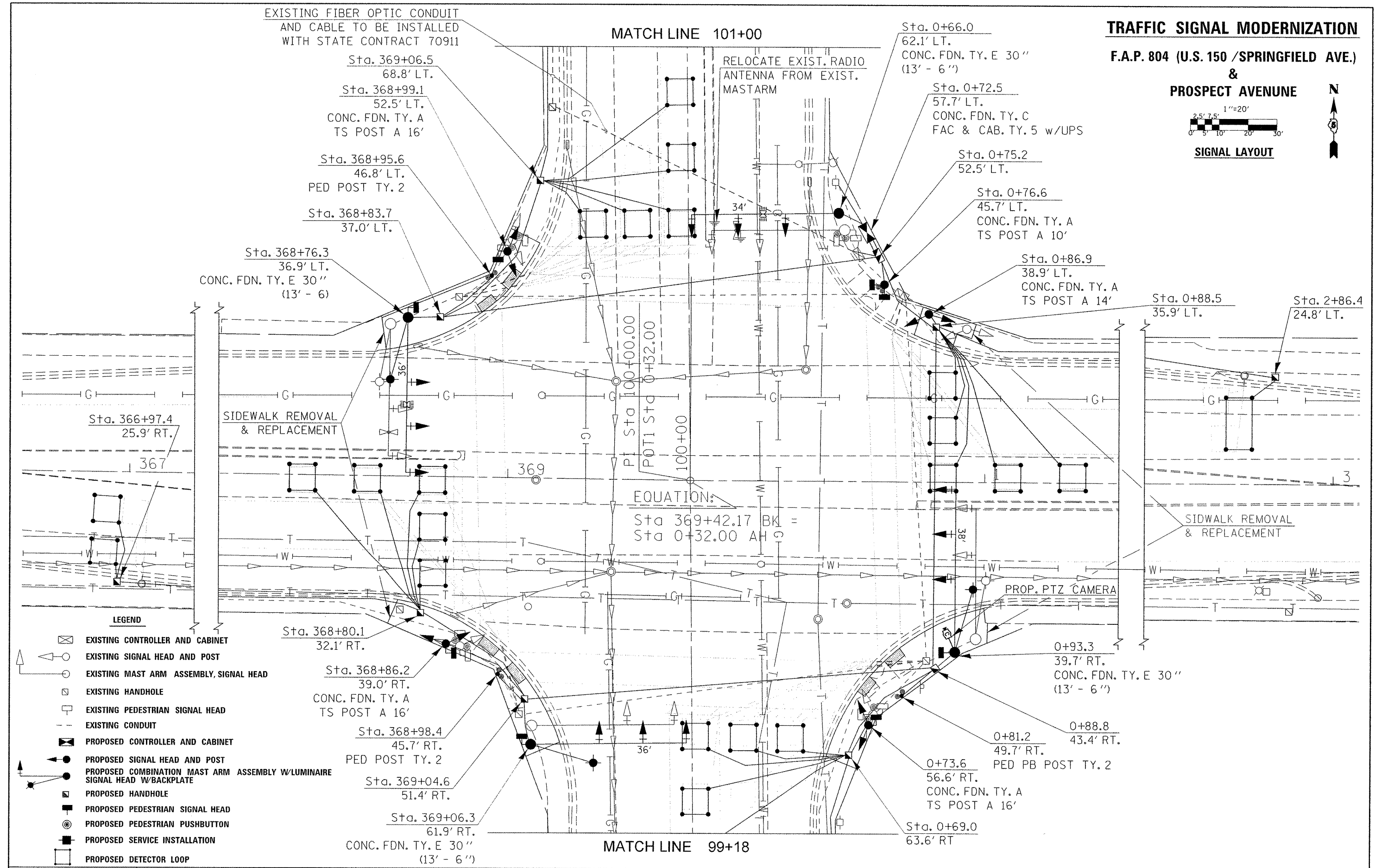

LEGEND

- EXISTING CONTROLLER AND CABINET
- EXISTING SIGNAL HEAD AND POST
- EXISTING MAST ARM ASSEMBLY, SIGNAL HEAD
- EXISTING HANDHOLE
- EXISTING PEDESTRIAN SIGNAL HEAD
- EXISTING CONDUIT
- PROPOSED CONTROLLER AND CABINET
- PROPOSED SIGNAL HEAD AND POST
- PROPOSED COMBINATION MAST ARM ASSEMBLY W/LUMINAIRE SIGNAL HEAD W/BACKPLATE
- PROPOSED HANDHOLE
- PROPOSED PEDESTRIAN SIGNAL HEAD
- PROPOSED PEDESTRIAN PUSHBUTTON
- PROPOSED SERVICE INSTALLATION
- PROPOSED DETECTOR LOOP

FILE NAME :	USER NAME :	DESIGNED :	REVISED :
ct:\pw\work\awdot\biggsrd\0277321\0570938-Design.dgn	biggsrd		
	PLOT SCALE :	CHECKED :	REVISED :
	20.0000 1" = 100'		
	PLOT DATE :	DATE :	REVISED :
	10/31/2011		

**STATE OF ILLINOIS
DEPARTMENT OF TRANSPORTATION**

SCALE: _____ SHEET _____ OF _____ SHEETS STA. _____ TO STA. _____

F.A.P. RTE.:	SECTION:	COUNTY:	TOTAL SHEETS:	SHEET NO.:
804	32TS	CHAMPAIGN	11	6
CONTRACT NO. 70938				
ILLINOIS FED. AID PROJECT				