

Benchmark: Chiseled "□" in concrete headwall of 18" RCCP under levee South side of IL 78.  
Sta. 991+56.4, 46.4' Lt. NAVD '88 Elev. 464.27

Existing Structure: SN 009-2001  
Originally built in 1931 as SBI 78, Section 144, B, a 2 cell reinforced concrete box culvert with 12 foot spans and 7 foot rise. C.L. Sta. 992+03.00, 13° skew Rt. forward.  
The existing structure to be removed and replaced with a new 86'-11 1/2" long culvert.  
One lane of traffic shall be maintained utilizing stage construction.  
No Salvage.

**GENERAL NOTES**

Precast alternate is not allowed.  
Reinforcement bars shall conform to the requirements of ASTM A 706 Gr 60.  
Reinforcement bars designated (E) shall be epoxy coated.  
Layout of slope protection system may be varied to suit ground conditions in the field as directed by the Engineer.

**TOTAL BILL OF MATERIAL**

ITEM	UNIT	TOTAL
Stone Riprap, Class A4	Sq. Yd.	111
Filter Fabric	Sq. Yd.	111
Removal of Existing Structures No. 1	Each	1
Reinforcement Bars, Epoxy Coated	Pound	51,340
Bar Splicers	Each	125
Name Plates	Each	1
Concrete Box Culverts	Cu. Yd.	218.1
Granular Culvert Backfill	Cu. Yd.	278
Temporary Soil Retention System	Sq. Ft.	223
Rockfill-Foundation	Ton	363
Temporary Steel Plate Beam Guardrail, Attached to Structures	Foot	25

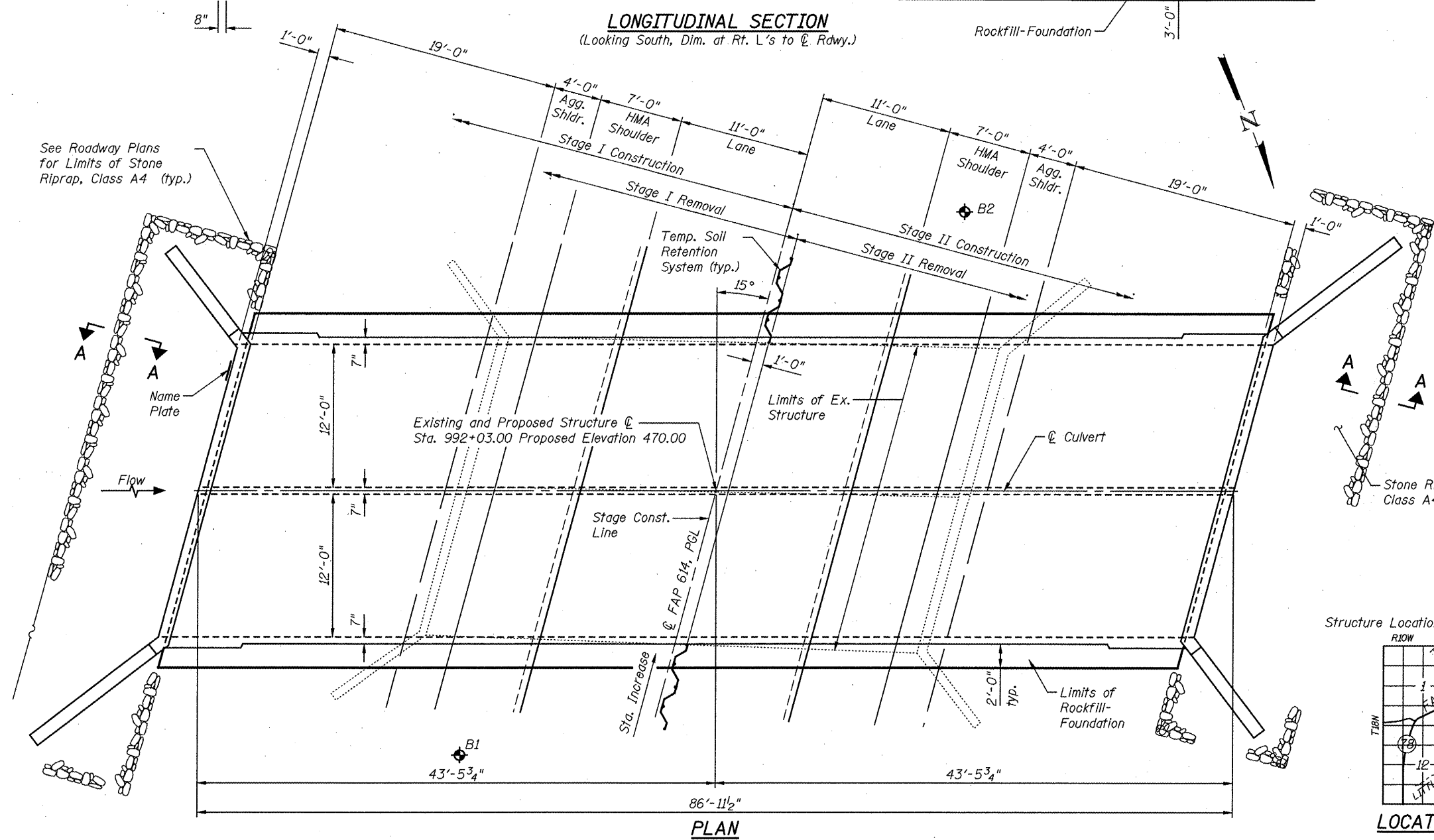
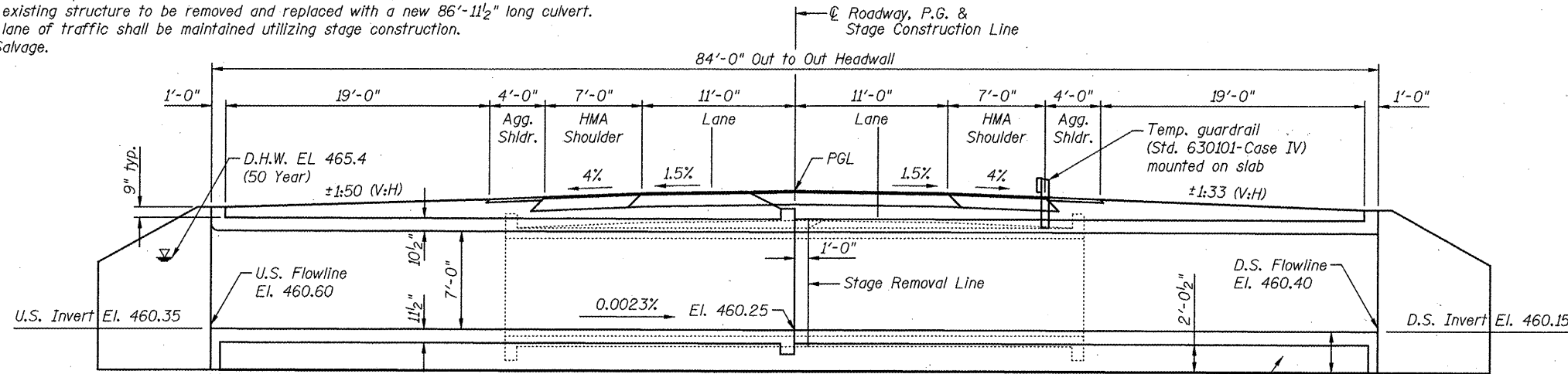

**APPROVED**  
For Structural Adequacy Only  
*Mary Lou Blodgett*  
Engineer of Bridges & Structures

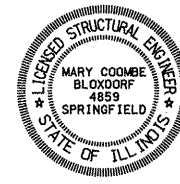

*Mary Lou Blodgett*  
ILLINOIS STRUCTURAL NO. 4859  
EXPIRES 11/30/12  
DATE: 8/28/2011

**GENERAL PLAN**  
**IL-78 OVER PANTHER CREEK OVERFLOW**  
**FAP ROUTE 614 SECTION 144(B-4)**  
**CASS COUNTY**  
**STATION 992+03.00**  
**STRUCTURE NO. 009-2511**

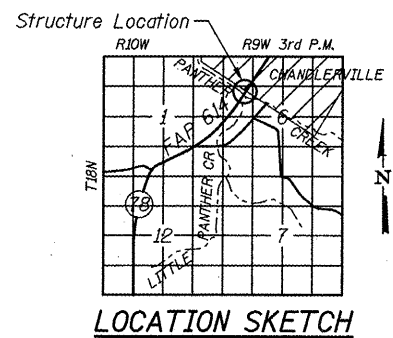

FILE NAME =	USER NAME = _MML_	DESIGNED - GB	REVISED -
...\\0092511-72855-001-GPE.dgn		CHECKED - MCB	REVISED -
		DRAWN - MML	REVISED -
		CHECKED - MCB	REVISED -

STATE OF ILLINOIS  
DEPARTMENT OF TRANSPORTATION

SHEET NO. 1 OF 9 SHEETS

F.A.P. RTE.	SECTION	COUNTY	TOTAL SHEETS	SHEET NO.
614	144(B-4)	CASS	97	45
CONTRACT NO. 72855				

ILLINOIS FED. AID PROJECT